

# Assembly Instructions For

# WB1410

(E) 10/08

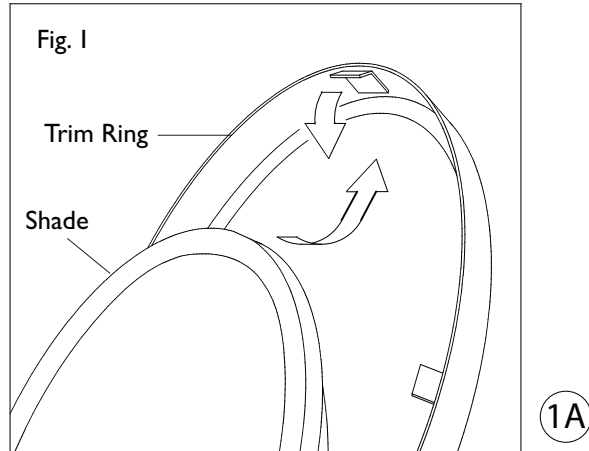

## IMPORTANT TURN OFF THE POWER AT THE MAIN FUSE OR CIRCUIT BREAKER BOX BEFORE STARTING INSTALLATION

Carefully unpack and identify all parts before assembly.  
Bulbs not included.

1. A. Slip shade inside of trim ring and lock into position by bending tabs. See fig. 1.  
B. Place fitter onto bottom of trim ring and shade. Then using a screw driver; lock into position by fastening with rubber washer and screw from inside of shade. **IMPORTANT: Do not over tighten.**  
C. Secure trim ring onto fitter by fastening with small cap screw. Use provided hex key to tighten.
2. Follow enclosed supplement installation instructions for electrical and fixture installation onto house outlet box. If you do not have an outlet box at desired location to attach the fixture than hire a qualified electrician to create one.
3. Install light bulb (not included). See relamping label located near socket area for type and maximum allowed wattage.
4. Install fitter onto fixture plate by fastening with large cap screw. Use provided hex key to tighten.

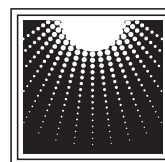
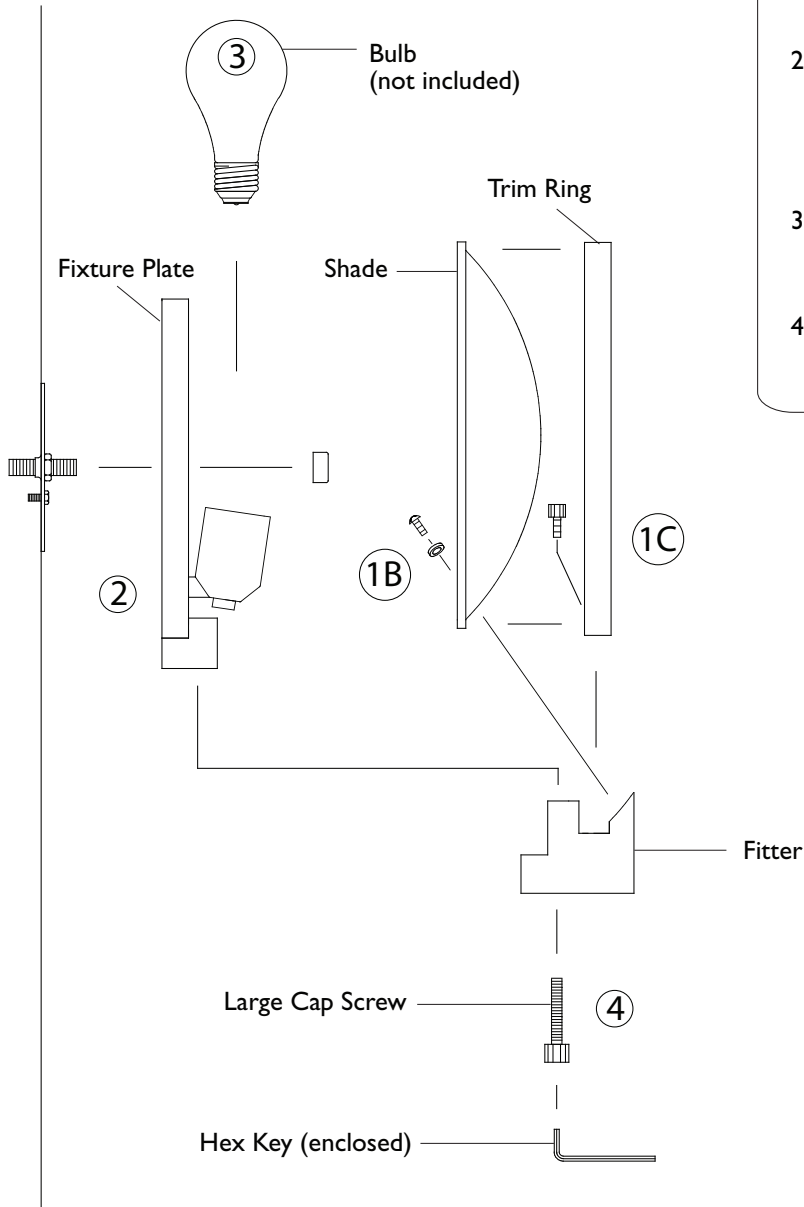

**MURRAY  
FEISS**  
Generation Brands™