

Assembly Instructions For **WB1584** (E) 11/11

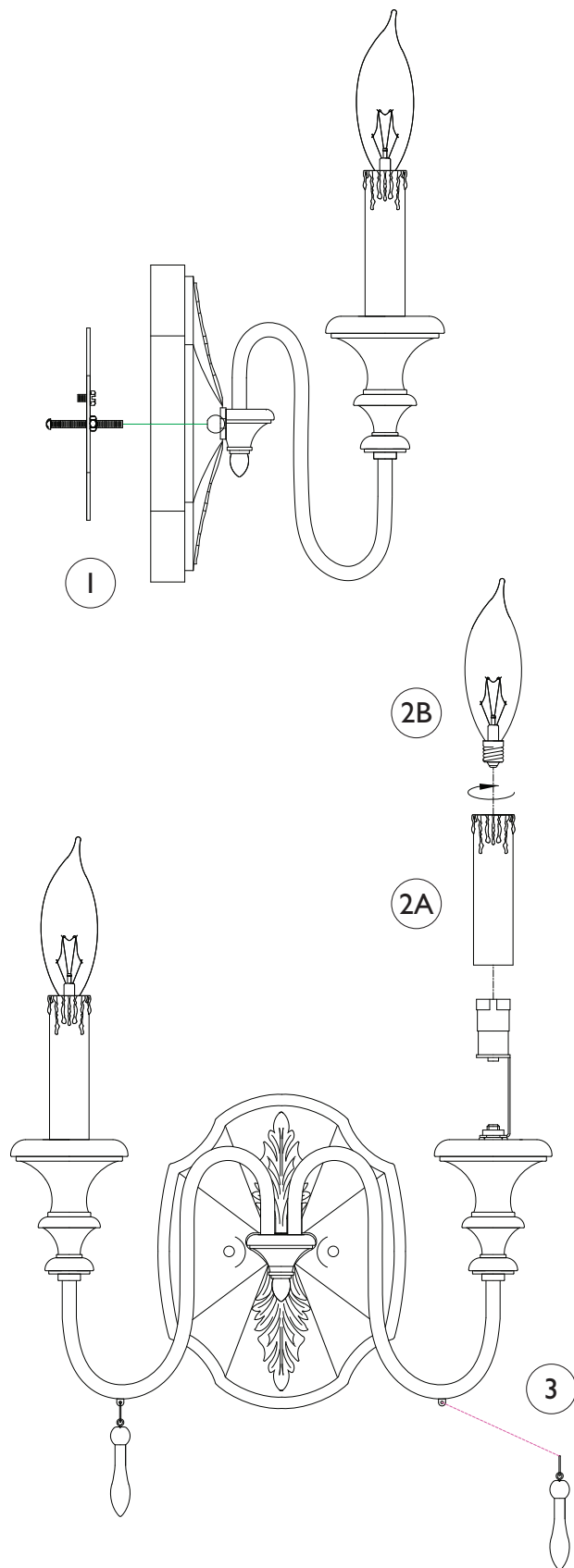

IMPORTANT TURN OFF THE POWER AT THE MAIN FUSE OR CIRCUIT BREAKER BOX BEFORE STARTING INSTALLATION

Carefully unpack and identify all parts before assembly. Bulbs not included.

1. Follow enclosed supplement installation instructions for electrical and fixture installation onto house outlet box. If you do not have an outlet box at desired location to attach the fixture then hire a qualified electrician to create one.
2. A. Install candle tube by slipping through sockets.
B. Install type-B, candelabra base, of 60 Watt maximum bulbs (not included).
3. Hook the tassels onto the fixture arms as shown on the diagram.