



Quoizel, Inc.
6 Corporate Parkway
Goose Creek, SC
29445

Customer Service
Phone 631.273.2700
Fax 631.231.7102
www.quoizel.com

Assembly Instruction Sheet #IS-ADS639DC For Style ADS639DC

Tools Required: Flathead screwdriver, Phillips screwdriver, pliers, wire cutters, wire strippers, electrical tape, safety glasses.

Bulb Recommended: (6) Candelabra Base 60W Maximum

Estimated Assembly Time: 30-45 minutes

Preparation: Identify and inspect all parts before beginning installation. Check package content list and diagrams below to be sure all parts are present. If any parts are missing or damaged, do not attempt to assemble, install, or operate the fixture. Contact customer service for replacement parts.



Warnings and Cautions

Turn off electricity at circuit breaker or main fuse box before installation. Consult a licensed electrician if in doubt.

These instructions are provided for your safety. It is very important you read them completely before installing the fixture. We strongly recommend that a licensed, professional electrician perform the installation.

Disconnect fixture from power source before replacing bulbs. Make sure bulbs are given sufficient time to cool before removal. Do not subject glass parts to any shock while in operation or shattering may result.

Thank you for purchasing a Quoizel product.

Need assistance with parts or assembly? Call Quoizel customer service at 1-631-273-2700
or visit us on-line at www.quoizel.com

ADS639DC
FINISH: DARK CHERRY

ADS639DC
FINISH: DARK CHERRY

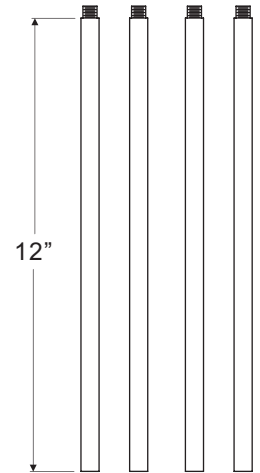
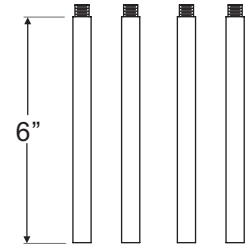
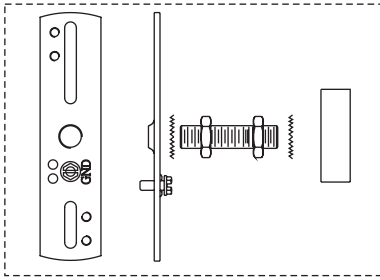

Overall Height 56"
(Includes (2) 6" Rods
and (2) 12" Rods)

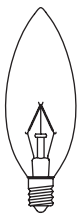
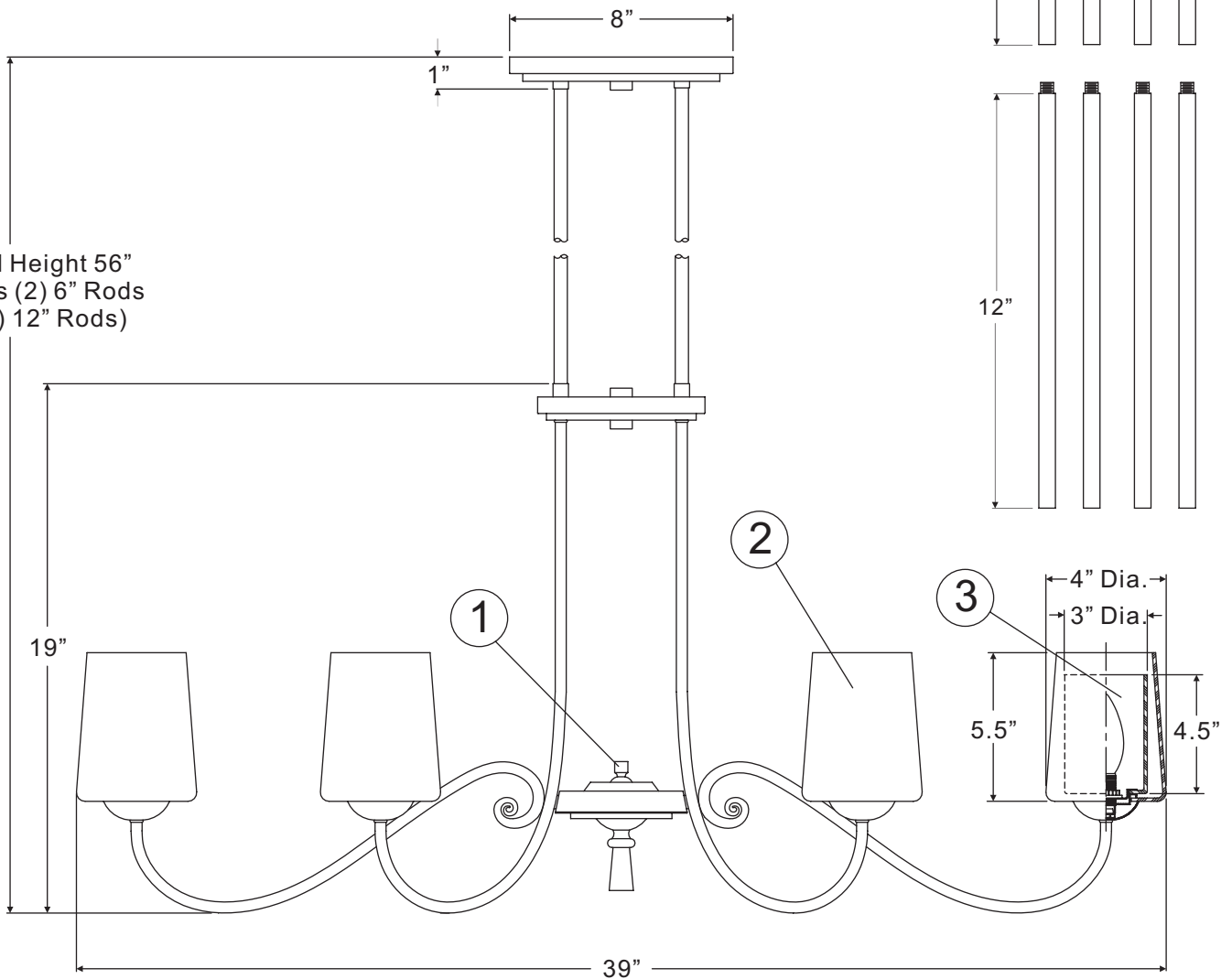

(6)60W Candelabra
base bulbs
(not Supplied)

NOTE: ALL DIMENSIONS ARE ROUNDED UP TO THE NEAREST 1/2"

NO.	PART NUMBER	REPLACEMENT PART DESCRIPTION	REQ.
1	M2300FIDC	FINIAL DARK CHERRY 0.5"D	1
2	G2940SH	SHADE CLEAR WATER GLS 5.5"H	6
3	G2939SH	SHADE OPAL ETCHED GLS 4.5"H	6

Assembly Instruction Sheet #IS-ADS639DC For Style ADS639DC

Package Contents

Part	Description	Quantity
A	Crossbar	1 pc.
B	Nipple	1 pc.
C	Lock Washer	4 pcs.
D	Hex Nut	4 pcs.
E	Lock Ball	1 pc.
F	Socket Collar	6 pcs.
G	Shade Holder A	6 pcs.
H	Shade Holder B	6 pcs.
I	Ceiling Canopy	1 pc.
J	Socket Collar Tool	1 pc.
K	6" Rod	4 pcs.
L	12" Rod	4 pcs.
M	Fixture Assembly	1 pc.
N	Shade A	6 pcs.
O	Shade B	6 pcs.

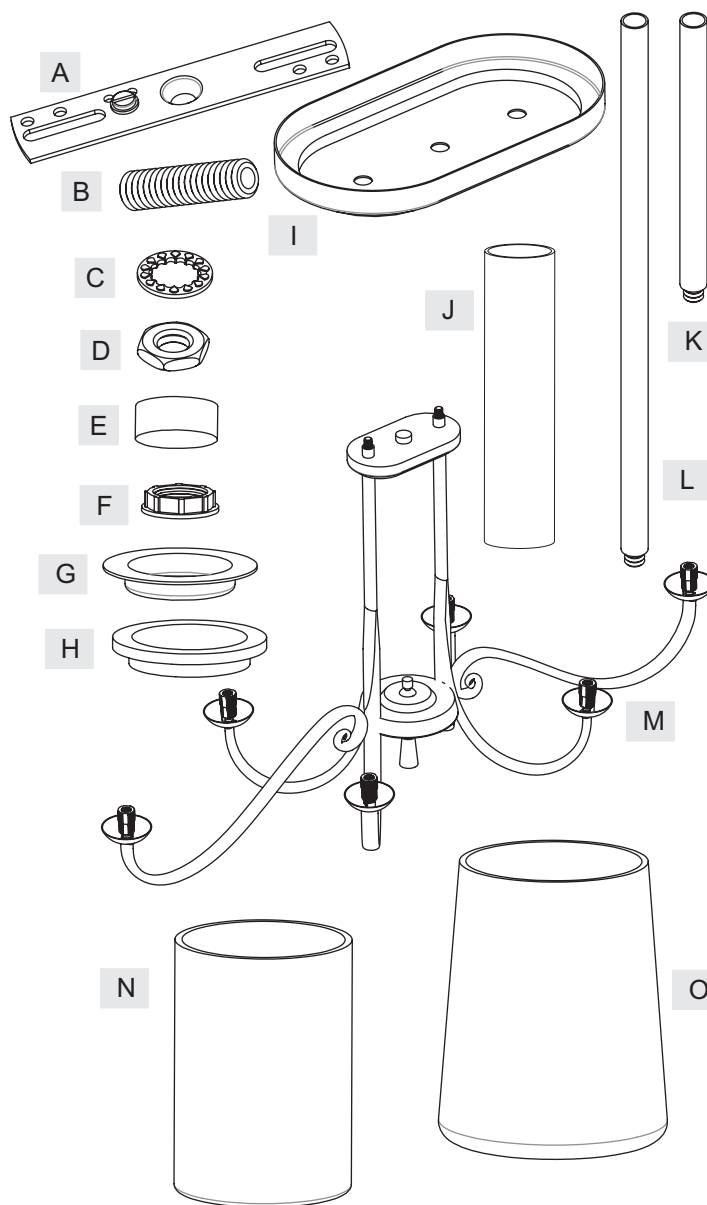

Thank you for purchasing a Quoizel product.
Need assistance with parts or assembly? Call Quoizel customer service at 1-631-273-2700
or visit us on-line at www.quoizel.com

Assembly Instruction Sheet #IS-ADS639DC For Style ADS639DC

STEP 1 – Assemble Rods

- Determine the Rods (K/L) to be assembled according to your hanging height.
- Pass Supply Wires and Ground Wire through the chosen Rods (K/L). Thread the chosen Rods (K/L) and the Fixture Assembly (M) together. Hand tighten until snug.

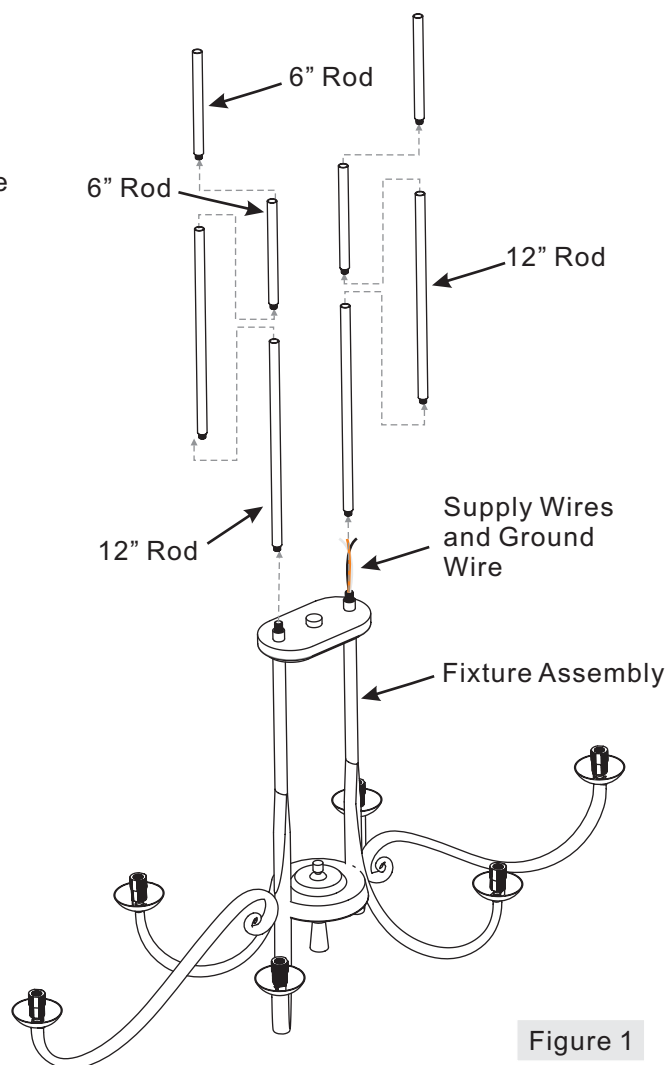
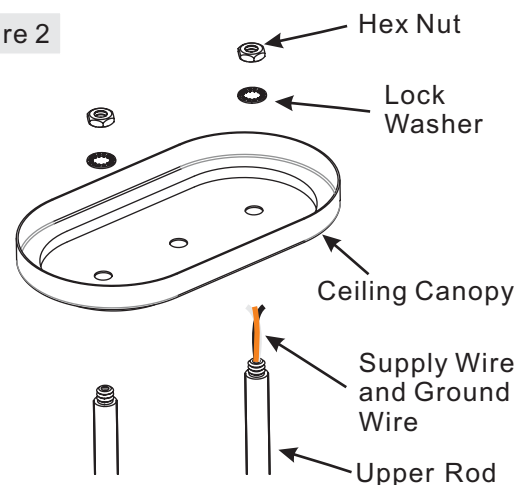

Figure 1

STEP 2 – Assemble Ceiling Canopy

- Pass the Supply Wires and Ground Wires through the Ceiling Canopy (I), Lock Washer (C) and Hex Nut (D).
- Place the Ceiling Canopy (F) and Lock Washers (C) over the nipples on the top ends of Upper Rods and secure with Hex Nuts (D). Tighten until snug.

Figure 2



Thank you for purchasing a Quoizel product.

Need assistance with parts or assembly? Call Quoizel customer service at 1-631-273-2700
or visit us on-line at www.quoizel.com

Assembly Instruction Sheet #IS-ADS639DC For Style ADS639DC

STEP 3 – Attach Crossbar to Outlet Box

- A. Secure the Crossbar (A) to the outlet box with outlet box screws (not supplied). Tighten until snug.

Figure 3

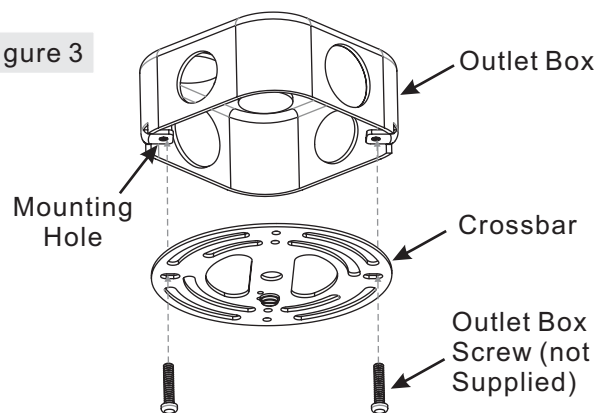

STEP 4 – Attach Nipple to Crossbar

- A. Thread one Hex Nut (D) onto the top end of the Nipple (B).
B. Place one Lock Washer (C) over the top end of the Nipple (B) and then thread the Nipple (B) into the center lock hole of the Crossbar (A).
C. Using pliers, thread the Hex Nut (D) against the Crossbar (A) and hand tighten until snug.

Figure 4

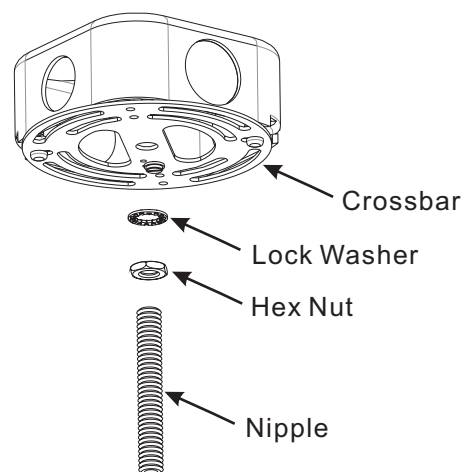

Thank you for purchasing a Quoizel product.

Need assistance with parts or assembly? Call Quoizel customer service at 1-631-273-2700
or visit us on-line at www. quoizel. com

Assembly Instruction Sheet #IS-ADS639DC For Style ADS639DC

STEP 5 – Make Wire Connections

- Use standard wire connectors to make all wire connections. (Connectors are not included with fixture.) Strip and prepare wire ends according to instructions supplied with connectors.
- Connect White Supply Wire from the Outlet Box to White Wire from fixture.
- Connect Black (or Red) Supply Wire from the Outlet Box to Black Wire from fixture.
- Connect Ground Wire from the Outlet Box to Ground Wire from fixture.
- Twist connectors until wires are tightly joined together.
- Wrap each connection with approved electrical tape and carefully stuff all the connected wires into the Outlet Box.

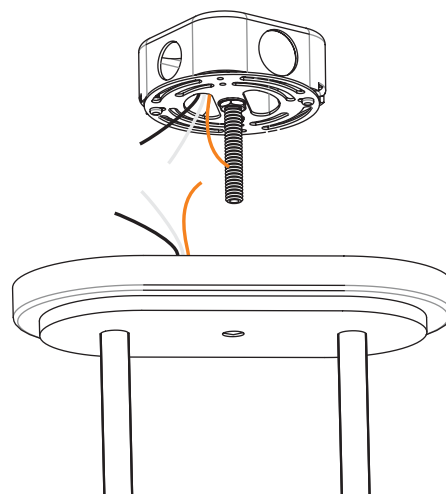

Figure 5

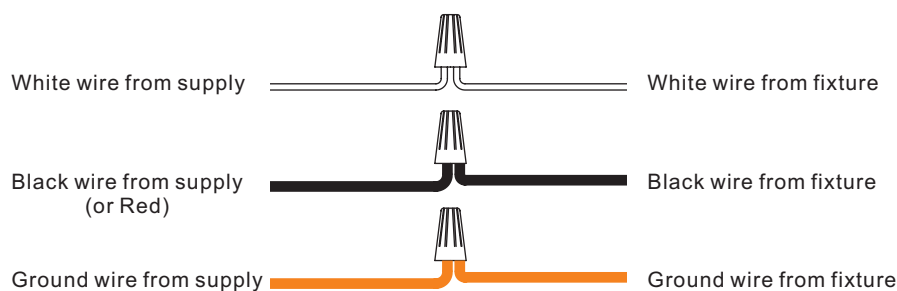

Figure 6

STEP 6 – Install Ceiling Canopy

- Thread another Hex Nut (D) onto the end of the Nipple (B). Place the Lock Washer (C) over the end of the Nipple (B) and then pass the Ceiling Canopy (I) over the end of the Nipple (B). Secure by threading the Lock Ball (E) onto the Nipple (B). Hand tighten until snug.

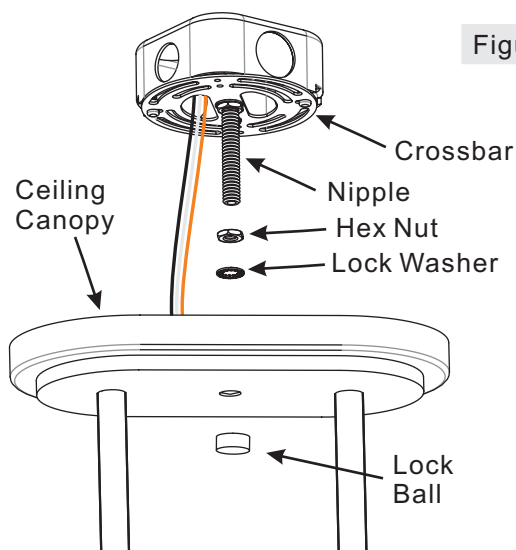

Figure 7

Thank you for purchasing a Quoizel product.

Need assistance with parts or assembly? Call Quoizel customer service at 1-631-273-2700
or visit us on-line at www.quoizel.com

Assembly Instruction Sheet #IS-ADS639DC For Style ADS639DC

STEP 7 – Assemble Shades

- A. Place Shades A and B (N/O), Shade Holder A and B (G/H) over the Socket as shown. By using the Socket Collar Tool (J), thread the Socket Collar (F) onto the Socket to secure above parts. Hand tighten until snug.

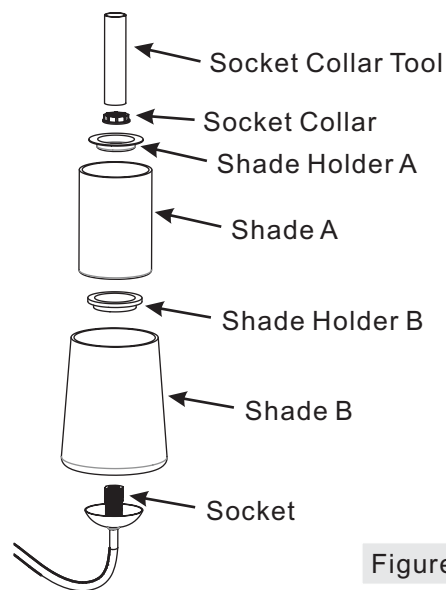

Figure 8

STEP 8 – Install Bulb

- A. This fixture uses candelabra bulb with a candelabra screw base. Maximum 60 watts.
B. Insert bulb and screw snugly into place.

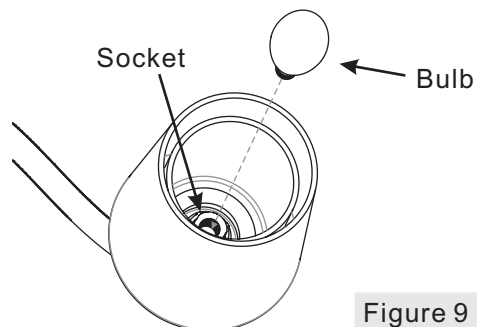

Figure 9

Your fixture chandelier lamp is now assembled and ready to use. Enjoy!

Thank you for purchasing a Quoizel product.

Need assistance with parts or assembly? Call Quoizel customer service at 1-631-273-2700
or visit us on-line at www.quoizel.com