

Tools Required

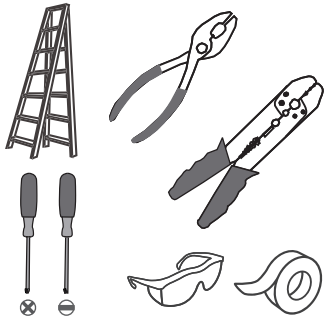

Light Source

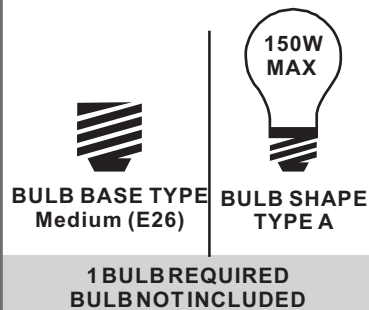

Warnings and Cautions

Turn off the electricity at the circuit breaker before installation. Consult a licensed electrician if in doubt about installation.

Turn off power to the fixture and allow the bulbs to cool before replacing.

Package Contents

Preparation: Identify and inspect all parts before beginning the installation.

Missing or damaged parts? Contact your original place of purchase.

PARTS BAG

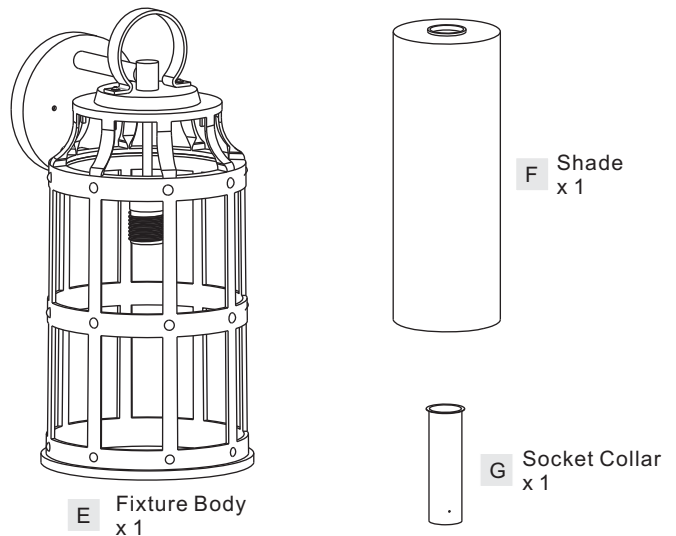
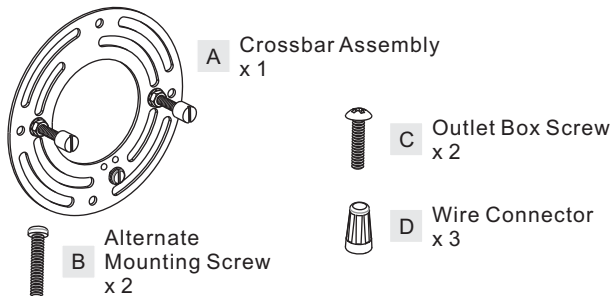

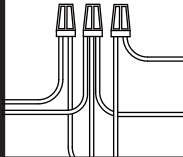
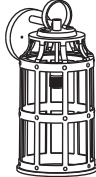
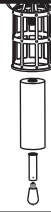
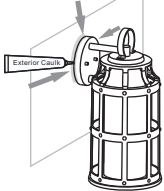

Table of Contents

Alternate Mounting Screw	Crossbar Assembly	Wiring	Fixture Body	Shade & Bulb	Caulk
					
STEP 1	STEP 2	STEP 3	STEP 4	STEP 5	STEP 6

STEP 1

OPTION 1

Standard
Mounting
Screw

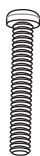

Included
(Pre-assembled)

OPTION 2

Alternate
Mounting
Screw



Included

skip to next page

1

2

3

Steps 1-3 to remove standard mounting screws

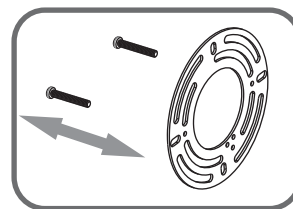
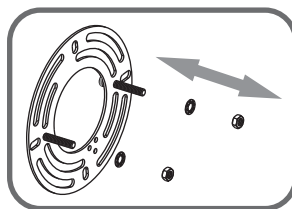
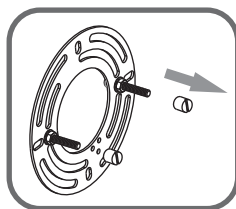

4

Steps 4-6 to reassemble with alternate mounting screws

6

5

STEP 2

1

2

3

Step 1
Install crossbar assembly

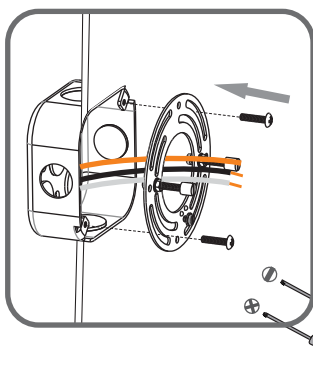

Step 2 - 3
Test fitting backplate to mounting screws

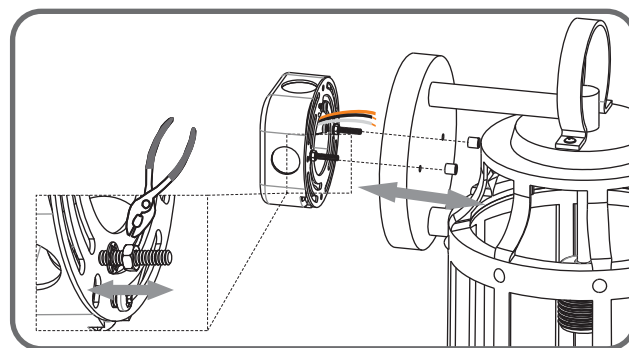
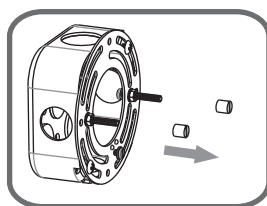

STEP 3

White wire (neutral)
from outlet box

White wire
from fixture

Black or Red wire (hot)
from outlet box

Black wire
from fixture

Bare or Green ground wire
from outlet box

Ground wire
from Fixture

*Green Ground Screw
on crossbar optional

STEP 4

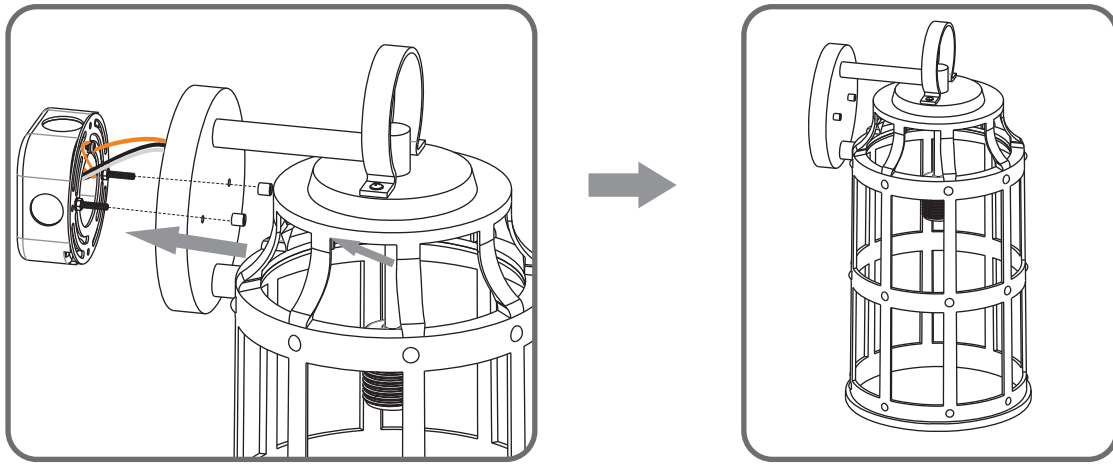

STEP 5

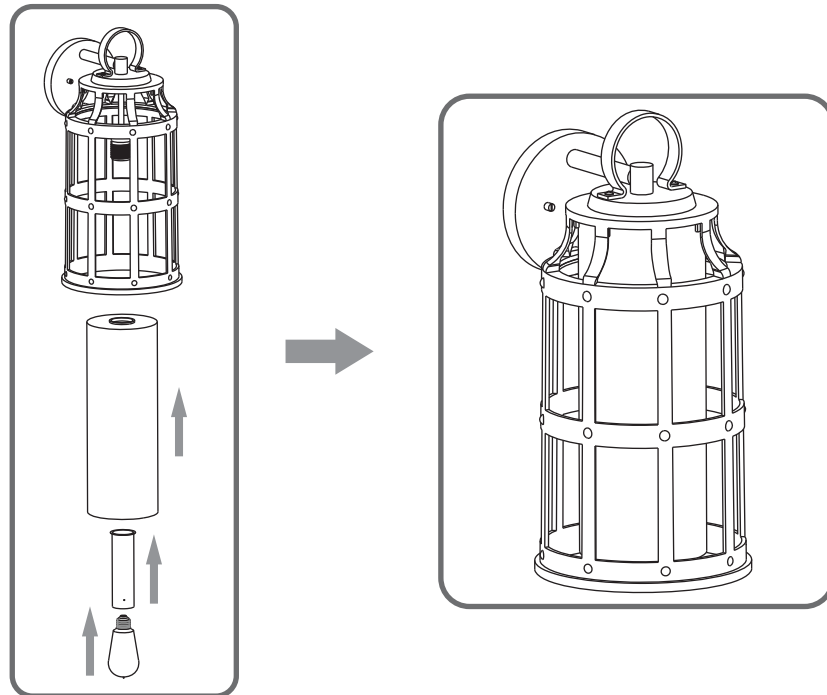

STEP 6

