

Quoizel, Inc.
6 Corporate Parkway
Goose Creek, SC
29445

Customer Service
Phone 631.273.2700
Fax 631.231.7102
www.quoizel.com

Assembly Instruction Sheet #IS-QF1210SBN For Style QF1210SBN

Tools Required: Flathead screwdriver, Phillips screwdriver, pliers, wire cutters, wire strippers, electrical tape, safety glasses.

Bulb Recommended: (3) Medium Base 60W Maximum

Estimated Assembly Time: 20-30 minutes

Preparation: Identify and inspect all parts before beginning installation. Check package content list and diagrams below to be sure all parts are present. If any parts are missing or damaged, do not attempt to assemble, install, or operate the fixture. Contact customer service for replacement parts.



Warnings and Cautions

Turn off electricity at circuit breaker or main fuse box before installation. Consult a licensed electrician if in doubt.

These instructions are provided for your safety. It is very important you read them completely before installing the fixture. We strongly recommend that a licensed, professional electrician perform the installation.

Disconnect fixture from power source before replacing bulbs. Make sure bulbs are given sufficient time to cool before removal. Do not subject glass parts to any shock while in operation or shattering may result.

Package Contents

Part	Description	Quantity
A	Crossbar	1 pc.
B	Nipple	1 pc.
C	Lock Washer	2 pcs.
D	Hex Nut	2 pcs.
E	Lock Screw	3 pcs.
F	Small Flat Washer	3 pcs.
G	Ceiling Canopy	1 pc.
H	Side Panel	3 pcs.
I	Bottom Panel	1 pc.
J	Cage	1 pc.
K	Flat Washer	1 pc.

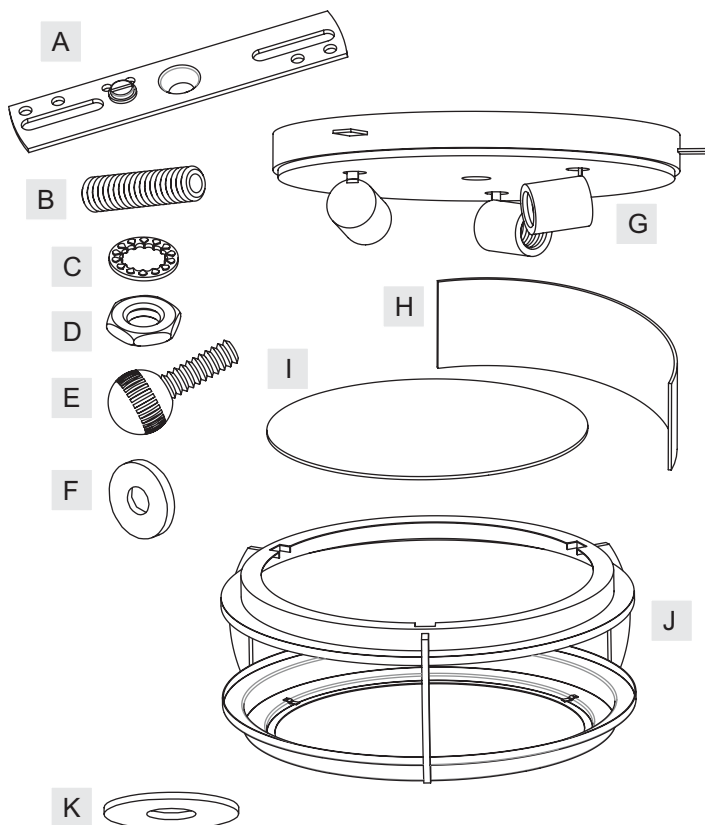

Thank you for purchasing a Quoizel product.

Need assistance with parts or assembly? Call Quoizel customer service at 1-631-273-2700
or visit us on-line at www.quoizel.com

QF1210SBN

FINISH: BRUSHED NICKEL

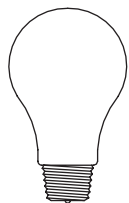
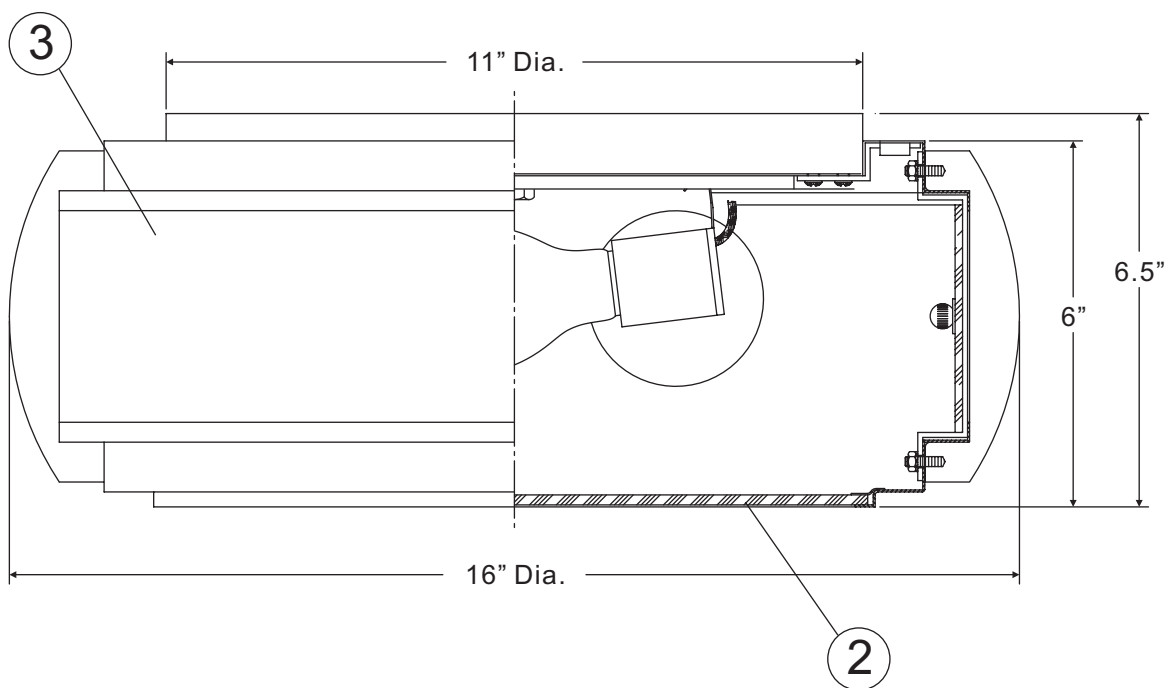
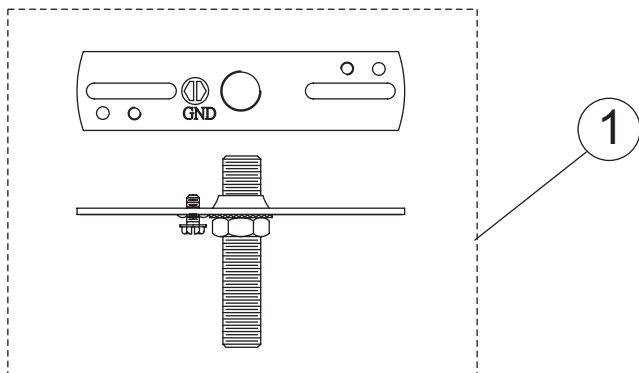

(3)60W medium
base bulbs
(not Supplied)

NOTE: ALL DIMENSIONS ARE ROUNDED UP TO THE NEAREST 1/2"

NO.	PART NUMBER	REPLACEMENT PART DESCRIPTION	REQ.
1	9513KIT	MTG HARDWARE 4"D	1
2	G2932PA	PANEL GLASS BOTTOM 11.5"D	1
3	G2931PA	PANEL GLS/OUTSIDE 3.5"H	3

Assembly Instruction Sheet #IS-QF1210SBN For Style QF1210SBN

STEP 1 – Attach Crossbar to Outlet Box

- A. Secure the Crossbar (A) to the outlet box with outlet box screws (not supplied). Tighten until snug.

Figure 1

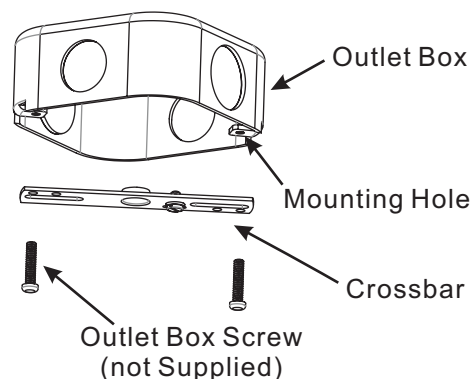

STEP 2 – Attach Nipple to Crossbar

- A. Thread one Hex Nut (D) onto the top end of the Nipple (B).
B. Place one Lock Washer (C) over the top end of the Nipple (B) and then thread the Nipple (B) into the center lock hole of the Crossbar (A).
C. Using pliers, thread the Hex Nut (D) against the Crossbar (A) and hand tighten until snug.

Figure 2

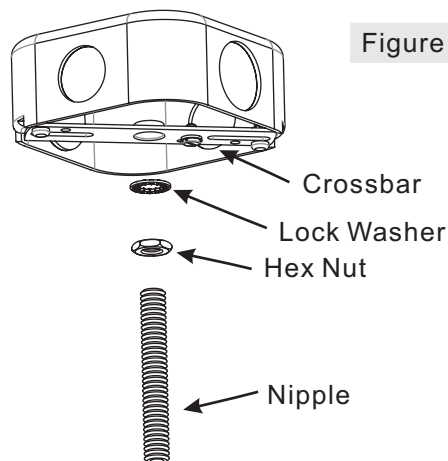

Thank you for purchasing a Quoizel product.
Need assistance with parts or assembly? Call Quoizel customer service at 1-631-273-2700
or visit us on-line at www.quoizel.com

Assembly Instruction Sheet #IS-QF1210SBN

For Style QF1210SBN

STEP 3 – Make Wire Connections

- Use standard wire connectors to make all wire connections. (Connectors are not included with fixture.) Strip and prepare wire ends according to instructions supplied with connectors.
- Connect White Supply Wire from the Outlet Box to White Wire from fixture.
- Connect Black (or Red) Supply Wire from the Outlet Box to Black Wire from fixture.
- Connect Ground Wire from the Outlet Box to Ground Wire from fixture.
- Twist connectors until wires are tightly joined together.
- Wrap each connection with approved electrical tape and carefully stuff all the connected wires into the Outlet Box.

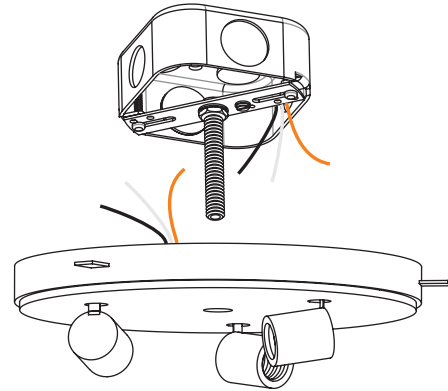

Figure 3

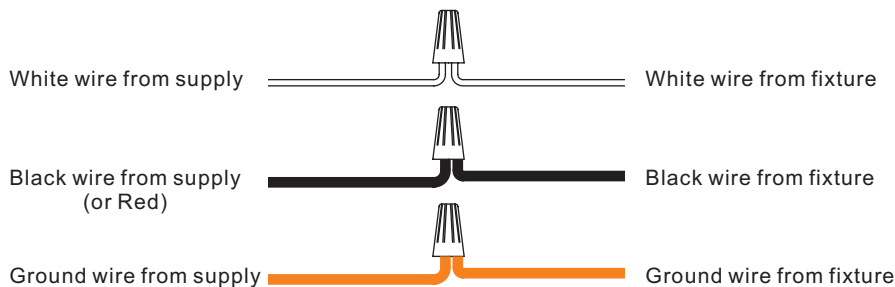

Figure 4

STEP 4 – Attach Ceiling Canopy to Outlet Box

- Place the Ceiling Canopy (G), Flat Washer (K) and one Lock Washer (C) over the Nipple (B) as shown. Secure by threading the Hex Nut (D) onto the Nipple (B). Hand tighten until snug.

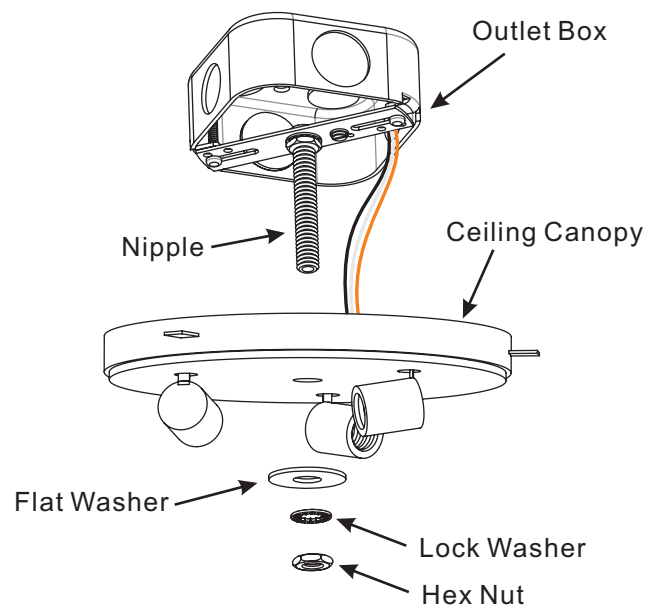

Figure 5

Thank you for purchasing a Quoizel product.

Need assistance with parts or assembly? Call Quoizel customer service at 1-631-273-2700 or visit us on-line at www.quoizel.com

Assembly Instruction Sheet #IS-QF1210SBN For Style QF1210SBN

STEP 5 – Assemble Bottom Panel

- A. Place the Bottom Panel (I) in the bottom of the Cage (J) and secure with Tabs in the Cage (J).

Figure 6

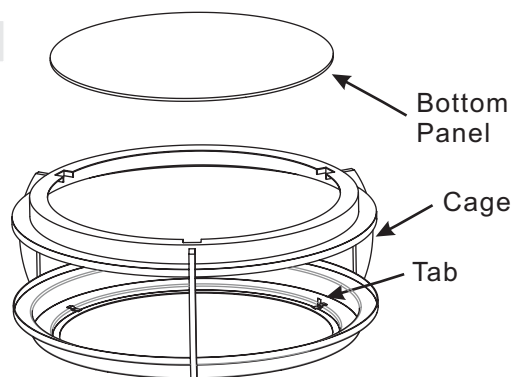

STEP 6 – Locate Side Panels

- A. Place the Side Panels (H) inside of the Cage (J) as shown.

Figure 7

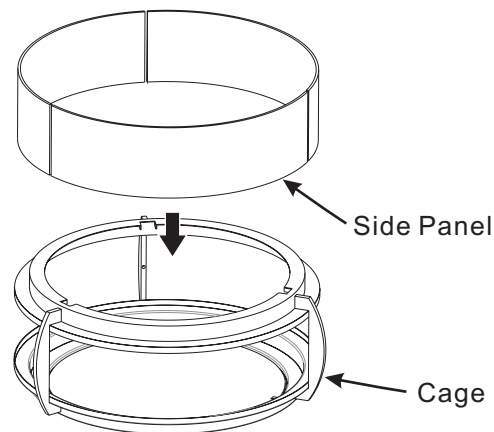

STEP 7 – Secure Side Panels

- A. Pass the Small Flat Washer (F) over the Lock Screw (E) and thread the Lock Screw (E) into the Mounting Hole in the Cage (J). Tighten until snug to secure Side Panels (H).

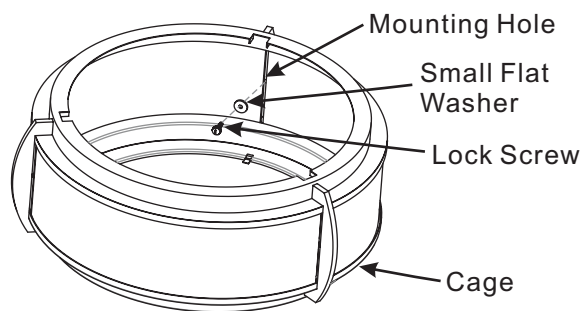

Figure 8

Thank you for purchasing a Quoizel product.
Need assistance with parts or assembly? Call Quoizel customer service at 1-631-273-2700
or visit us on-line at www.quoizel.com

Assembly Instruction Sheet #IS-QF1210SBN For Style QF1210SBN

STEP 8 – Install Bulb

- A. This fixture uses standard bulbs with medium screw bases. Maximum 60 watts.
- B. Insert bulb and screw snugly into place.

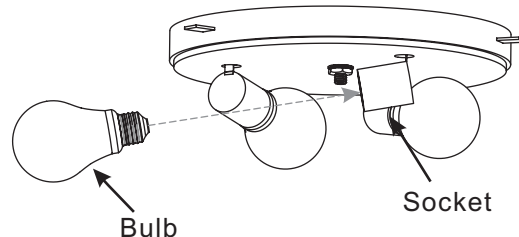

Figure 9

STEP 9 – Attach Cage with Panels to Ceiling Canopy

- A. Lift the Cage (J) upward. Pass the Bars on the side of the Ceiling Canopy (G) through the Gaps on the top edge of the Cage (J). And then rotate the Cage. Carefully free your hands to make sure the Cage (J) is seated well.

Your fixture flush mount lamp is now assembled and ready to use. Enjoy!

Figure 10

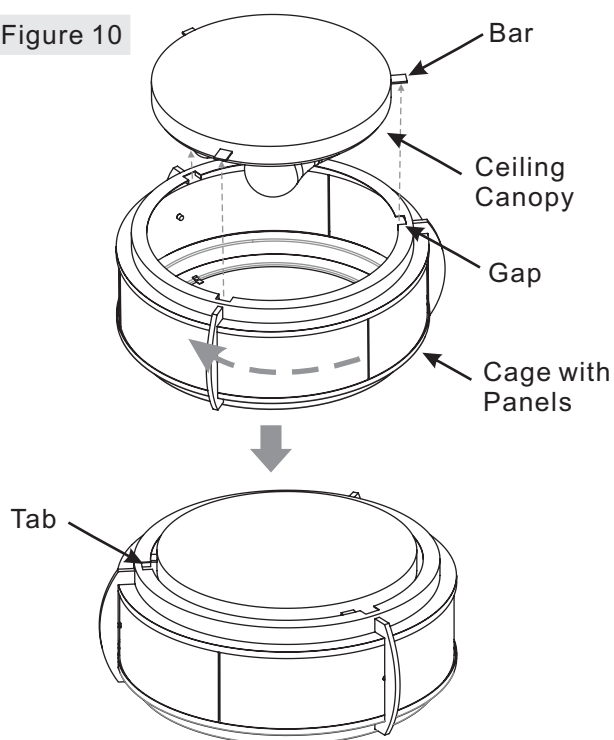

Thank you for purchasing a Quoizel product.

Need assistance with parts or assembly? Call Quoizel customer service at 1-631-273-2700
or visit us on-line at www.quoizel.com

Assembly Instruction Sheet #IS-QF1210SBN For Style QF1210SBN

STEP 10 – Replace Bulb

- If you need replace the burnt or broken Bulb inside of the Cage (J) after assembly, please rotate the Cage (J) until the Bars on the Ceiling Canopy (G) attach to the Tabs on the top edge of the Cage (J). Then push up the Cage (J) and rotate it until the Cage (J) can be removed easily.
- Replace the burnt or broken bulb referring to fixture markings and/or labels for maximum wattage.
- Return to Step 8 to assemble the Cage (J).

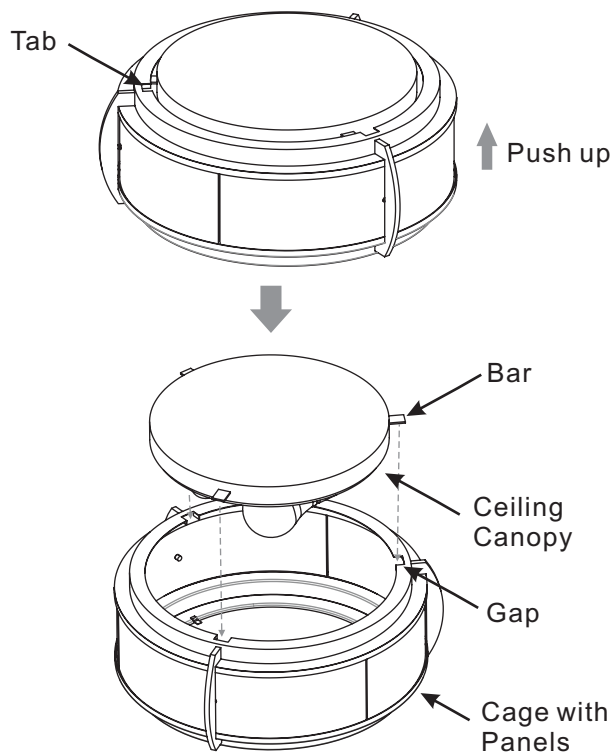

Figure 11

Thank you for purchasing a Quoizel product.

**Need assistance with parts or assembly? Call Quoizel customer service at 1-631-273-2700
or visit us on-line at www.quoizel.com**