

Quoizel, Inc.  
6 Corporate Parkway  
Goose Creek, SC  
29445

Customer Service  
Phone 631.273.2700  
Fax 631.231.7102  
www. quoizel. com

## Assembly Instruction Sheet #IS-TCR1718BN For Style TCR1718BN

**Tools Required:** Flathead screwdriver, Phillips screwdriver, pliers, wire cutters, wire strippers, electrical tape, safety glasses.

**Bulb Recommended:** (3) Medium Base 100W Maximum

**Estimated Assembly Time:** 20-30 minutes

**Preparation:** Identify and inspect all parts before beginning installation. Check package content list and diagrams below to be sure all parts are present. If any parts are missing or damaged, do not attempt to assemble, install, or operate the fixture. Contact customer service for replacement parts.



### Warnings and Cautions

Turn off electricity at circuit breaker or main fuse box before installation. Consult a licensed electrician if in doubt.

These instructions are provided for your safety. It is very important you read them completely before installing the fixture. We strongly recommend that a licensed, professional electrician perform the installation.

Disconnect fixture from power source before replacing bulbs. Make sure bulbs are given sufficient time to cool before removal. Do not subject glass parts to any shock while in operation or shattering may result.

Thank you for purchasing a Quoizel product.

Need assistance with parts or assembly? Call Quoizel customer service at 1-631-273-2700  
or visit us on-line at [www. quoizel. com](http://www. quoizel. com)

TCR1718BN

FINISH: BRUSHED NICKEL

3

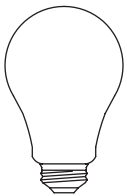
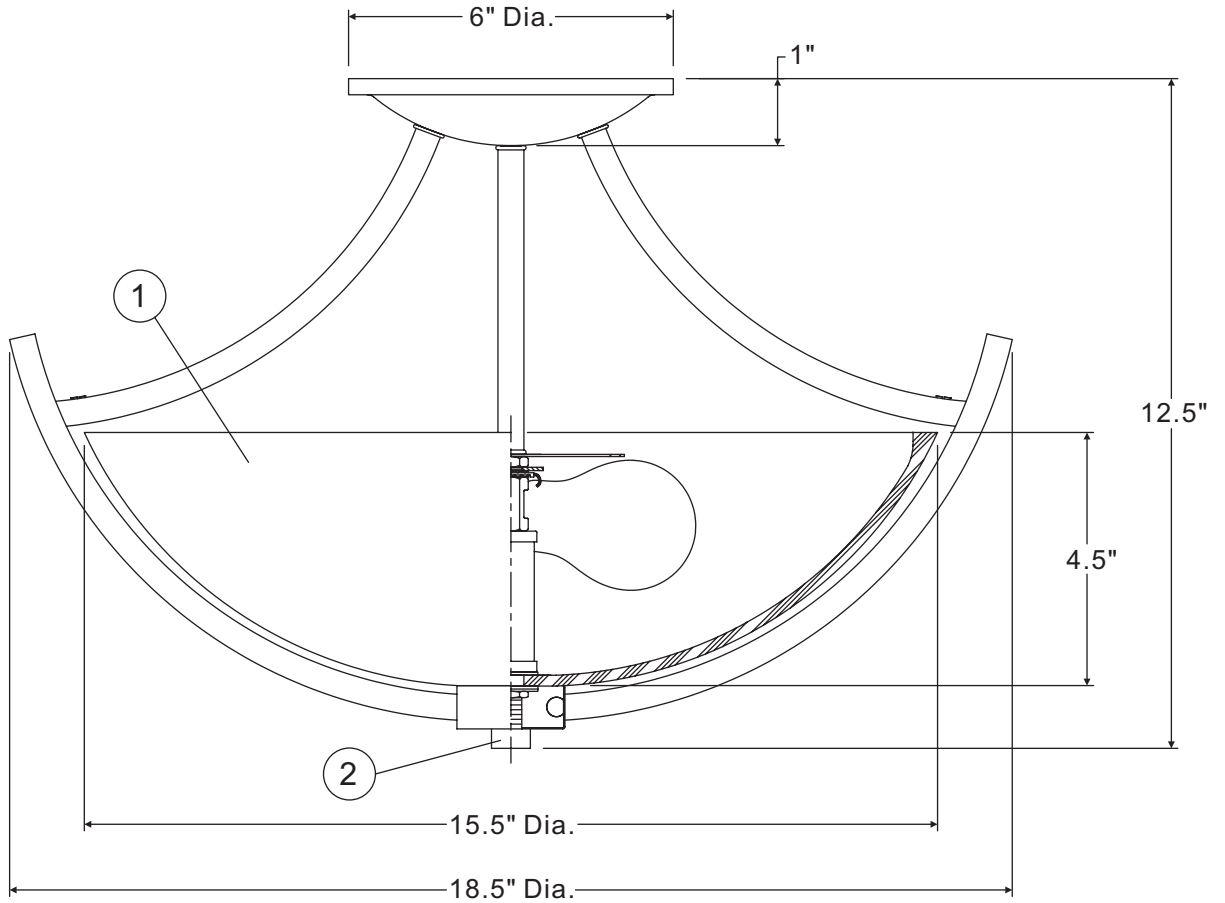
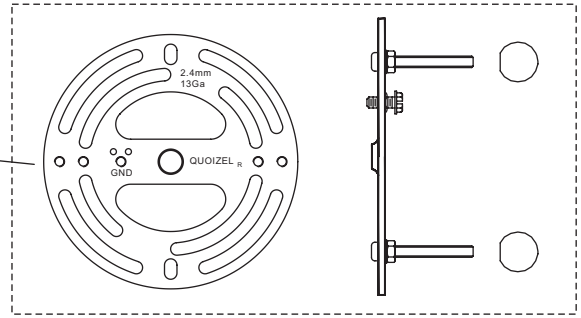

(3)100W A19  
Medium Base Bulbs  
(Not Supplied)

NOTE: ALL DIMENSIONS ARE ROUNDED UP TO THE NEAREST 1/2"

NO.	PART NUMBER	REPLACEMENT PART DESCRIPTION	REQ.
1	G3279SH	ETCHED GLASS PAINTED WHITE 16"D	1
2	M2334FIBN	FINIAL SET 0.86"D X 3.5"L	1
3	9542KIT	MOUNTING HARDWARE BRUSHED NICKEL 4"D	1

# Assembly Instruction Sheet #IS-TCR1718BN

## For Style TCR1718BN

### Package Contents

Part	Description	Quantity
A	Crossbar	1 pc
B	Mounting Screw	2 pcs
C	Lock Washer	2 pcs
D	Hex Nut	2 pcs
E	Mounting Ball	2 pcs
F	Socket Assembly	1 pc
G	Lock Screw	3 pcs
H	Side Arm	3 pcs
I	Flat Head Screw	3 pcs
J	Nipple with Hex Nut	1 pc
K	Spacer Tube	1 pc
L	Check Ring	1 pc
M	Flat Washer	1 pc
N	Rubber Washer	1 pc
O	1/8 Hex Nut	1 pc
P	Shade	1 pc
Q	Shade Holder	1 pc
R	Cap	1 pc
S	Finial	1 pc

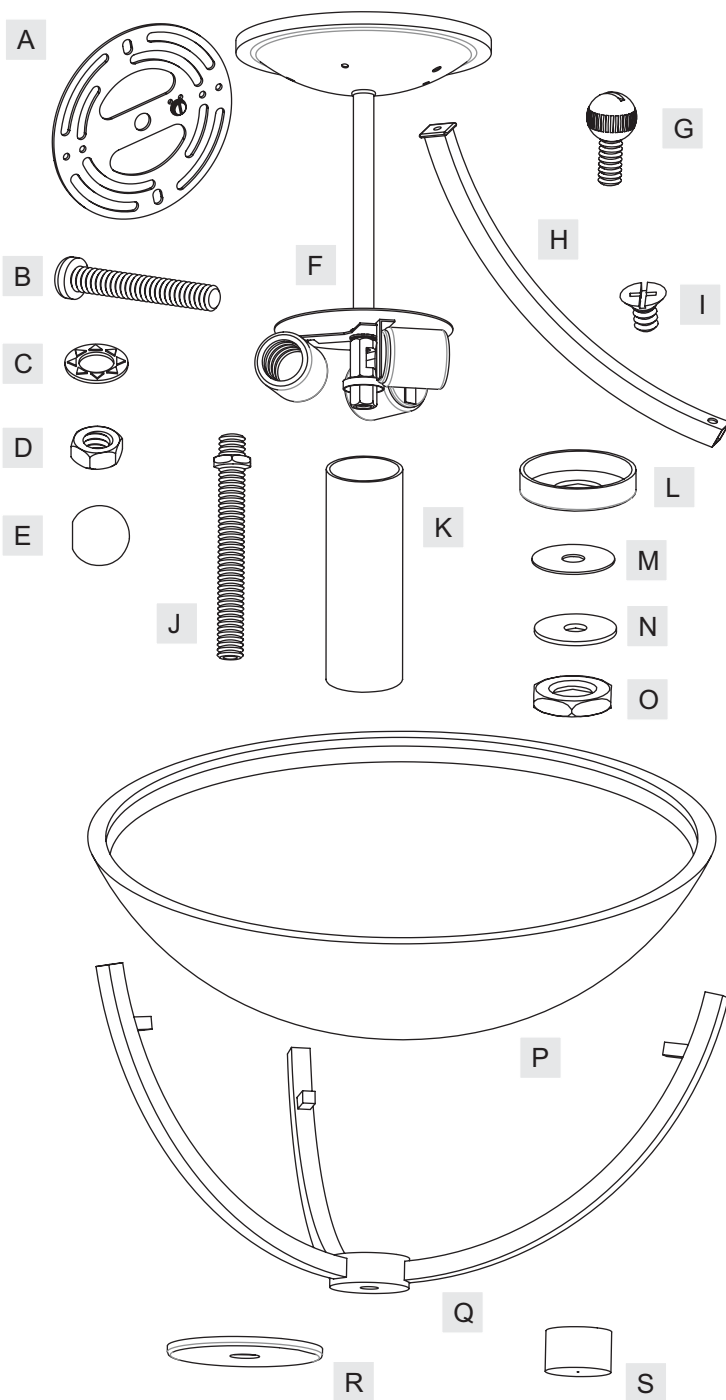

Thank you for purchasing a Quoizel product.

Need assistance with parts or assembly? Call Quoizel customer service at 1-631-273-2700  
or visit us on-line at [www. quozel. com](http://www. quozel. com)

# Assembly Instruction Sheet #IS-TCR1718BN

## For Style TCR1718BN

### STEP 1 – Attach Mounting Screws, Lock Washers and Hex Nuts to Crossbar

- Line up a set of holes on the Crossbar (A) and Holes on the Ceiling Canopy.
- Thread Mounting Screws (B) into the holes on the Crossbar (A), pass Lock Washers (C) and thread Hex Nut (D) onto the Mounting Screws (B). Hand tighten until snug.

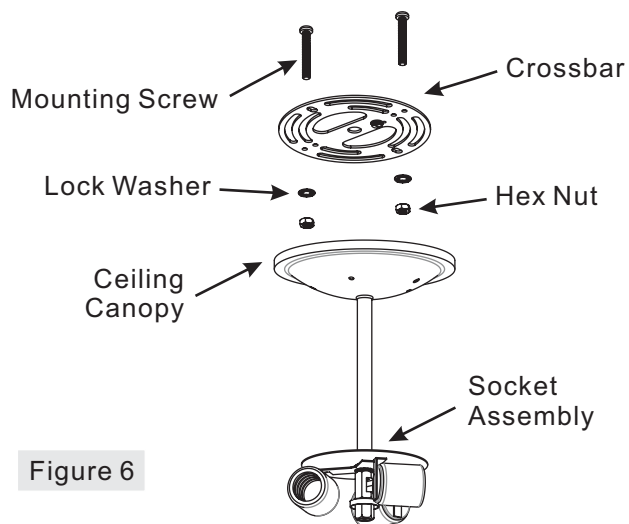

### STEP 2 – Assemble Nipple with Hex Nut

- Thread one end of Nipple with Hex Nut(J) into the Hex Coupling underside of the Socket Assembly (F). By using pliers, thread the Hex Nut against the Hex Coupling underside of the Socket Assembly (F). Hand-tighten until snug.

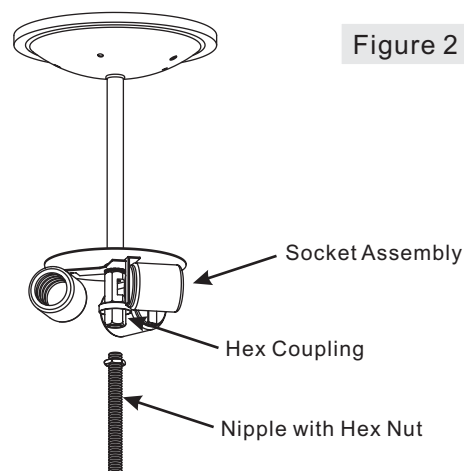

Thank you for purchasing a Quoizel product.

Need assistance with parts or assembly? Call Quoizel customer service at 1-631-273-2700  
or visit us on-line at [www.quoizel.com](http://www.quoizel.com)

# Assembly Instruction Sheet #IS-TCR1718BN

## For Style TCR1718BN

### STEP 3 – Assemble Shade

- A. Pass the Spacer Tube (K), the Check Ring (L), the Rubber Washer (N), the Shade (P) and the Flat Washer (M) over the end of the Nipple (J) in turn. Secure by threading the Hex Nut (O) onto the Nipple (J). Hand tighten until snug.

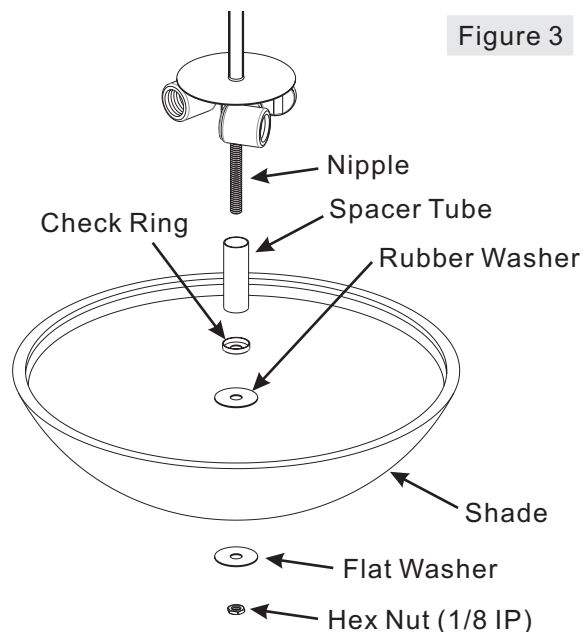

### STEP 4 – Assemble Shade Holder

- A. Place the Shade Holder (Q) over the end of the Nipple (J). Line up side arms on the Shade Holder and the (3) Holes on the side of the Ceiling Canopy.
- B. Place the Cap (R) over the end of the Nipple (J) and secure with the Finial (S). Hand tighten until snug.

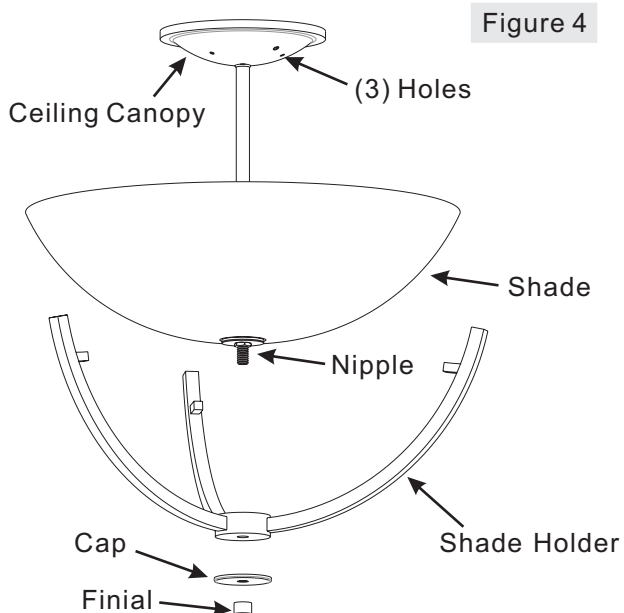

Thank you for purchasing a Quoizel product.

Need assistance with parts or assembly? Call Quoizel customer service at 1-631-273-2700  
or visit us on-line at [www.quoizel.com](http://www.quoizel.com)

## Assembly Instruction Sheet #IS-TCR1718BN For Style TCR1718BN

### STEP 5 – Attach Side Arms

- A. Locate Side Arms (H). Insert the Block on the Shade Holder (Q) into the end of the Side Arm (H). By using pliers, thread Flat Head Screw (I) into the mounting hole on the Block to secure Side Arm (H).
- B. Attach the top end of the Side Arm (H) to the Holes on the Ceiling Canopy. Thread Lock Screw (G) into the top end of the Side Arm (H) and hand tighten until snug to secure them together.

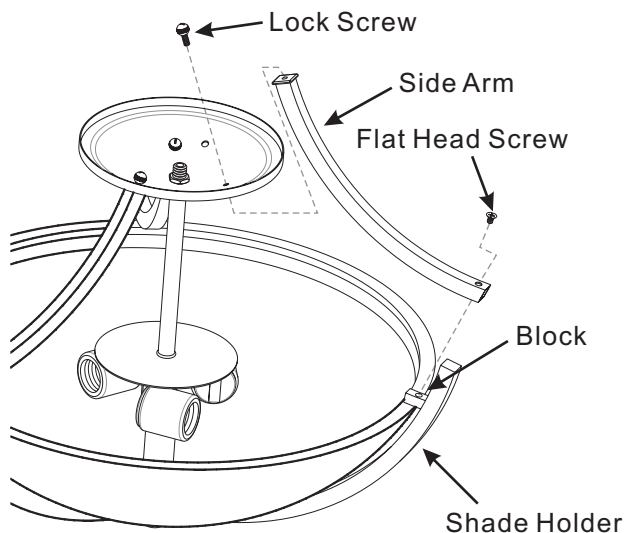

Figure 5

### STEP 6 – Attach Crossbar to Outlet Box

- A. Attach the Crossbar (A) to Outlet Box and secure by threading Outlet Box Screws (not supplied) into the Mounting Holes on the Outlet Box. Tighten until snug.

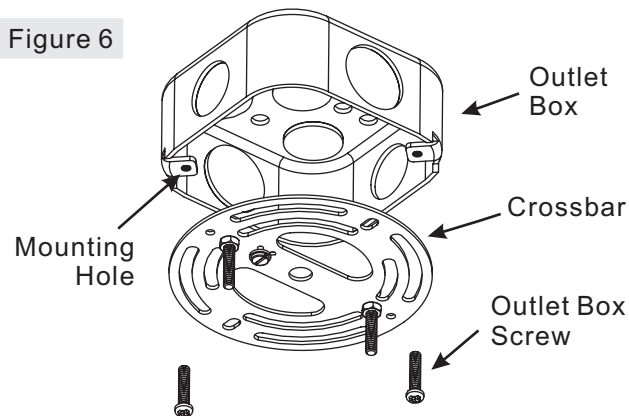

Figure 6

Thank you for purchasing a Quoizel product.

Need assistance with parts or assembly? Call Quoizel customer service at 1-631-273-2700  
or visit us on-line at [www.quoizel.com](http://www.quoizel.com)

## Assembly Instruction Sheet #IS-TCR1718BN For Style TCR1718BN

### STEP 7 – Make Wire Connections

- A. Use standard wire connectors to make all wire connections. (Connectors are not included with fixture.) Strip and prepare wire ends according to instructions supplied with connectors.
- B. Connect White Supply Wire from the Outlet Box to White Wire from fixture.
- C. Connect Black (or Red) Supply Wire from the Outlet Box to Black Wire from fixture.
- D. Connect Ground Wire from the Outlet Box to Ground Wire from fixture.
- E. Twist connectors until wires are tightly joined together.
- F. Wrap each connection with approved electrical tape and carefully stuff all the connected wires into the Outlet Box.

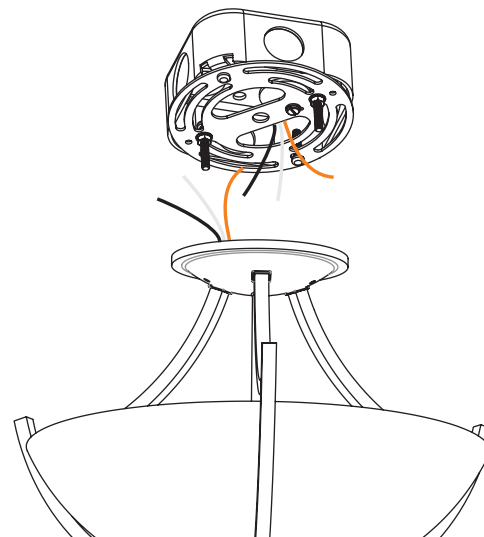

Figure 7

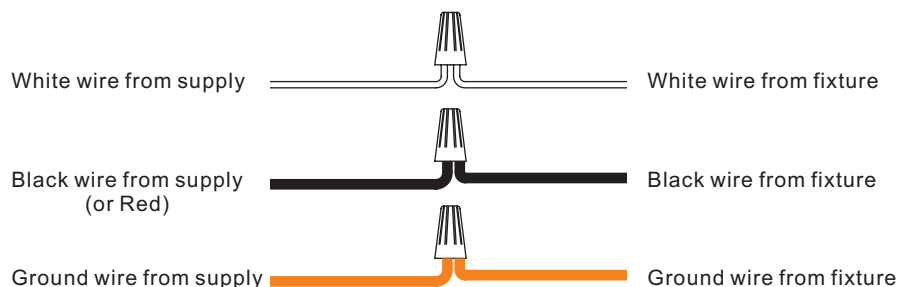

Figure 8

### STEP 8 – Attach Ceiling Canopy to Mounting Screw

- A. Place the Ceiling Canopy on the top of the Socket Assembly (F) over the Mounting Screws (B) and secure with Mounting Balls (E). Hand tighten until snug.

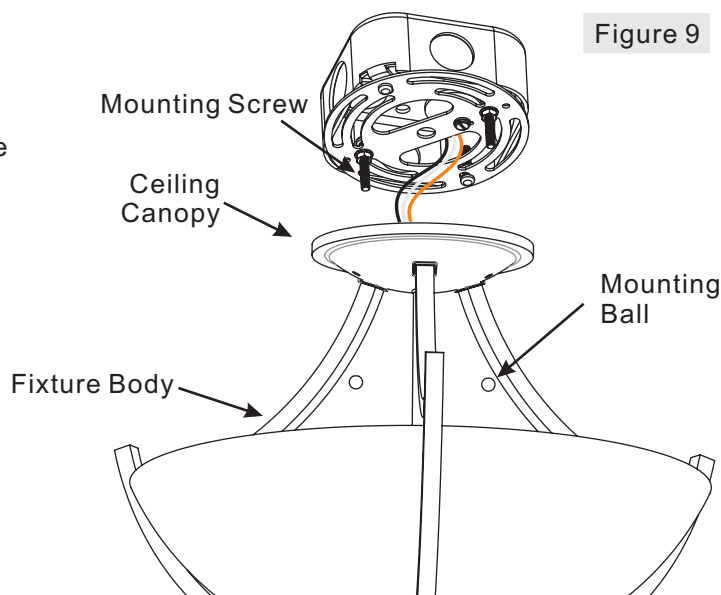

Figure 9

Thank you for purchasing a Quoizel product.

Need assistance with parts or assembly? Call Quoizel customer service at 1-631-273-2700  
or visit us on-line at [www. quozel. com](http://www. quozel. com)

## Assembly Instruction Sheet #IS-TCR1718BN For Style TCR1718BN

### STEP 9 – Install Bulb

- A. This fixture uses standard bulb with a standard screw base.  
Maximum 100 watts.
- B. Insert bulb and screw properly into place.

Your fixture is now assembled and ready to use. Enjoy!

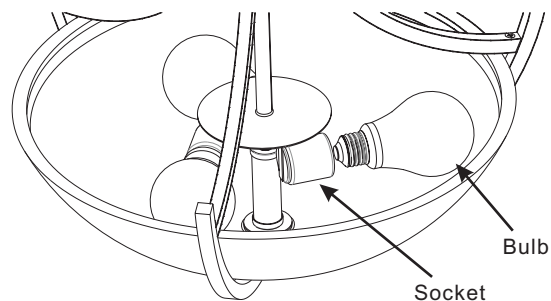

Figure 10

Thank you for purchasing a Quoizel product.

Need assistance with parts or assembly? Call Quoizel customer service at 1-631-273-2700  
or visit us on-line at [www.quoizel.com](http://www.quoizel.com)