

Quoizel, Inc.
6 Corporate Parkway
Goose Creek, SC
29445

Customer Service
Phone 631.273.2700
Fax 631.231.7102
www. quoizel. com

Assembly Instruction Sheet #IS-TF1217CBN For Style TF1217CBN

Tools Required: Flathead screwdriver, Phillips screwdriver, pliers, wire cutters, wire strippers, electrical tape, safety glasses.

Bulb Recommended: (3) G9 Base Frosted G9 Halogen 75W Maximum

Estimated Assembly Time: 20-30 minutes

Preparation: Identify and inspect all parts before beginning installation. Check package content list and diagrams below to be sure all parts are present. If any parts are missing or damaged, do not attempt to assemble, install, or operate the fixture. Contact customer service for replacement parts.



Warnings and Cautions

Turn off electricity at circuit breaker or main fuse box before installation. Consult a licensed electrician if in doubt.

These instructions are provided for your safety. It is very important you read them completely before installing the fixture. We strongly recommend that a licensed, professional electrician perform the installation.

Disconnect fixture from power source before replacing bulbs. Make sure bulbs are given sufficient time to cool before removal. Do not subject glass parts to any shock while in operation or shattering may result.

Thank you for purchasing a Quoizel product.

Need assistance with parts or assembly? Call Quoizel customer service at 1-631-273-2700
or visit us on-line at www. quoizel. com

TF1217CBN

FINISH: BRUSHED NICKEL

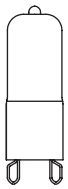
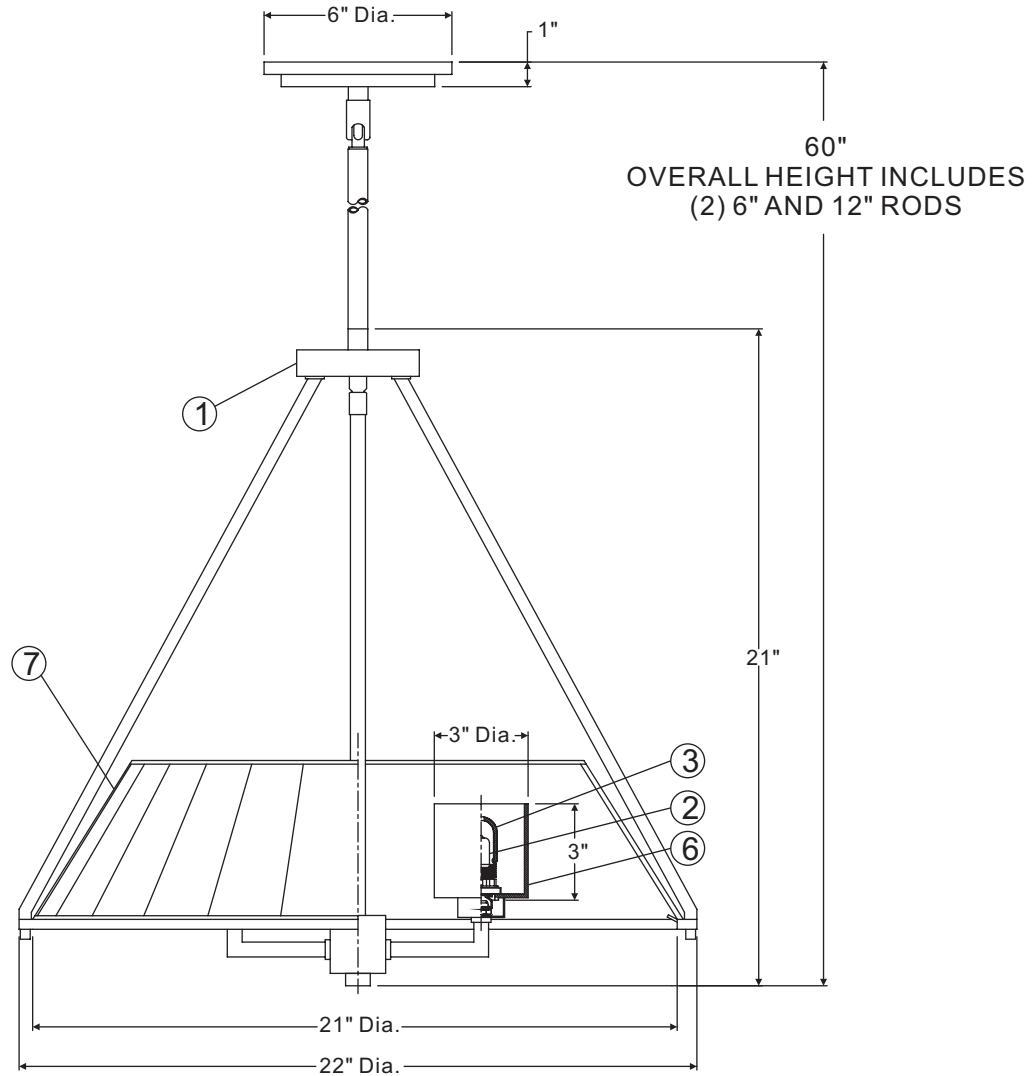
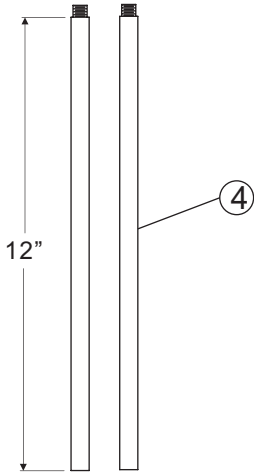
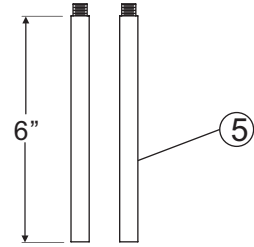
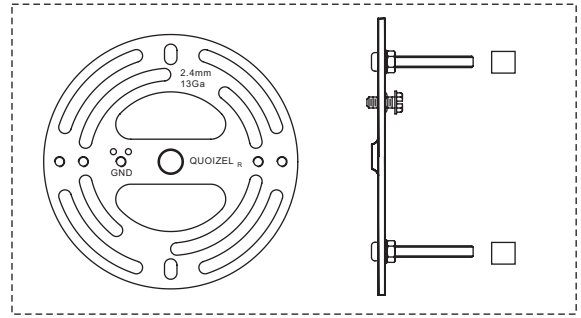

(3)75W Frosted
G9 Halogen Bulbs
(Supplied)

NOTE: ALL DIMENSIONS ARE ROUNDED UP TO THE NEAREST 1/2"

NO.	PART NUMBER	REPLACEMENT PART DESCRIPTION	REQ.
1	11217CBNTF	BASE BRUSHED NICKEL TF1217CBN	1
2	I828SF	BULB 120V 75W HALOGEN G9 FROSTED	3
3	G2641BS	BULB SHIELD GLASS 1"D X 2"H	3
4	9007EXBN	ROD EXT BRUSHED NICKEL 12"L X 0.63"D	2
5	9008EXBN	ROD EXT BRUSHED NICKEL 6"L X 0.63"D	2
6	G2984SH	SHADE OPAL GLASS BODY 3"D X 3"H	3
7	G2985SH	SHADE TIFF GLASS BODY 21"D	1

Assembly Instruction Sheet #IS-TF1217CBN For Style TF1217CBN

Package Contents

Part	Description	Quantity
A	Crossbar	1 pc.
B	Mounting Screw	2 pcs.
C	Lock Washer	2 pcs.
D	Hex Nut	2 pcs.
E	Mounting Ball	2 pcs.
F	Ceiling Canopy	1 pc.
G	6" Rod	2 pcs.
H	12" Rod	2 pcs.
I	Center Rod Assembly	1 pc.
J	Tiffany Shade	1 pc.
K	Socket Collar	3 pcs.
L	Steel Collar	3 pcs.
M	Mounting Ball (without slot)	3 pcs.
N	Shade Holder	1 pc.
O	Glass Shade	3 pcs.
P	1/8 Hex Nut	3 pcs.
Q	1/8 Lock Washer	3 pcs.
R	Coupling (1/8 IP screw inside)	1 pc.
S	Plate	1 pc.
T	Side Arm	3 pcs.
U	G9 Bulb	3 pcs.
V	Bulb Shield	3 pcs.
W	Socket Collar Tool	1 pc.
X	Socket Assembly	1 pc.

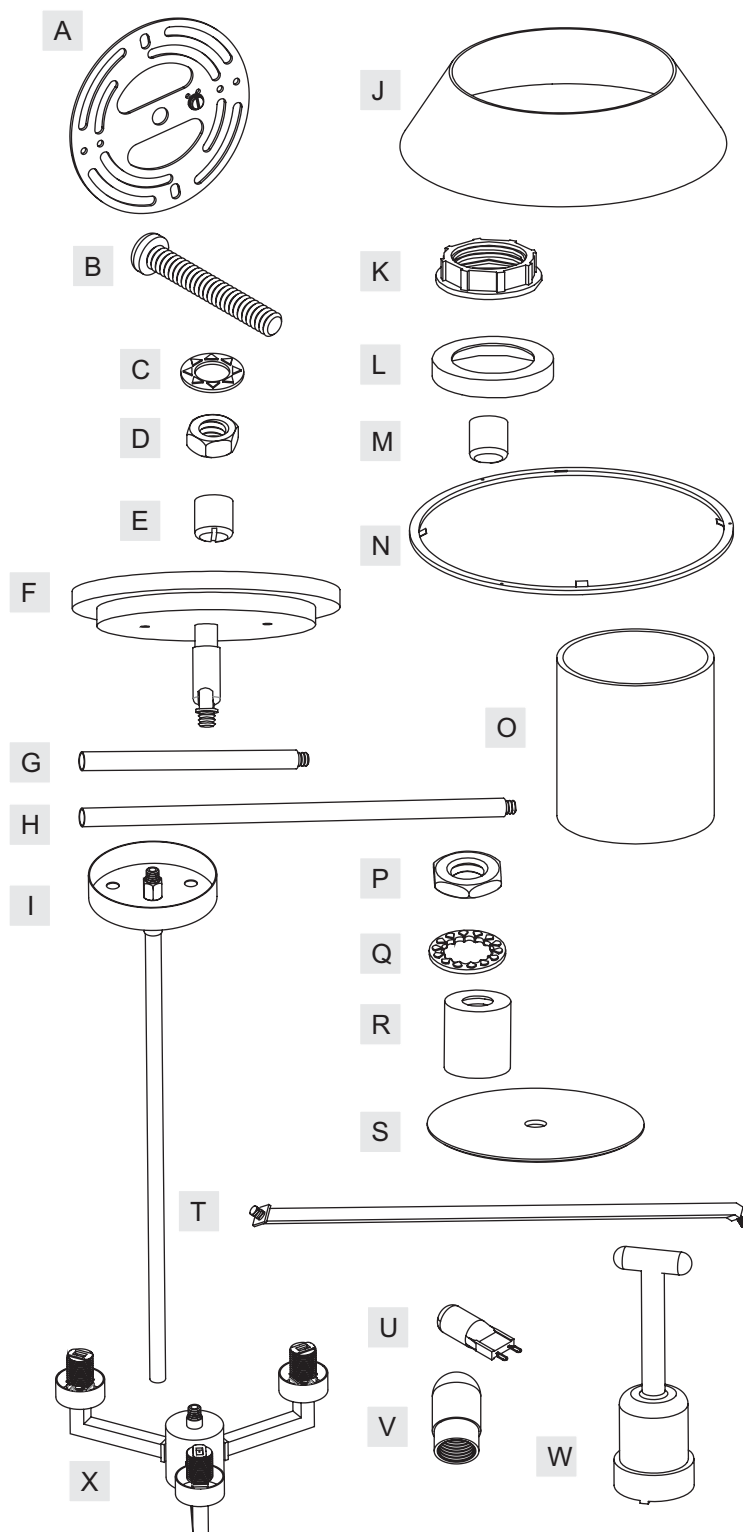

Thank you for purchasing a Quoizel product.

Need assistance with parts or assembly? Call Quoizel customer service at 1-631-273-2700
or visit us on-line at www. quoizel. com

Assembly Instruction Sheet #IS-TF1217CBN For Style TF1217CBN

STEP 1 – Assemble Socket Assembly to Center Rod Assembly

- A. Thread the Nipple on the top of Socket Assembly (X) into the end of center Rod Assembly (I). Hand tighten until snug.

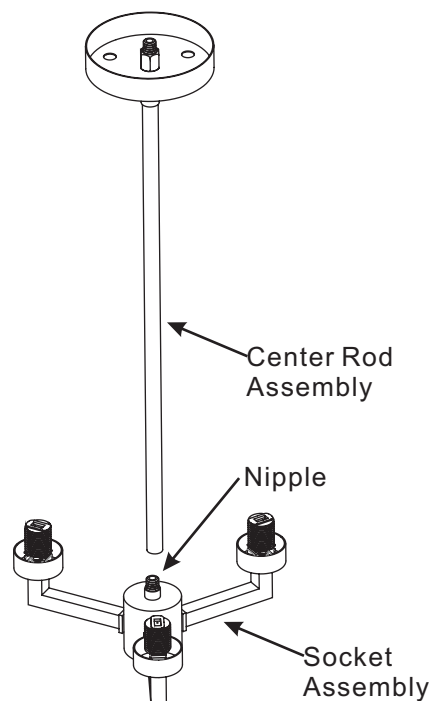

STEP 2 – Assemble Side Arm to Center Rod Assembly

- A. Pass the Nipple of Side Arm (T) through Hole of the pan.
B. Place 1/8 Lock Washer onto the Nipple of Side Arm (T). By using pliers thread the 1/8 Hex Nut (P) onto Nipple of Side Arm (T) secure the Side Arm (T). Tighten until snug.

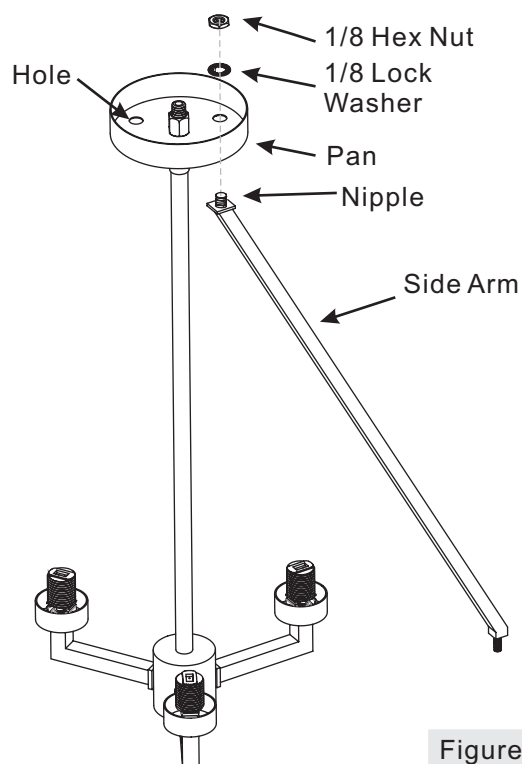

Thank you for purchasing a Quoizel product.

Need assistance with parts or assembly? Call Quoizel customer service at 1-631-273-2700
or visit us on-line at www. quoizel. com

Assembly Instruction Sheet #IS-TF1217CBN

For Style TF1217CBN

STEP 3 – Assemble Plate to Center Rod Assembly

- A. Place the Plate (S) onto the Nipple on the top of Center Rod Assembly (I), Thread the Coupling (R) onto the end of Nipple to secure the Cap (S). Hand tighten until snug.

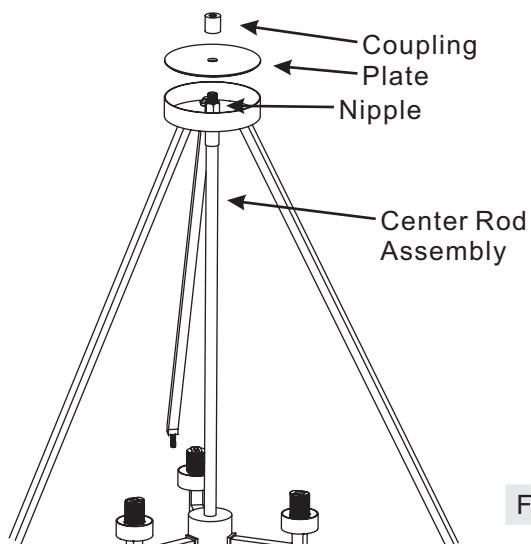

Figure 3

STEP 4 – Assemble Rods

- A. Determine the Rods (G/H) to be assembled to the Fixture Body (I) according to your hanging height.
B. Pass Supply Wires and Ground Wire through the chosen Rods (G/H) and then thread the chosen Rods (G/H) and the Fixture Body (I) together. Hand tighten until snug.

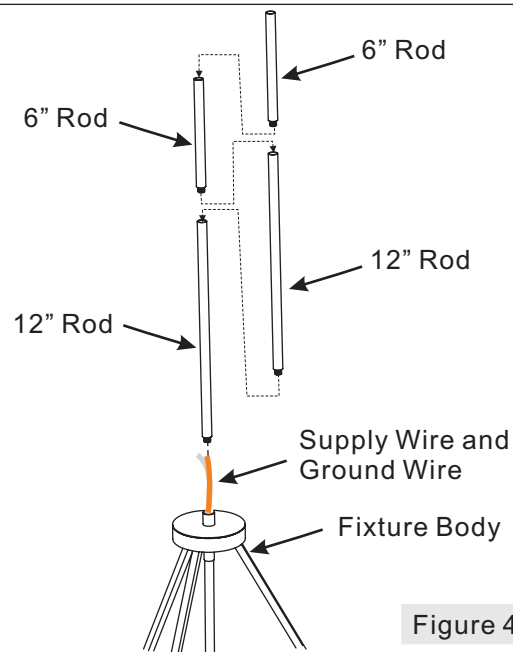

Figure 4

STEP 5 – Assemble Ceiling Canopy to Upper Rod

- A. Pass Supply Wires and Ground Wire through the Ceiling Canopy (F) and then thread the Ceiling Canopy (F) and the Upper Rod together. Hand tighten until snug.

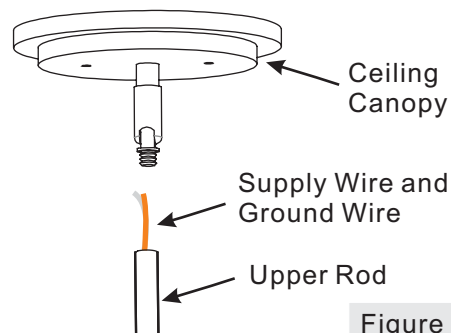

Figure 5

Thank you for purchasing a Quoizel product.

Need assistance with parts or assembly? Call Quoizel customer service at 1-631-273-2700
or visit us on-line at www.quoizel.com

Assembly Instruction Sheet #IS-TF1217CBN For Style TF1217CBN

STEP 6 – Attach Mounting Screws, Lock Washers and Hex Nuts to Crossbar

- Line up a set of holes on the Crossbar (A) and Holes on the Ceiling Canopy (F).
- Thread Mounting Screws (B) into the holes on the Crossbar (A), pass Lock Washers (C) and thread Hex Nut (D) onto the Mounting Screws (B). Hand tighten until snug.

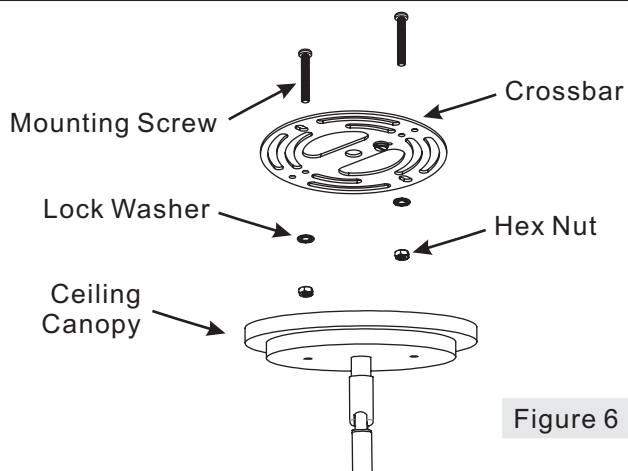

Figure 6

STEP 7 – Attach Crossbar to Outlet Box

- Attach the Crossbar (A) to Outlet Box and secure by threading Outlet Box Screws (not supplied) into the Mounting Holes on the Outlet Box. Tighten until snug.

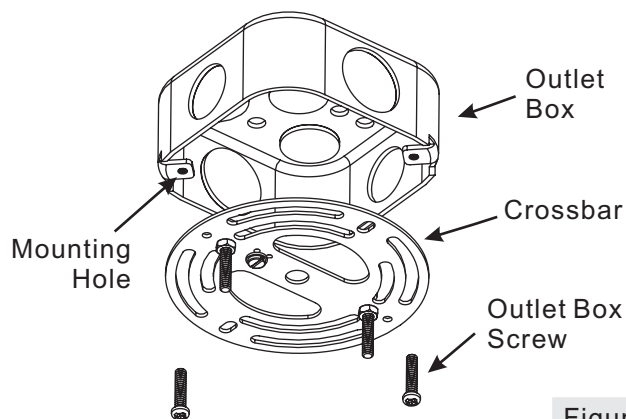

Figure 7

Thank you for purchasing a Quoizel product.

Need assistance with parts or assembly? Call Quoizel customer service at 1-631-273-2700
or visit us on-line at www.quoise.com

Assembly Instruction Sheet #IS-TF1217CBN For Style TF1217CBN

STEP 8 – Make Wire Connections

- Use standard wire connectors to make all wire connections. (Connectors are not included with fixture.) Strip and prepare wire ends according to instructions supplied with connectors.
- Connect White Supply Wire from the Outlet Box to White Wire from fixture.
- Connect Black (or Red) Supply Wire from the Outlet Box to Black Wire from fixture.
- Connect Ground Wire from the Outlet Box to Ground Wire from fixture.
- Twist connectors until wires are tightly joined together.
- Wrap each connection with approved electrical tape and carefully stuff all the connected wires into the Outlet Box.

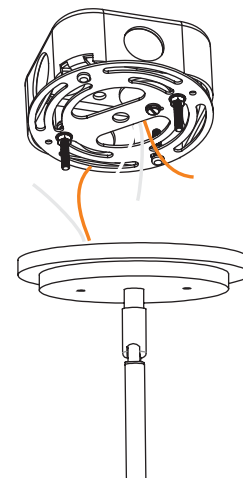

Figure 8

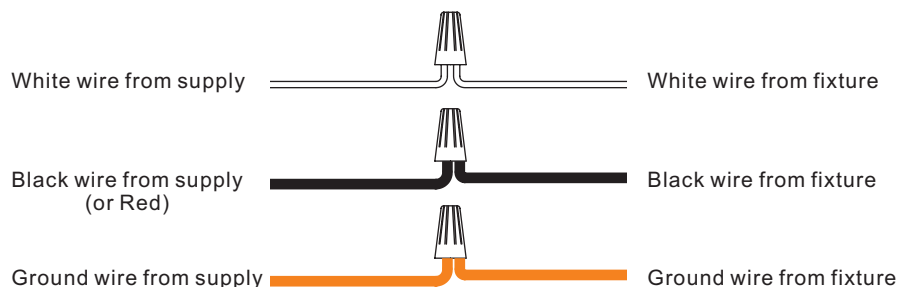

Figure 9

STEP 9 – Attach Ceiling Canopy to Mounting Screw

- Place the Ceiling Canopy (F) over the Mounting Screws (B) and secure with Mounting Balls (E). Hand tighten until snug.

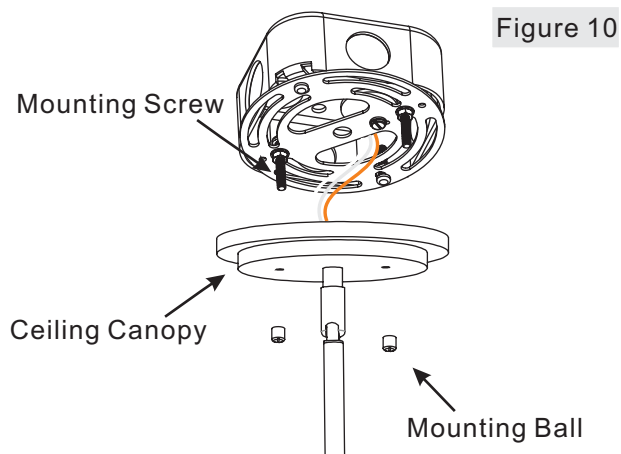

Figure 10

Thank you for purchasing a Quoizel product.

Need assistance with parts or assembly? Call Quoizel customer service at 1-631-273-2700
or visit us on-line at www.quoizel.com

Assembly Instruction Sheet #IS-TF1217CBN For Style TF1217CBN

STEP 10 – Attach Glass Shade to Socket

- A. Place the Glass Shade (O) and Steel Collar (L) over the Socket as shown. By using the Socket Collar Tool (W), Thread the Socket Collar (K) onto the Socket to secure the Glass Shade (O). Hand tighten until snug.

Figure 11

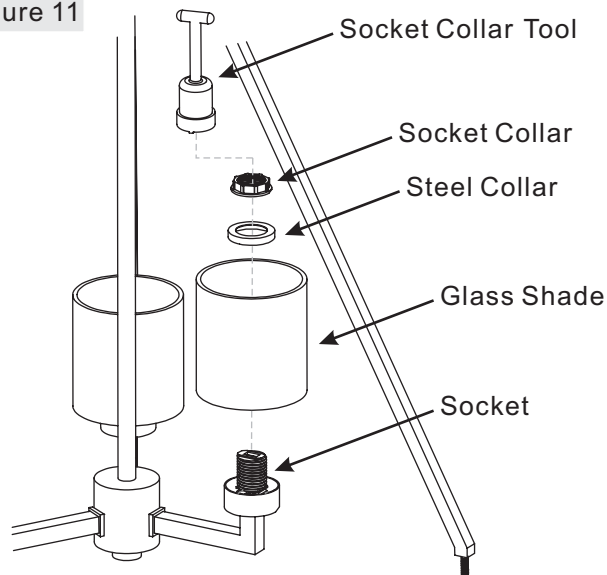

STEP 11 – Attach Tiffany Shade to Fixture Body

- A. Place the Tiffany Shade(J) into Shade Holder(N) properly.
B. Lift the Shade Holder (N) with Tiffany shade (J) upward and align rings of the Shade Holder (N) with the ends of the Side Arms (T).
C. Pass the Shade Holder (N) over the Bolt on the Side Arm (T). Thread the Mounting Ball (M) onto the Bolt on the Side Arm (T).Hand tighten until snug.

Figure 12

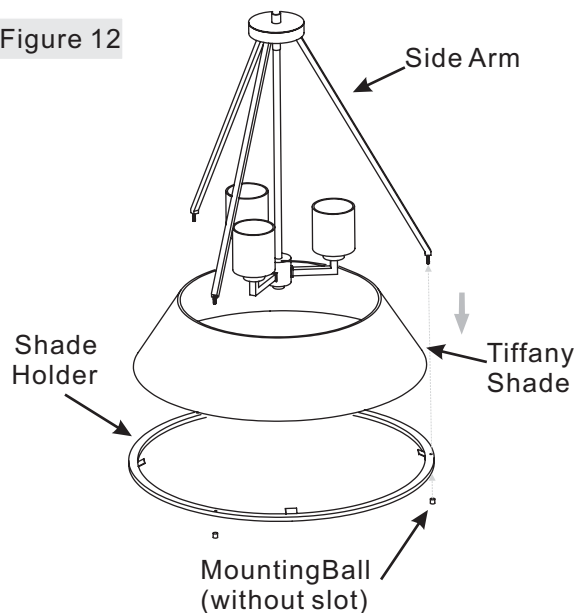

Thank you for purchasing a Quoizel product.

Need assistance with parts or assembly? Call Quoizel customer service at 1-631-273-2700
or visit us on-line at www. quoizel. com

Assembly Instruction Sheet #IS-TF1217CBN For Style TF1217CBN

STEP 12 – Install Bulb and Bulb Shield

- A. This fixture uses Frosted G9 Halogen Bulbs. Maximum 75 watts.
- B. Insert bulb and seat properly into place.
- C. Screw Bulb Shield (V) onto the Socket and hand tighten until snug.

Your pendant fixture is now assembled and ready to use.
Enjoy!

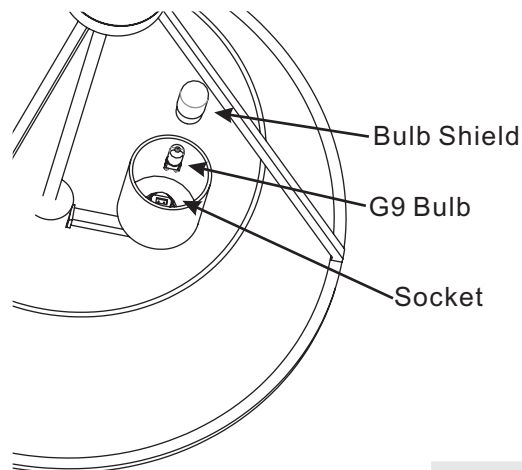

Figure 13

CAUTION FOR BULB REPLACING

- A. When replace bulb, turn off power and allow lamp to cool. For safety purpose, wear gloves and eye protection.
- B. If bulb is scratched or cracked, DO NOT use the lamp to avoid breakage during use or installation.
- C. Use only in fixtures rated for lamps wattage and voltage.
- D. Lamp operate under high pressure generating intense heat. Prevent contact with liquid and combustible materials.

Thank you for purchasing a Quoizel product.
Need assistance with parts or assembly? Call Quoizel customer service at 1-631-273-2700
or visit us on-line at www. quoizel. com