

QUOIZEL

6 CORPORATE PARKWAY
GOOSE CREEK, SC. 29445
www. quoizel. com

Quoizel, Inc.
6 Corporate Parkway
Goose Creek, SC
29445

Customer Service
Phone 631.273.2700
Fax 631.231.7102
www. quoizel. com

Assembly Instruction Sheet #IS-UPFT1820IS For Style UPFT1820IS

Tools Required: Flathead screwdriver, Phillips screwdriver, pliers, wire cutters, wire strippers, electrical tape, safety glasses.

Bulb Recommended: (3) Medium Base 100W Maximum

Estimated Assembly Time: 20-30 minutes

Preparation: Identify and inspect all parts before beginning installation. Check package content list and diagrams below to be sure all parts are present. If any parts are missing or damaged, do not attempt to assemble, install, or operate the fixture. Contact customer service for replacement parts.



Warnings and Cautions

Turn off electricity at circuit breaker or main fuse box before installation. Consult a licensed electrician if in doubt.

These instructions are provided for your safety. It is very important you read them completely before installing the fixture. We strongly recommend that a licensed, professional electrician perform the installation.

Disconnect fixture from power source before replacing bulbs. Make sure bulbs are given sufficient time to cool before removal. Do not subject glass parts to any shock while in operation or shattering may result.

Package Contents

Part	Description	Quantity
A	Crossbar	1 pc.
B	Nipple	1 pc.
C	Lock Washer	1 pc.
D	Hex Nut	1 pc.
E	Finial	1 pc.
F	Ceiling Canopy	1 pc.
G	6" Rod	4 pcs.
H	12" Rod	4 pcs.
I	Socket Assembly	1 pc.
J	Shade	1 pc.
K	Lock Screw	4 pcs.
L	Mounting Ball	1 pc.
M	Steel Collar	1 pc.
N	Diffuser	1 pc.
O	Shade Holder	1 pc.

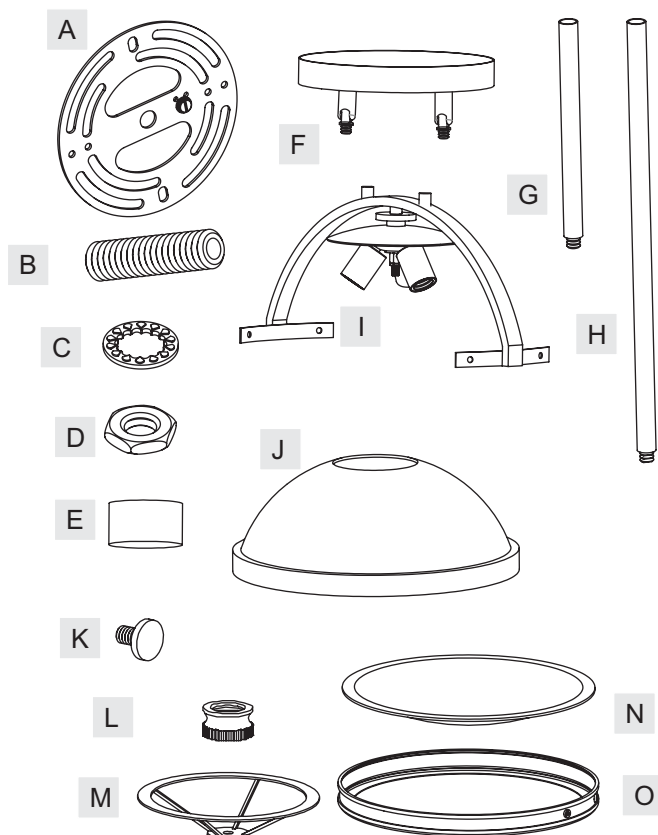

Thank you for purchasing a Quoizel product.

Need assistance with parts or assembly? Call Quoizel customer service at 1-631-273-2700
or visit us on-line at www. quoizel. com

FINISH: IMPERIAL SILVER

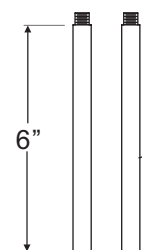

4

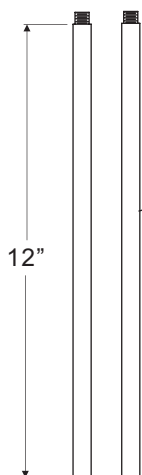

3

49"
OVERALL HEIGHT INCLUDES
(2) 6" AND 12" RODS

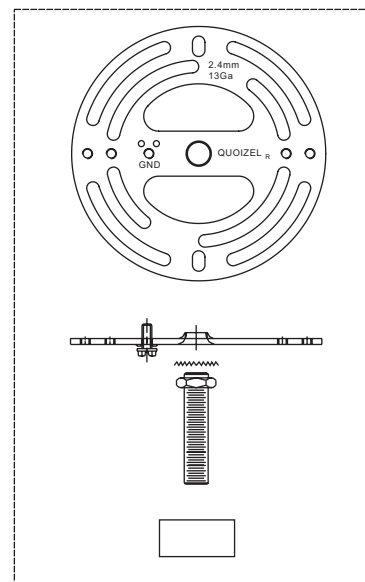
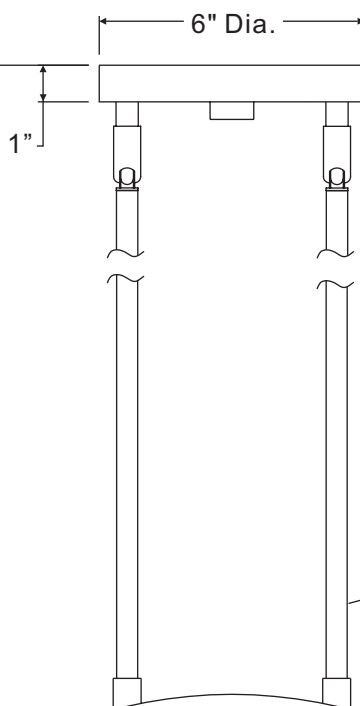

(3)100W A19
Medium Base Bulb
(Not Supplied)

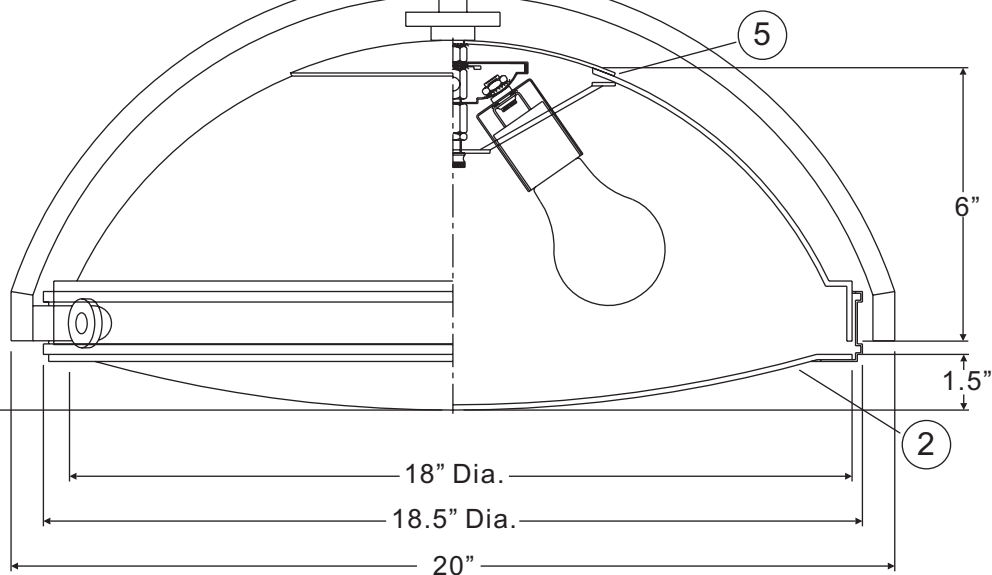

NOTE: ALL DIMENSIONS ARE ROUNDED UP TO THE NEAREST 1/2"

NO.	PART NUMBER	REPLACEMENT PART DESCRIPTION	REQ.
1	11820ISUPFT	BASE IMPERIAL SILVER UPFT1820IS	1
2	G3209DI	DIFFUSER SANDBLAST INSIDE 18"D	1
3	9012EXIR	ROD EXT IRON AGE 12"L X 0.5"D	4
4	9006EXIR	ROD EXT IRON AGE 6"L X 0.5"D	4
5	G3208SH	SHADE OPAL ETCHED GLASS 18"D	1

Assembly Instruction Sheet #IS-UPFT1820IS For Style UPFT1820IS

STEP 1 – Assemble Rods

- Determine the Rods (G/H) to be assembled according to your hanging height.
- Pass Supply Wires and Ground Wire through the chosen Rods (G/H). Thread the chosen Rods (G/H) and the Socket Assembly (I) together. Hand tighten until snug.

Figure 1

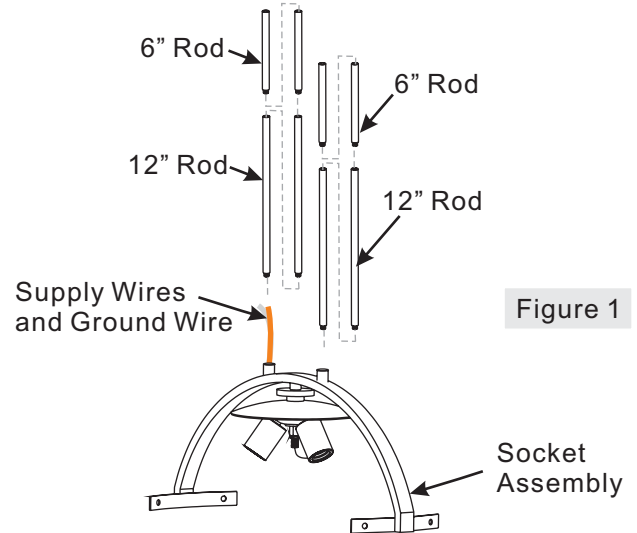
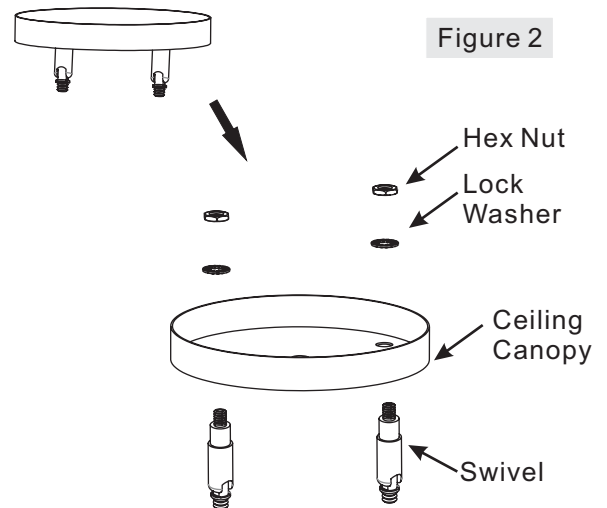

Figure 1

STEP 2 – Disassemble Ceiling Canopy

- Disassemble every single parts pre-assembled on the Ceiling Canopy as shown in the illustration.

Figure 2



Thank you for purchasing a Quoizel product.

Need assistance with parts or assembly? Call Quoizel customer service at 1-631-273-2700
or visit us on-line at www.quoizel.com

Assembly Instruction Sheet #IS-UPFT1820IS

For Style UPFT1820IS

STEP 3 – Assemble Ceiling Canopy to Upper Rod

- Pass Supply Wires and Ground Wire through the Swivel,, Ceiling Canopy, Lock Washer and Hex Nuts.
- Screw the Swivels into the top end of the Upper Rod. Please be sure the directions of two Swivels are the same before hand tighten until snug. This allows the lamp to adjust angles after assembly. (Refer to Figure 3)
- Pass the Ceiling Canopy and Big Lock Washers over the top end of the Swivels. Secure by threading Hex Nuts onto Swivels. Tighten until snug.

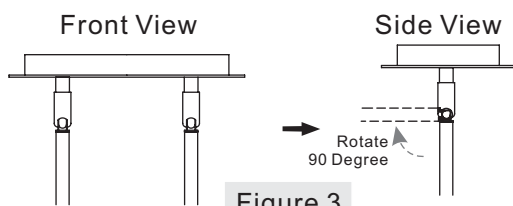

Figure 3

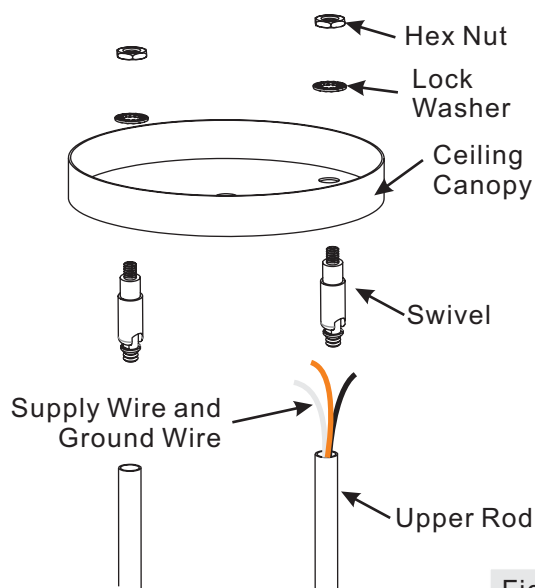
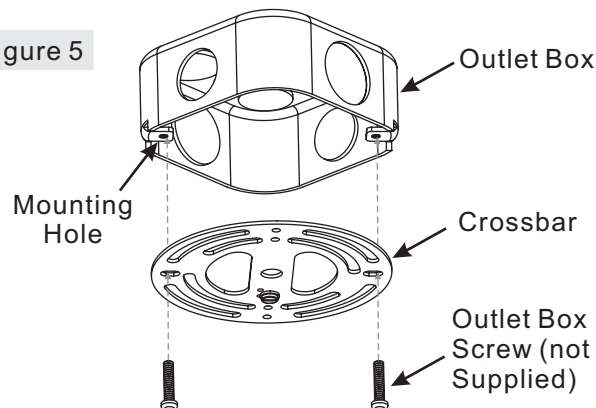

Figure 4

STEP 4 – Attach Crossbar to Outlet Box

- Secure the Crossbar (A) to the outlet box with outlet box screws (not supplied). Tighten until snug.

Figure 5



STEP 5 – Attach Nipple to Crossbar

- Thread one Hex Nut (D) onto the top end of the Nipple (B).
- Place one Lock Washer (C) over the top end of the Nipple (B) and then thread the Nipple (B) into the center lock hole of the Crossbar (A).
- Using pliers, thread the hex Nut (D) against the Crossbar (A) and hand tighten until snug.

Figure 6

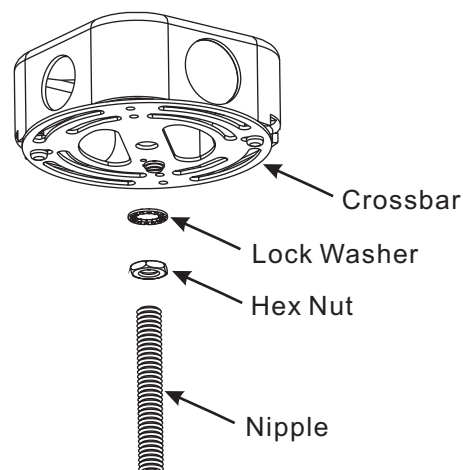

Thank you for purchasing a Quoizel product.

Need assistance with parts or assembly? Call Quoizel customer service at 1-631-273-2700
or visit us on-line at www. quozel. com

Assembly Instruction Sheet #IS-UPFT1820IS For Style UPFT1820IS

STEP 6 – Make Wire Connections

- Use standard wire connectors to make all wire connections. (Connectors are not included with fixture.) Strip and prepare wire ends according to instructions supplied with connectors.
- Connect White Supply Wire from the Outlet Box to White Wire from fixture.
- Connect Black (or Red) Supply Wire from the Outlet Box to Black Wire from fixture.
- Connect Ground Wire from the Outlet Box to Ground Wire from fixture.
- Twist connectors until wires are tightly joined together.
- Wrap each connection with approved electrical tape and carefully stuff all the connected wires into the Outlet Box.

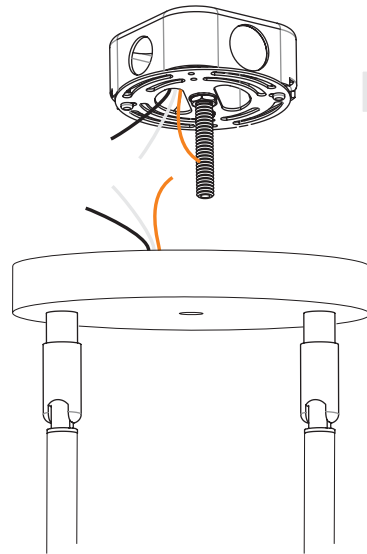

Figure 8

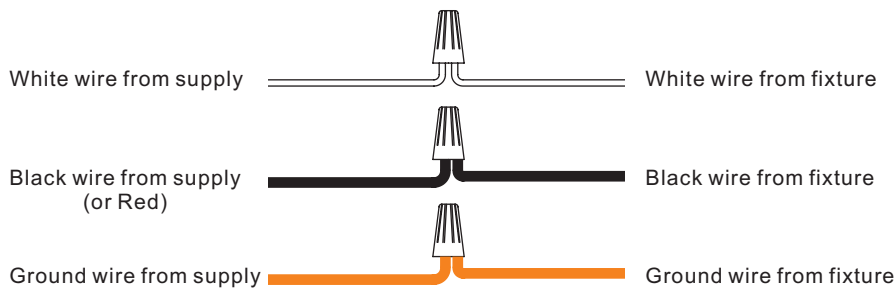

Figure 7

STEP 7 – Attach Ceiling Canopy

- Place the Ceiling Canopy (I) over the end of the Nipple (B). Secure by threading the Finial (E) onto the Nipple (B). Hand tighten until snug.

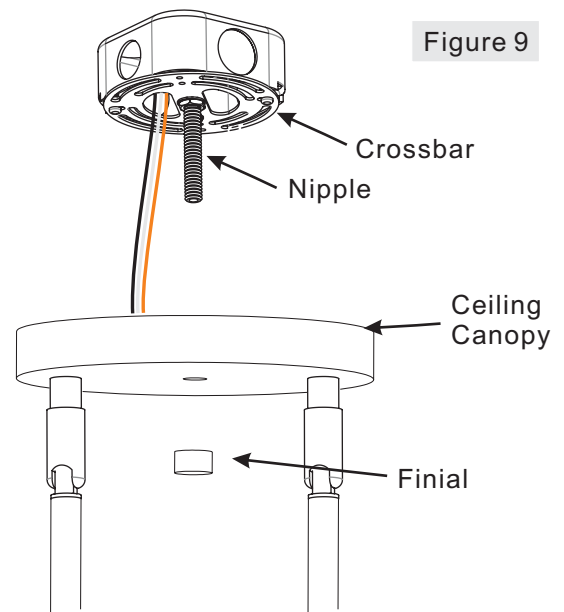

Figure 9

Thank you for purchasing a Quoizel product.

Need assistance with parts or assembly? Call Quoizel customer service at 1-631-273-2700
or visit us on-line at www. quozel. com

Assembly Instruction Sheet #IS-UPFT1820IS

For Style UPFT1820IS

STEP 8 – Attach Shade to Socket

- A. Place the Shade (K) and the Steel Collar (M) over the Nipple as shown. Secure by threading the Mounting Ball (L) onto the Nipple. Hand tighten until snug.

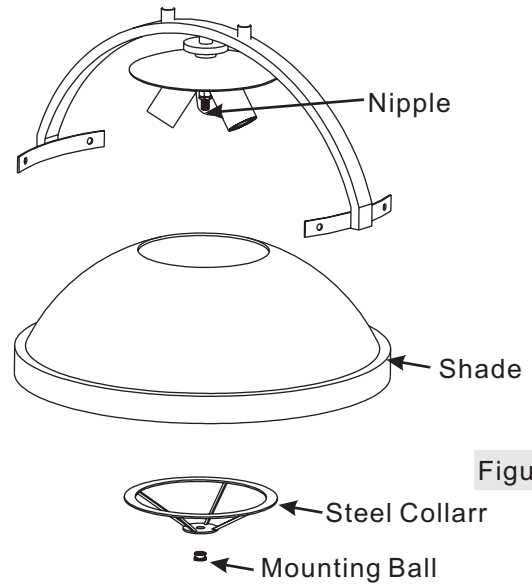

Figure 10

STEP 9 – Install Bulb

- A. This fixture uses standard bulb with a standard screw base. Maximum 100 watts.
B. Insert bulb and screw properly into place.

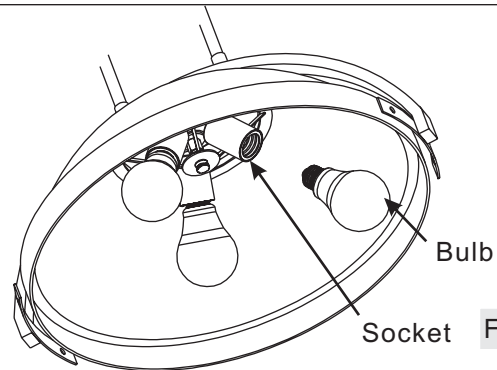

Figure 11

STEP 10 – Attach Glass to Socket Assembly

- A. Place Diffuser (N) inside Shade Holder (O).
B. Lift the Shade Holder (O) with Diffuser (N) upward, over the bottom edge of the Shade (J).
C. Align mounting holes on the Shade Holder (O) with the Thick Tabs on the ends of the Arms. Secure them together by threading Lock Screws into mounting holes on the Shade Holder. Hand tighten until snug.

Your lamp mini pendant fixture is now assembled and ready to use. Enjoy!

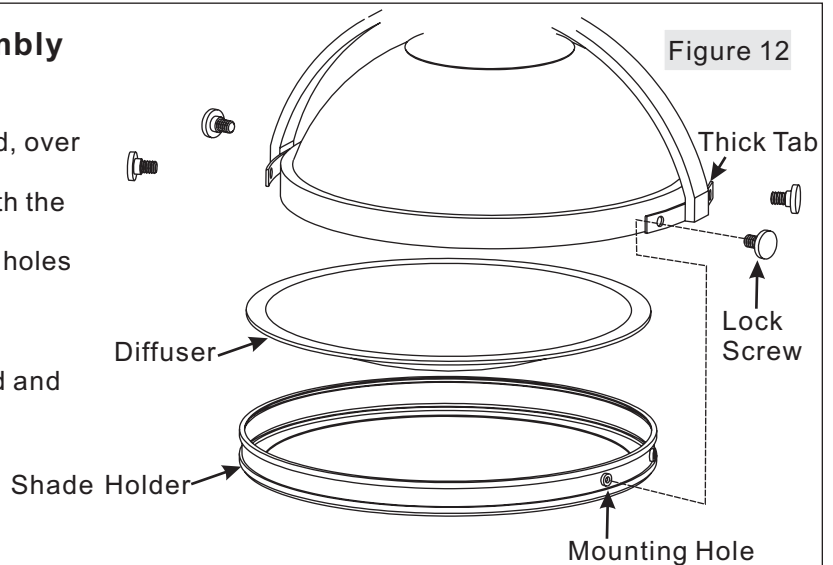

Figure 12

Thank you for purchasing a Quoizel product.

Need assistance with parts or assembly? Call Quoizel customer service at 1-631-273-2700
or visit us on-line at www. quoizel. com