

ASSEMBLY INSTRUCTIONS FOR YOUR ALBERT TABLE LAMP

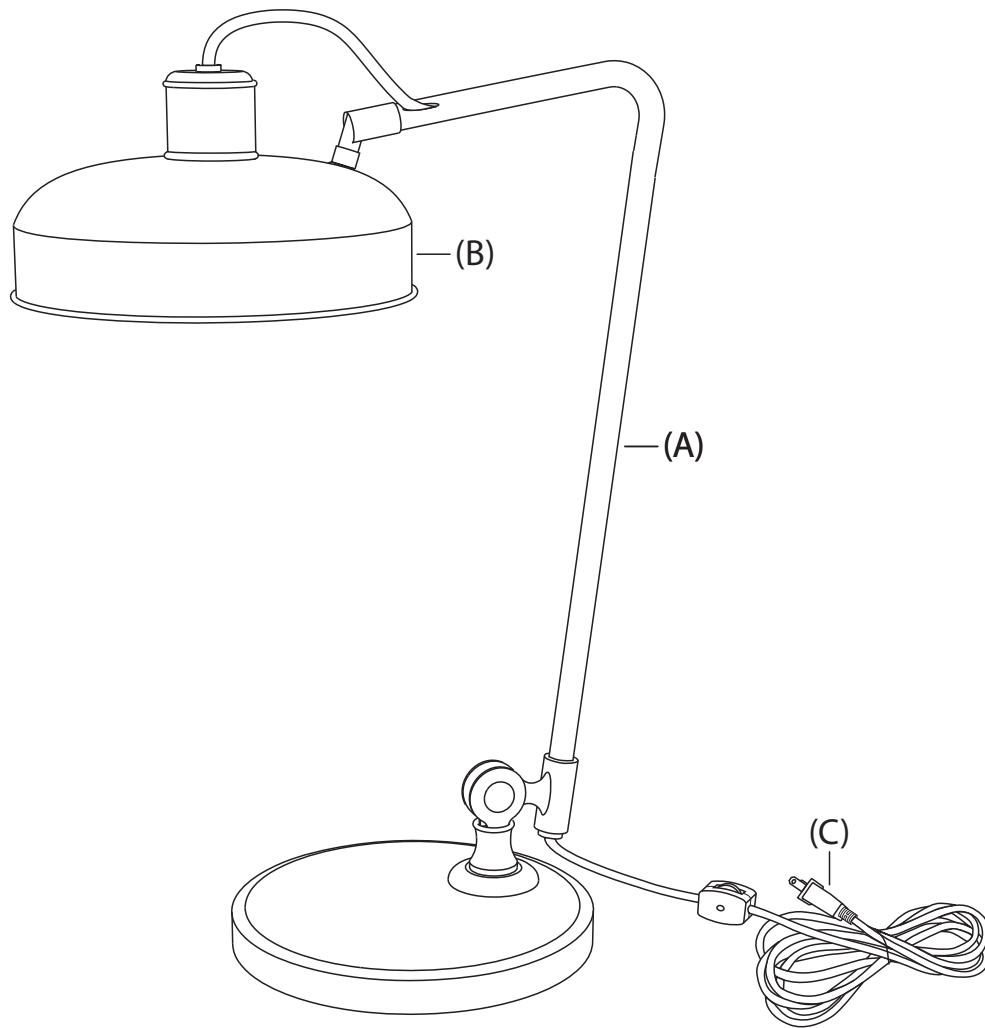

IMPORTANT SAFETY INSTRUCTIONS:

- * This lamp has a polarized plug (one blade is wider than the other) as a feature to reduce the risk of electric shock. This plug will fit in a polarized outlet only one way. If it does not fit fully in the outlet, reverse the plug. If it still does not fit, contact a qualified electrician. Do NOT alter the plug.
- * Do not use with an extension cord unless the plug from the lamp can be fully inserted into the extension cord receptical.
- * Switch power off and remove plug from the wall outlet before replacing the bulb.

ASSEMBLY INSTRUCTIONS:

NOTE: Do not connect electricity until lamp is fully assembled.

1. Unpack lamp; remove and discard all packing materials.
2. Place base on a level surface.
3. Carefully move arm (A) into desired position.
4. Carefully move shade (B) into desired position.
5. Insert one 60W Max. B10, medium base bulb into the socket.
6. Insert polarized plug (C) into wall outlet.

** To clean, wipe lamp with a soft cloth. Do not use any chemical or abrasive cleaners as they may damage the finish. **