



ASSEMBLY AND INSTALLATION

INSTRUCTION

Please read carefully and save this instruction, as you may need them at a later date.

CAUTION

Turn off the main power at the circuit breaker before installing the fixture, in order to prevent possible shock. If you are unfamiliar with proper electrical wiring connections, please consult of a qualified electrician before installing

Installing Step:

Remove the fixture and the mounting package from the box and make sure that no parts missing in the box.

1. Open the folded arms (3) and adjust them evenly.
2. Thread the Middle Tube (2) onto the Coupling (1).
3. Attach the Cover (5) and screw with the Loop (6) onto the Nipple (4).
4. Screw the Nipple (9) into the Connector (7) with Hex nut (8).
5. Attach Tube (10), Tube cover (11), Cover (12) onto the Nipple (9), then screw with Hex nut (13).
6. Install bulbs: (Bulbs not including in the package)
(Please don't exceed the maximum capacity that recommended on the Sockets)
7. Attach shade to the arms (3), then screw them together with Ball nuts (15) and (17).
8. Attach flat glass (18), plastics washer (19) and metal washer (20), then screw with Hex nut (21).
9. Attach the Bottom cover (22) onto the Nipple (9), then screw with the Finial (23).

INSTALLATION IS NOW COMPLETED.

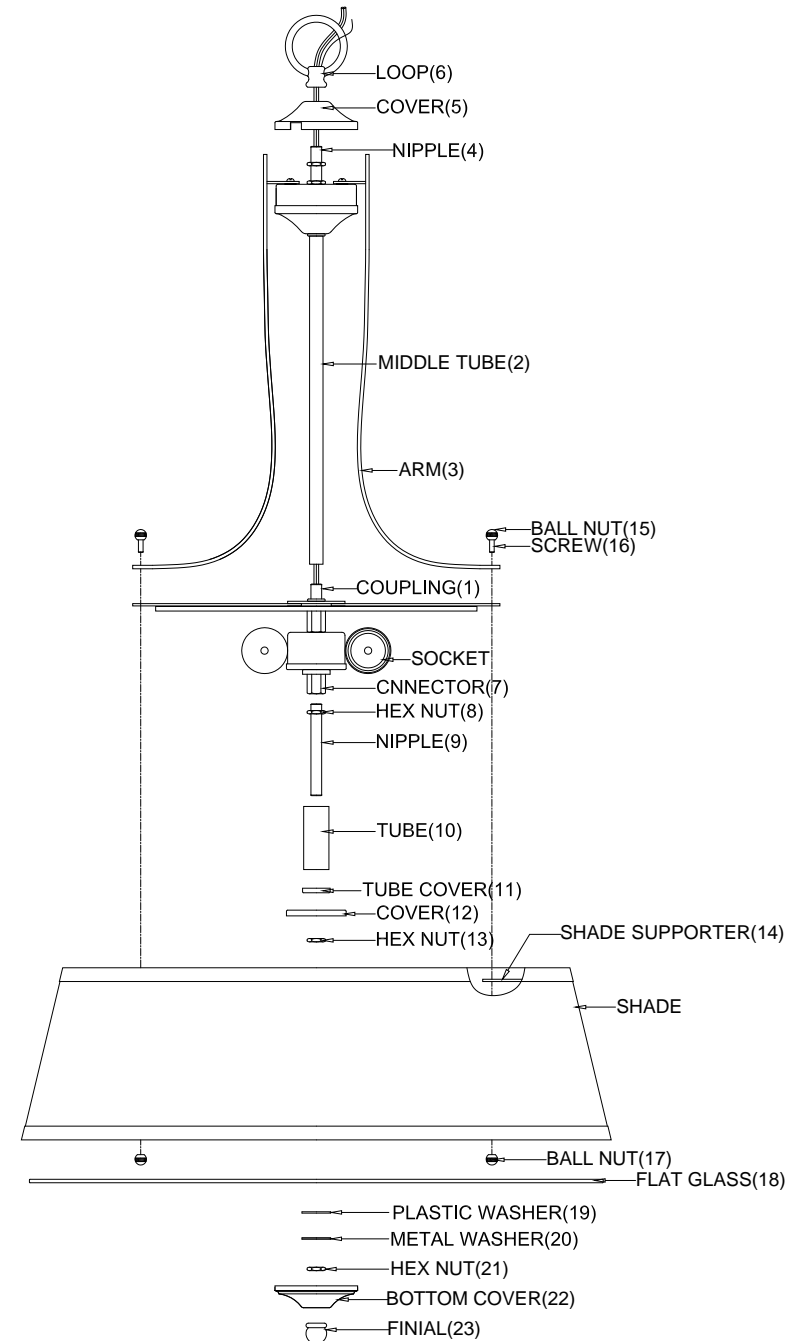

7P-2174-3-129