

Instructions for electrician STEPS 2 - 10

WARNING:

2

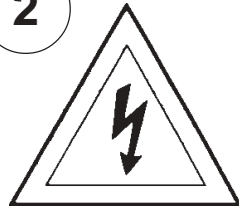

Electrical Danger

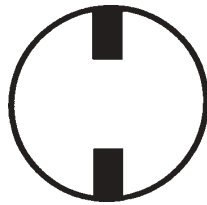

Turn Power Off

All electrical components must be installed by a licensed electrician in accordance with the National Electric Code and the appropriate local electrical codes.

Turn arms to line up holes in arms with dimple in plate. Tighten lock washer and nut to secure arms in place.

5

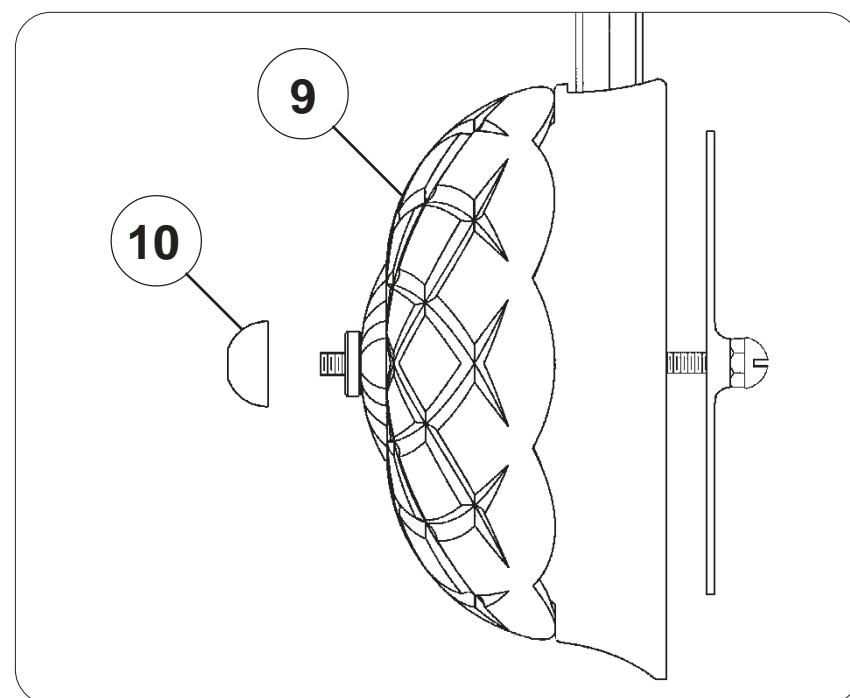
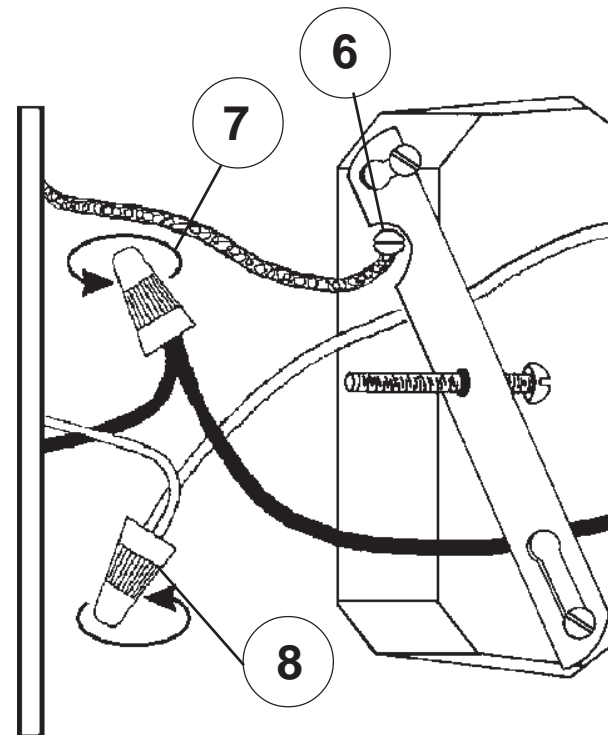
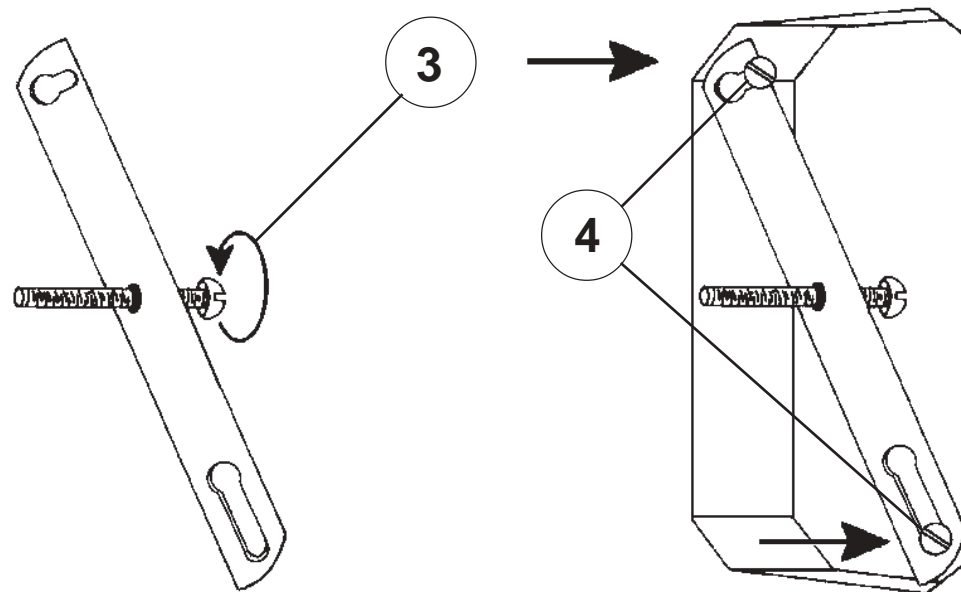
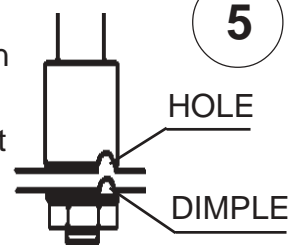

CHANDELIER 1300 TRIM DIAGRAM



THIS DESIGN IS THE PROPRIETARY TRADE DRESS/TRADEMARK OF SCHONBEK WORLDWIDE LIGHTING INC.

3 Lights
Diameter: 14-1/2"
Body Length: 19-1/2"
Extension: 7"
Hanging Weight: 5 pounds

SCHONBEK®

See diagram on back page
Follow steps in exact order
Save this trim diagram for future reference

1

IMPORTANT

Person who opens carton should record the following information for future service.

CODE # _____ Four-digit number on outside of carton.
PACKER # _____ See crystal package label.
ORDER # _____ See crystal package label.

SCHONBEK IS A WORLD LEADER IN CHANDELIER DESIGN. PATENTS INCLUDE:
#D5,460,269

Instructions for crystal trimming
STEPS 11 - 17



11

You will need 3 - C10
25 Watts Recommended
60 Watts Max

Install bulbs and be
sure to test fixture
BEFORE trimming.

VIEW "A"

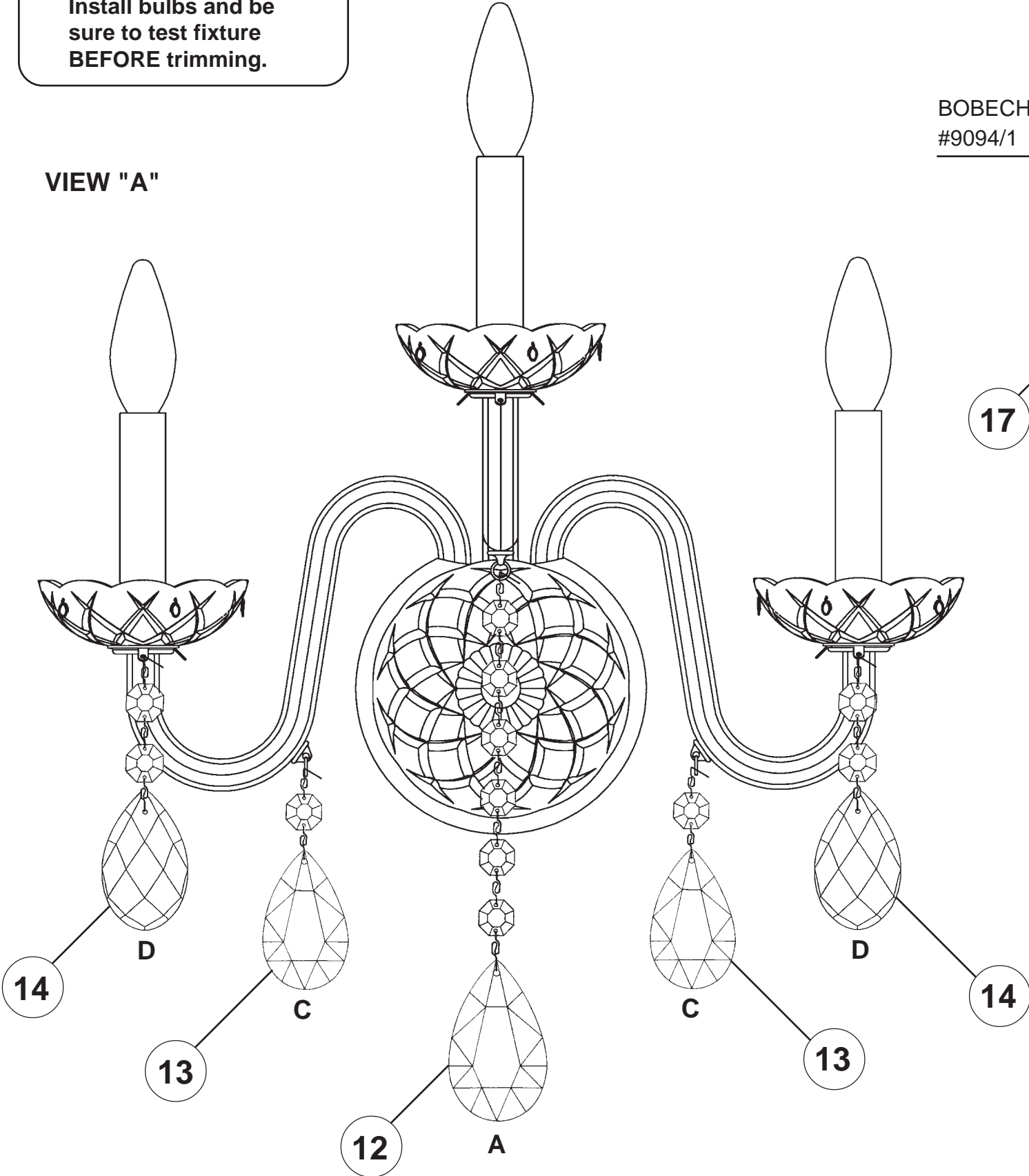

VIEW "B"

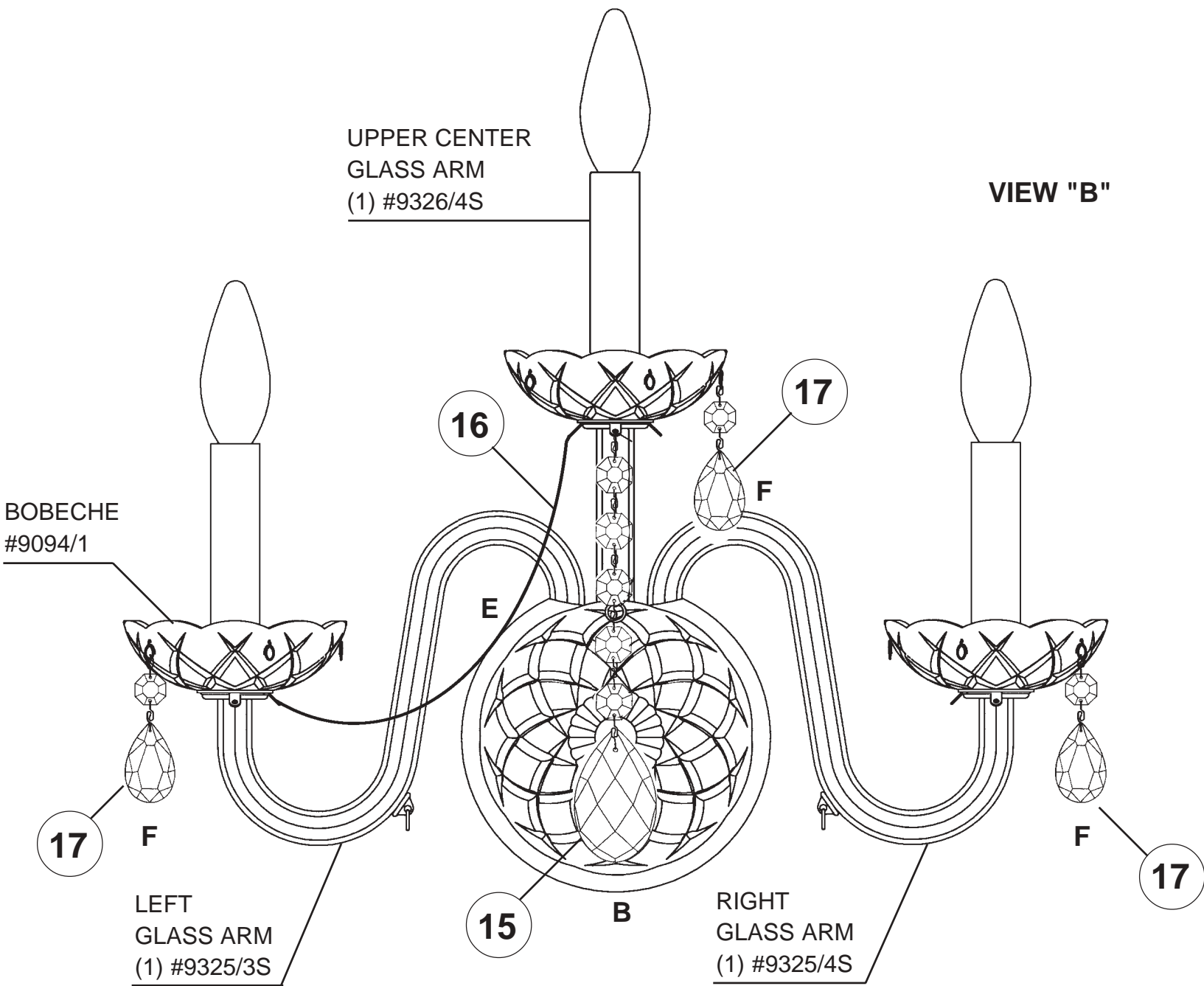

CAUTION: Glass parts are fragile.
To avoid breakage use care when
assembling or cleaning.

**WHEN ORDERING REPLACEMENT
ARM(S):**

- 1 Give arm number from trim diagram
- 1 Give color code from the arm itself

