

SCHONBEK®

CHANDELIER 2785-____ TRIM DIAGRAM (Finish Option)

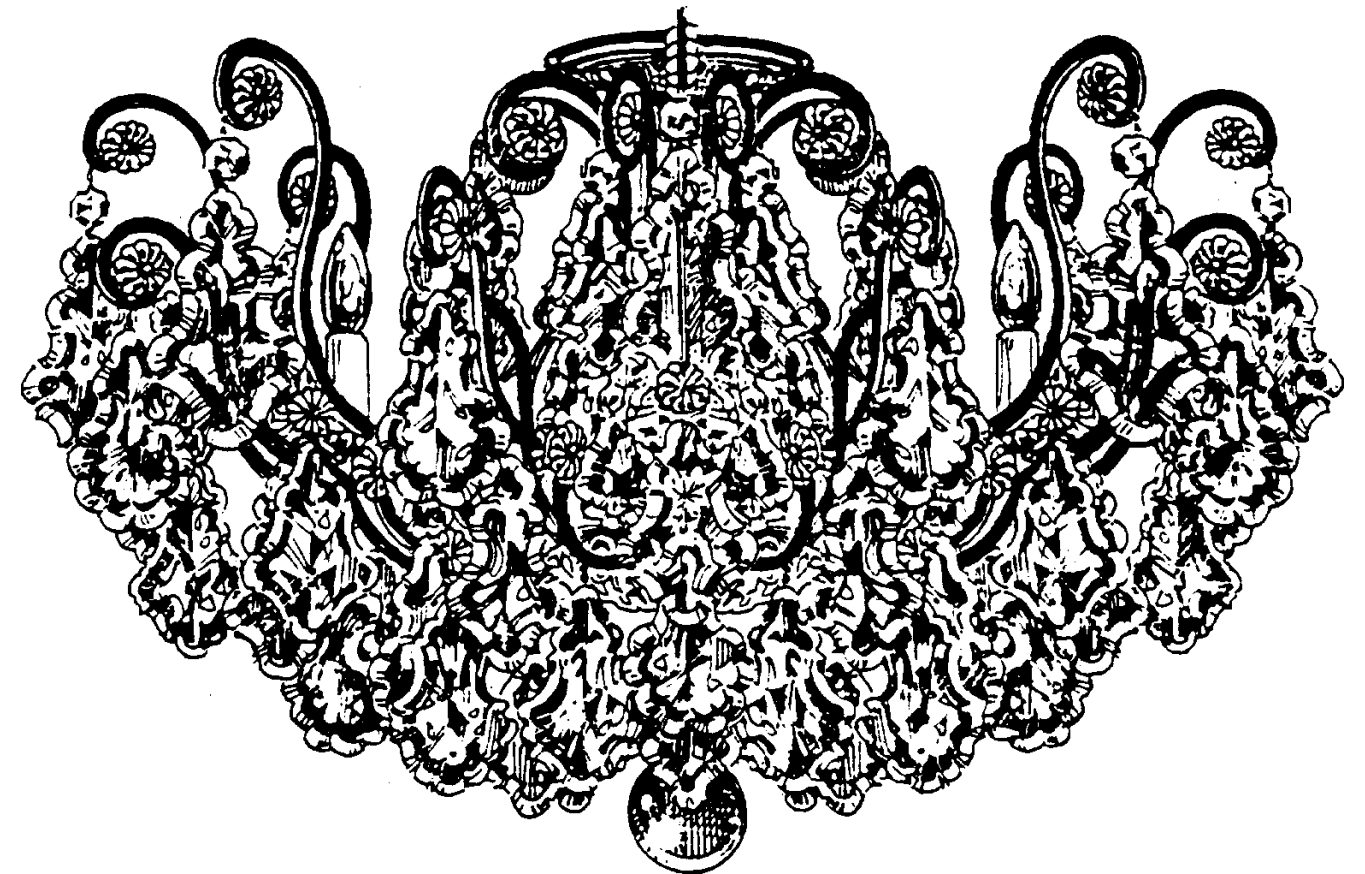

THIS DESIGN IS THE PROPRIETARY
TRADE DRESS/TRADEMARK OF
SCHONBEK WORLDWIDE LIGHTING INC.

8 Lights
Diameter: 26"
Body Length: 18"
Hanging Weight: 21 lbs.

SCHONBEK®

**Follow steps in exact order
Save this trim diagram for future reference**

1

IMPORTANT
*Please record the following
information for future service.*

CODE # _____ Four-digit number on outside of carton.
PACKER # _____ See crystal package label.
ORDER # _____ See crystal package label.

Instructions for electrician
STEPS 2 - 10

2

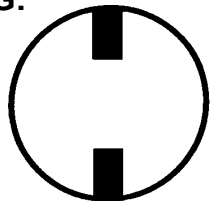
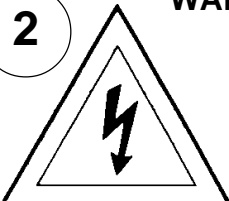

WARNING:

Electrical Danger Turn Power Off

All electrical components must be installed by a licensed electrician in accordance with the National Electric Code and the appropriate local electrical codes.

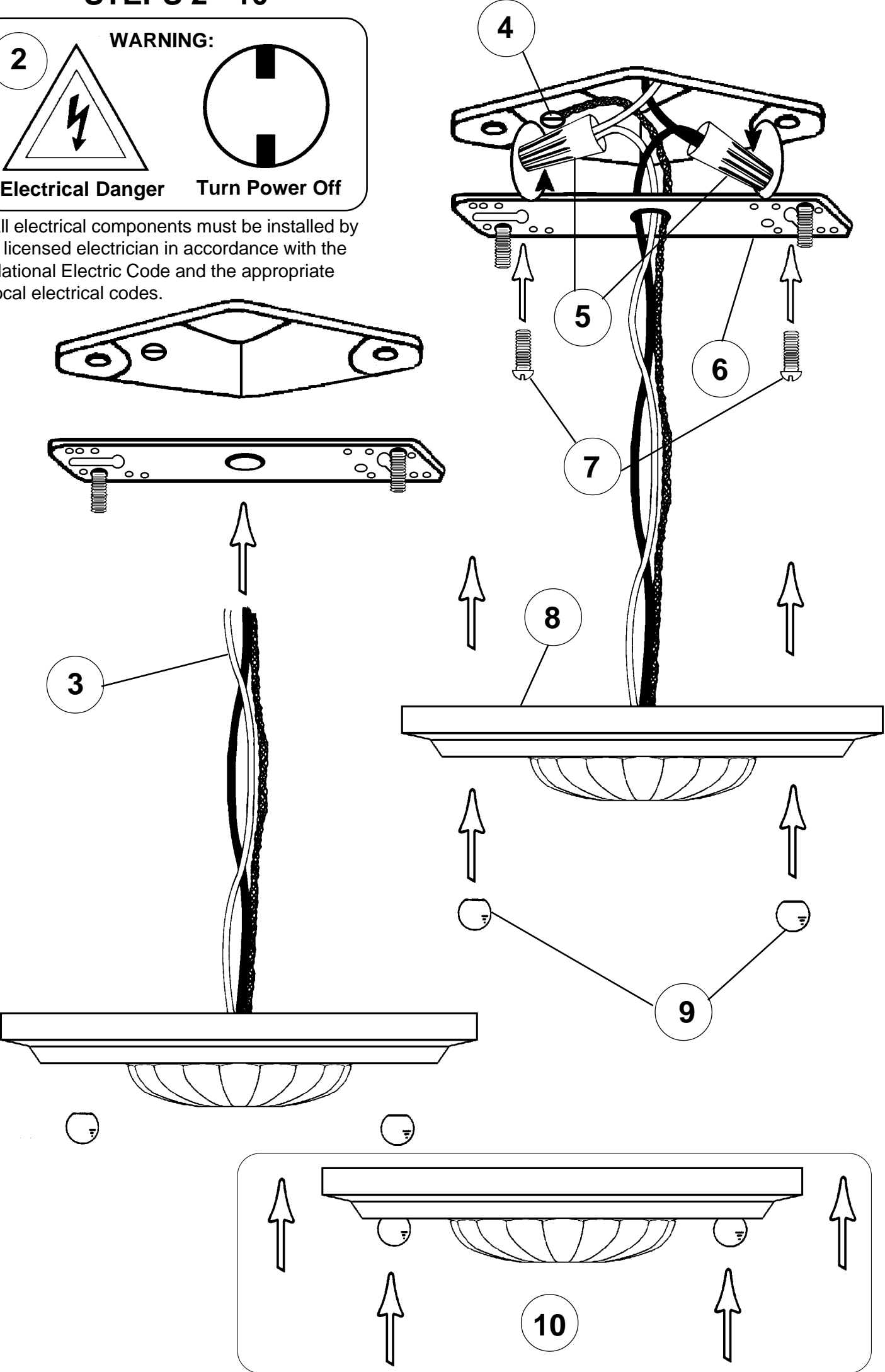

SET #1

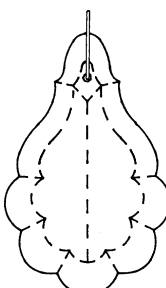
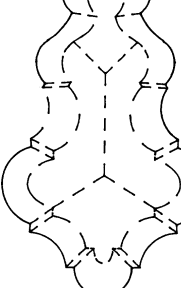
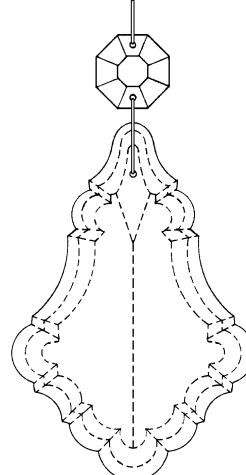
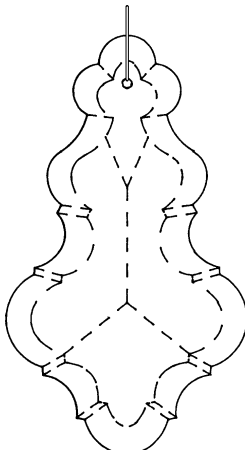
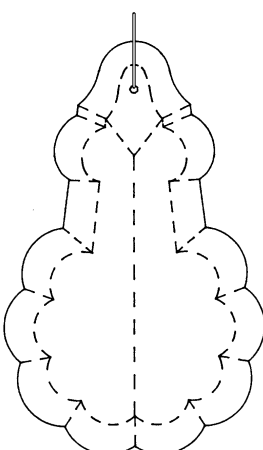
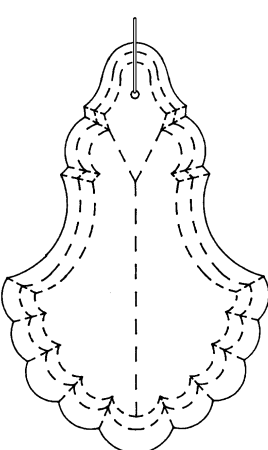
					
N5031	N5000	N5028	N5003	N5013	N5033
2-1/2"	3-1/2"	3-1/2"	4"	4"	4"
63mm	89mm	89mm	102mm	102mm	102mm

SET #2

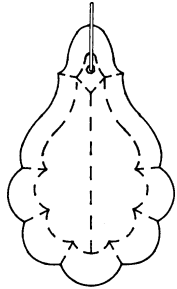
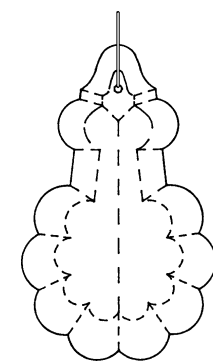
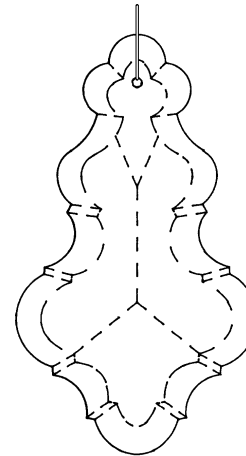
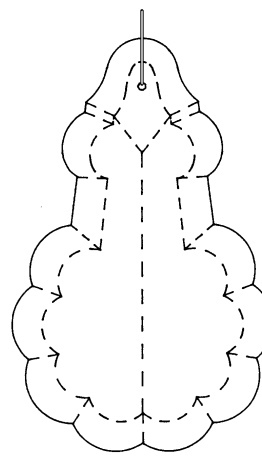
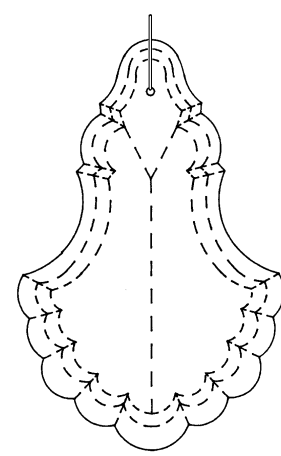
				
N5013	N5020	N5003	N5013	N5033
2-1/2"	3"	4"	4"	4"
63mm	76mm	102mm	102mm	102mm

SET #3

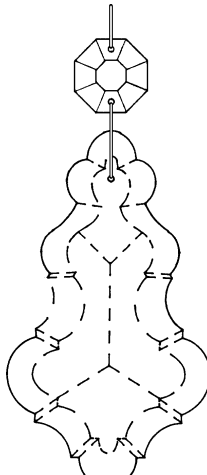
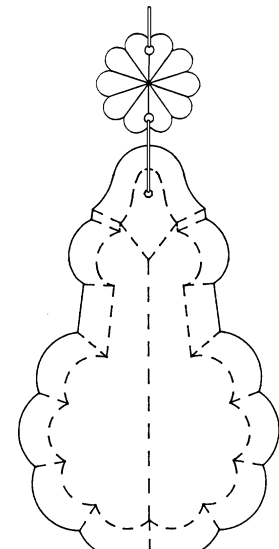
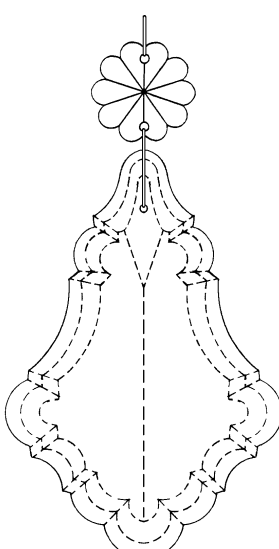
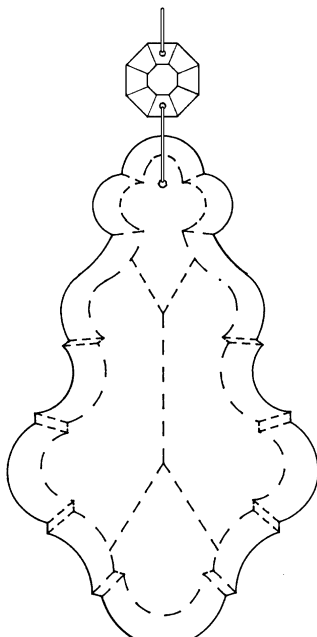
			
N5001	N5012	N5029	N5004
3-1/2"	4"	4"	5"
89mm	102mm	100mm	127mm

Crystal Set #3 in Black

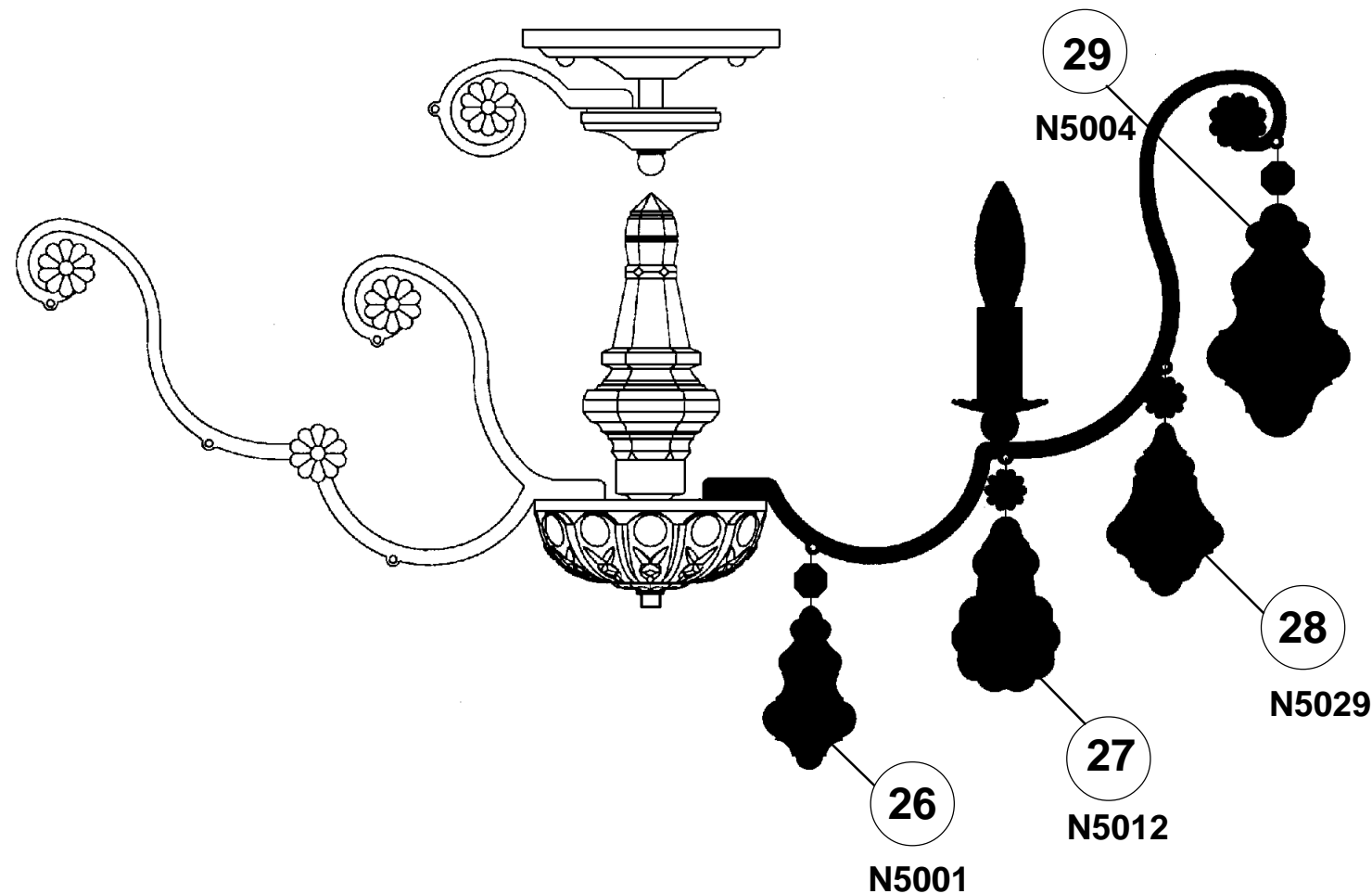

For easy removal of crystal from bubble pack, please cut along pouches on the inside of the seam. Gently remove crystal from the side of the pouch.

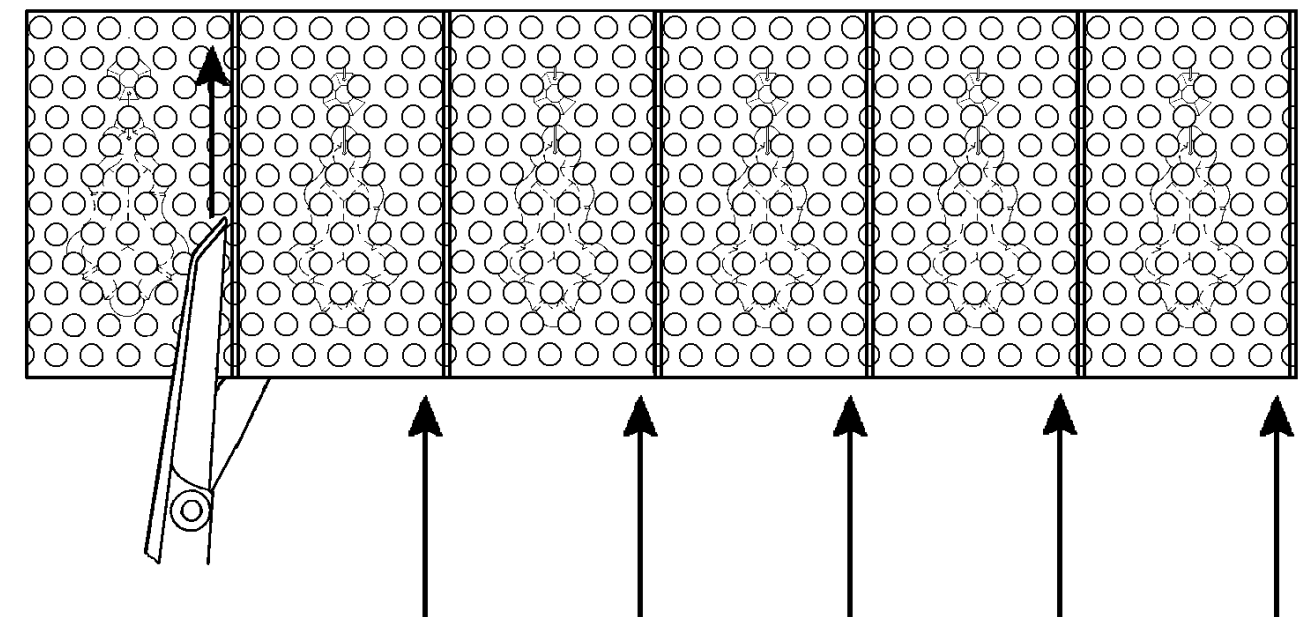

NOTE: Work on one crystal set at a time. Follow the black line from top to bottom according to the numbered steps on the trim diagram.

Instructions for crystal trimming
STEPS 11 - 29

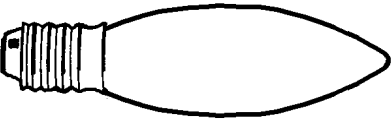

- 11
8 - C10
25 Watts Max
40 Watts Recommend
MIN 90°C SUPPLY
CONDUCTORS

Crystal Set #1 in Black

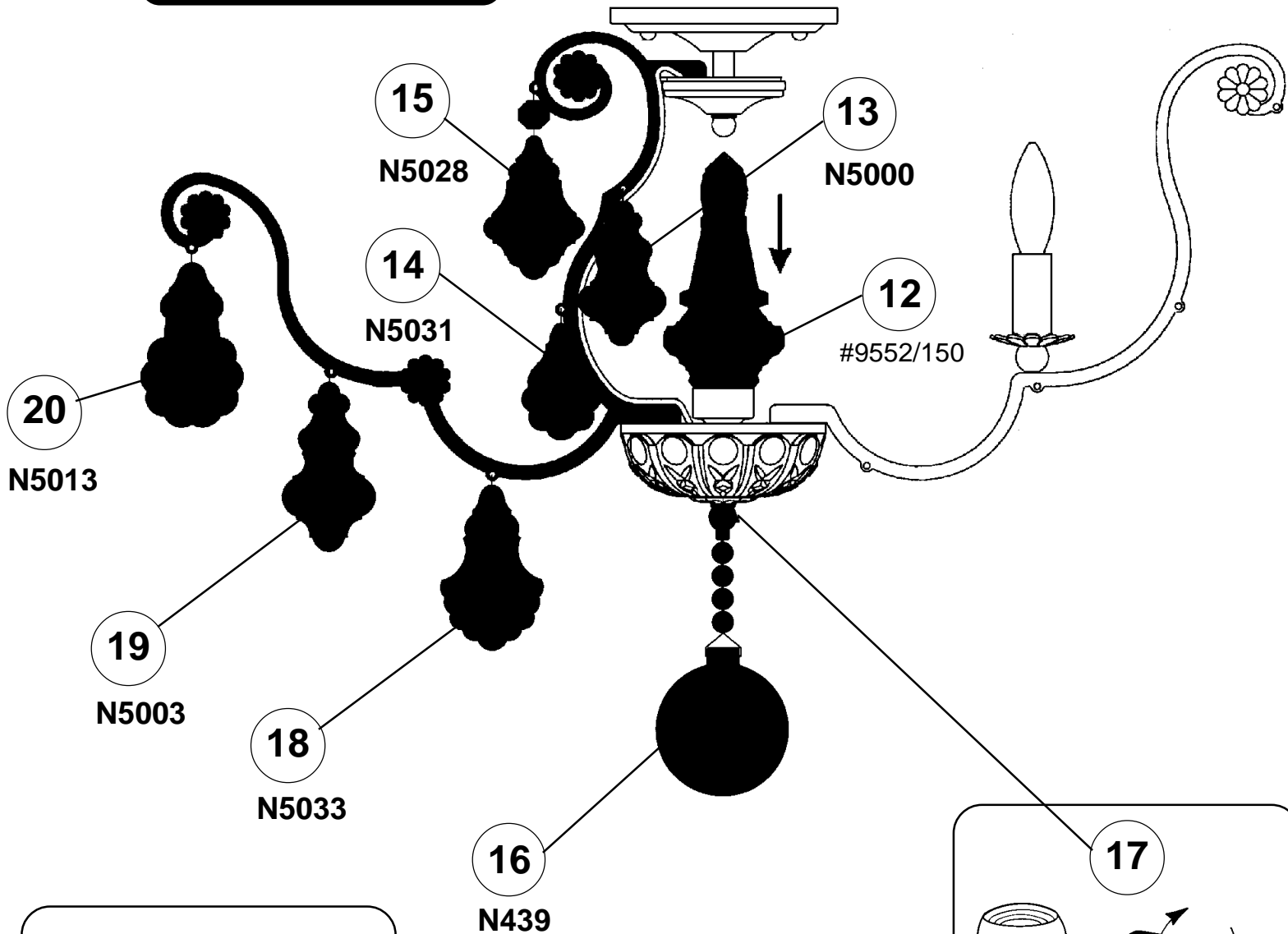

FIXTURE INCLUDES:
Hanger Hardware
Trim
Frame
DOES NOT INCLUDE:
C10 - Light Bulbs

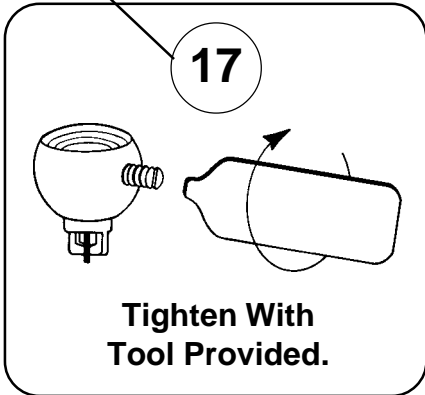

Crystal Set #2 in Black

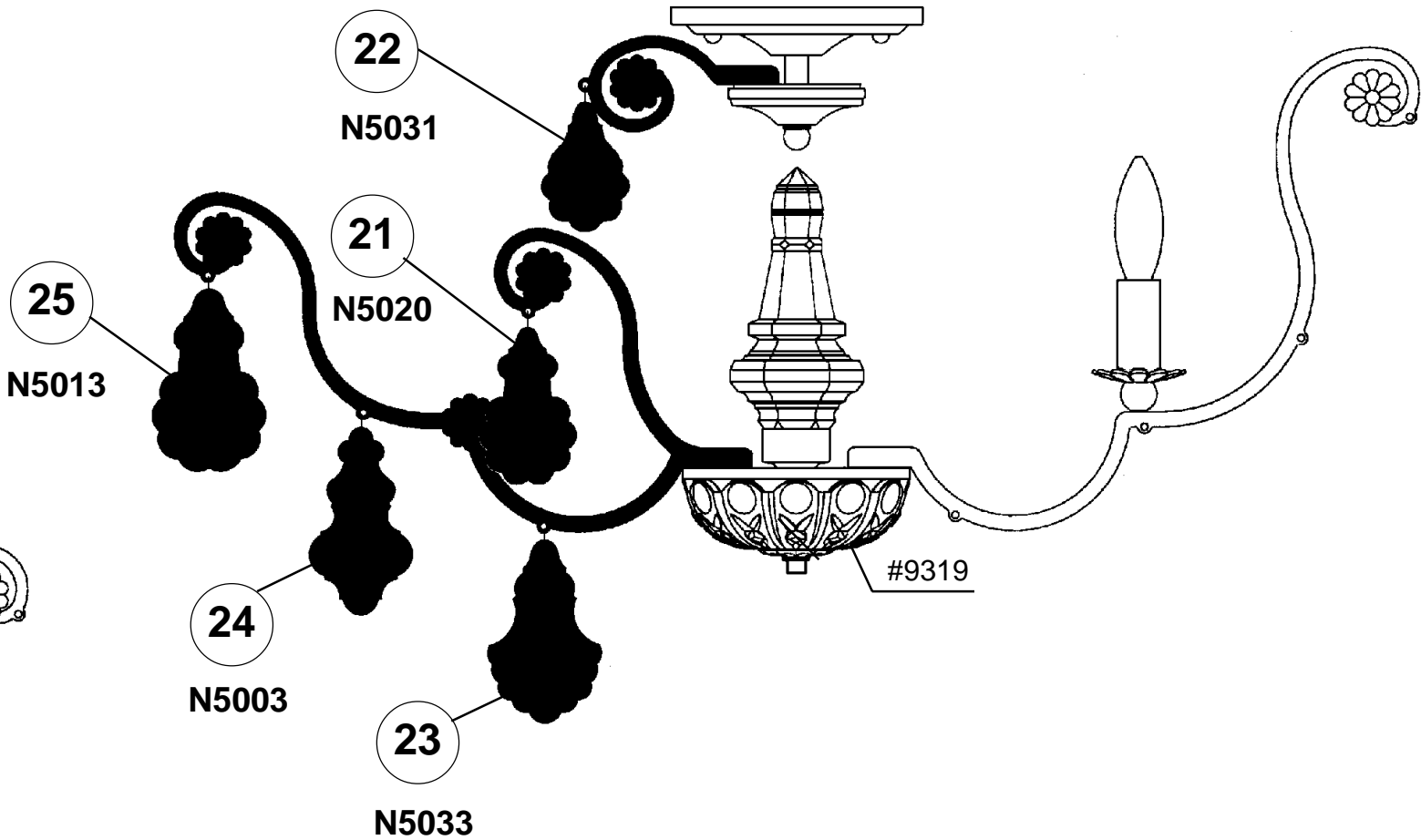

SPARE PARTS KIT
PROVIDED.

