

Instructions for electrician STEPS 2 - 18

WARNING:

2

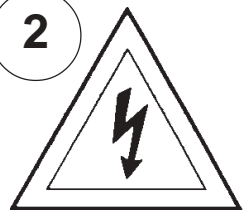

Electrical Danger

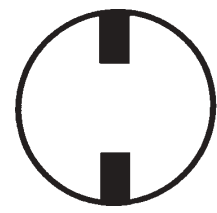

Turn Power Off

All electrical components must be installed by a licensed electrician in accordance with the National Electric Code and the appropriate local electrical codes.

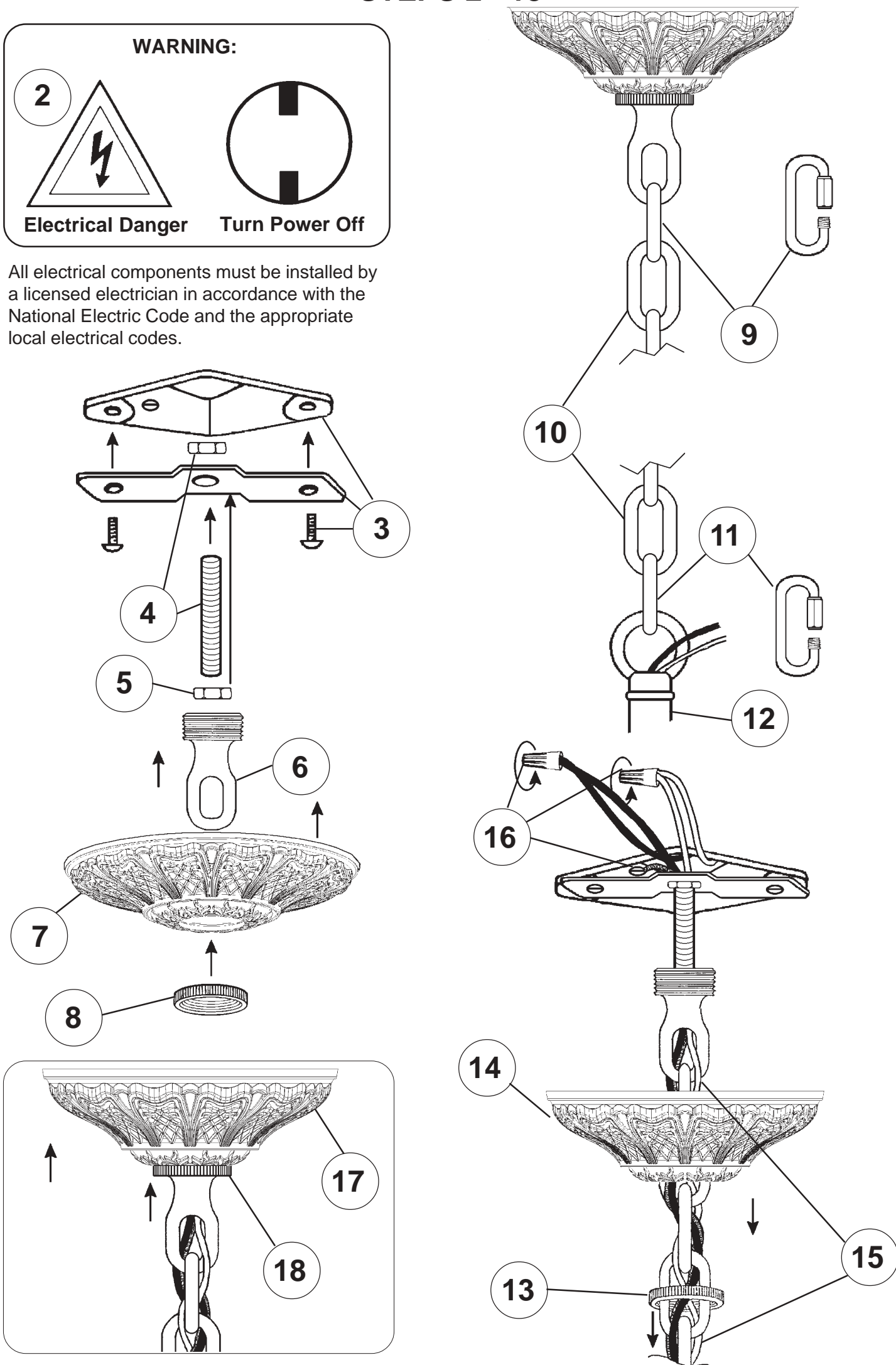

CHANDELIER 6959-

TRIM DIAGRAM

(Finish Option) (Trim Option)



THIS DESIGN IS THE PROPRIETARY
TRADE DRESS/TRADEMARK OF
SCHONBEK WORLDWIDE LIGHTING INC.

10 + 5 Lights
Diameter: 31"
Body Length: 37-1/2"
Hanging Weight: 40 lbs.

SCHONBEK®

See diagram on back page
Follow steps in exact order
Save this trim diagram for future reference

1

IMPORTANT

Person who opens carton should record the following information for future service.

CODE # _____ Four-digit number on outside of carton.
PACKER # _____ See crystal package label.
ORDER # _____ See crystal package label.

Instructions for crystal trimming
STEPS 19 - 36

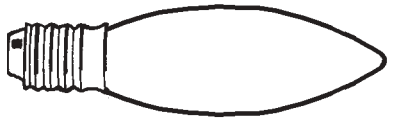

19

You will need 15 - C10
25 Watts Recommended
60 Watts Max

Install bulbs and be
sure to test fixture
BEFORE trimming.

21

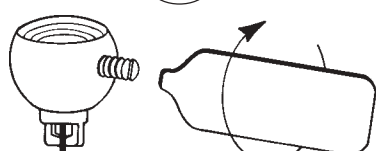

Tighten With
Tool Provided.

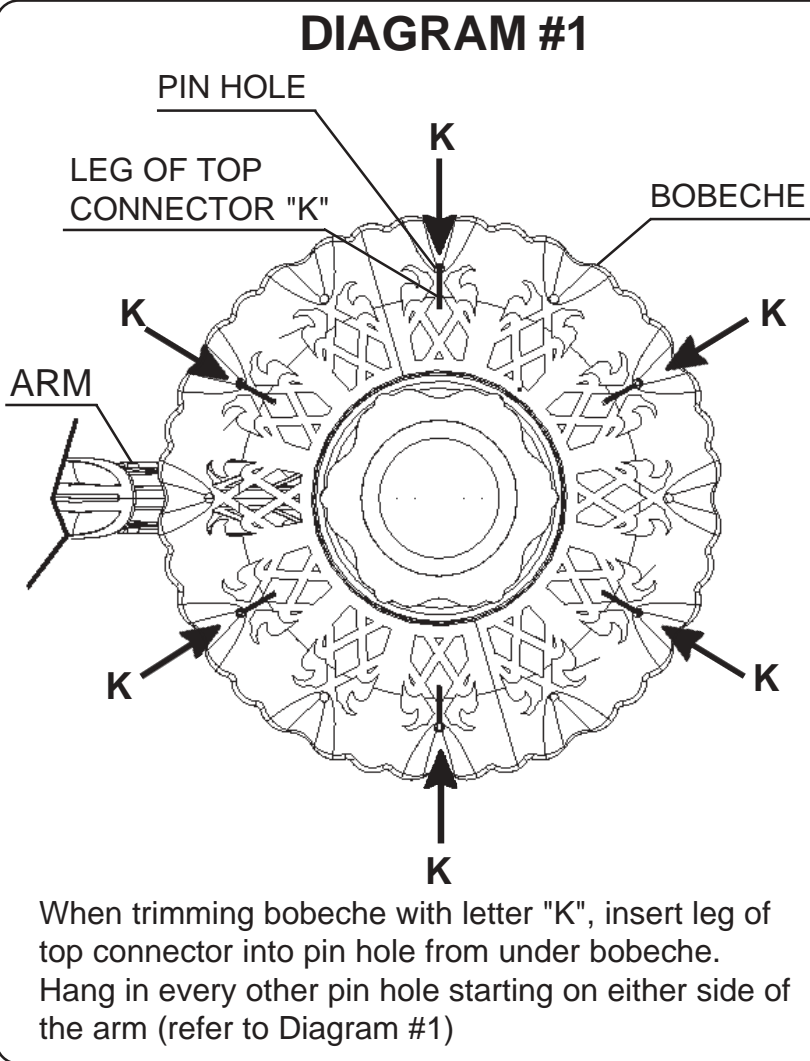

Note:
When trimming bobeche
with letter "K", insert leg of
top connector into every
other pin hole from under
bobeche. (Similar to
Diagram #1; start with any
pin hole.)

31

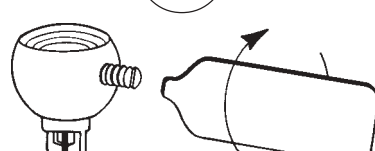

Tighten With
Tool Provided.

