

Instructions for electrician
STEPS 2 - 21

WARNING:

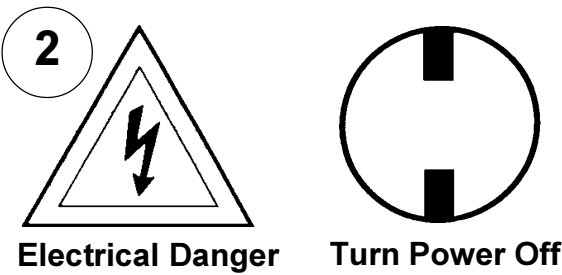

All electrical components must be installed by a licensed electrician in accordance with the National Electric Code and the appropriate local electrical codes.

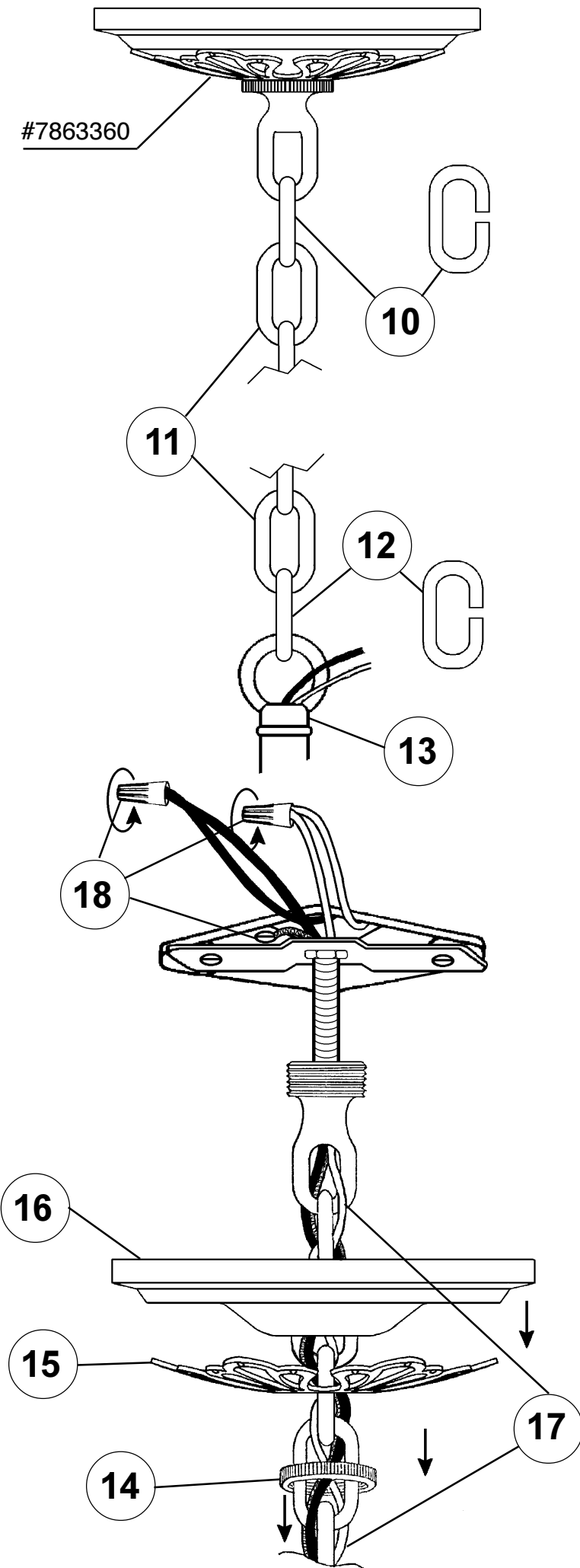
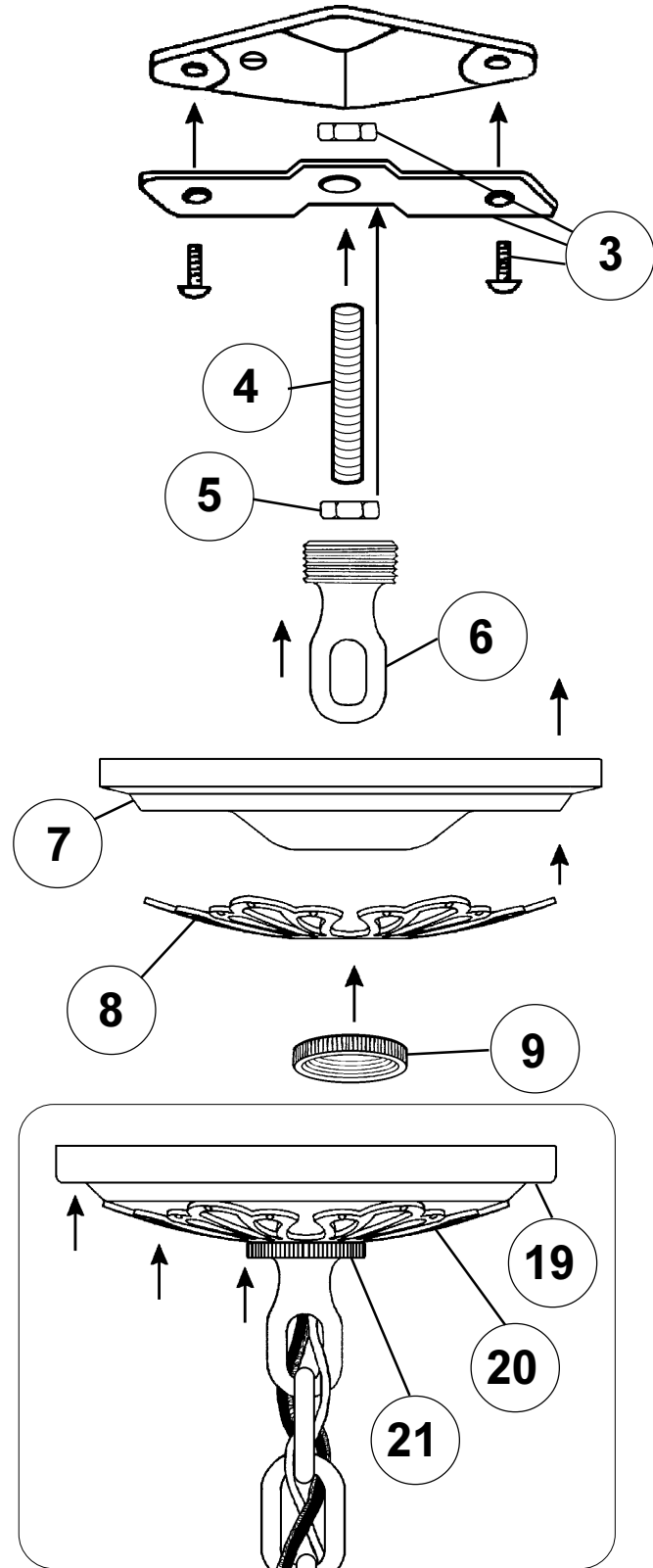

CHANDELIER 7866-____ A TRIM DIAGRAM
(Finish Option)

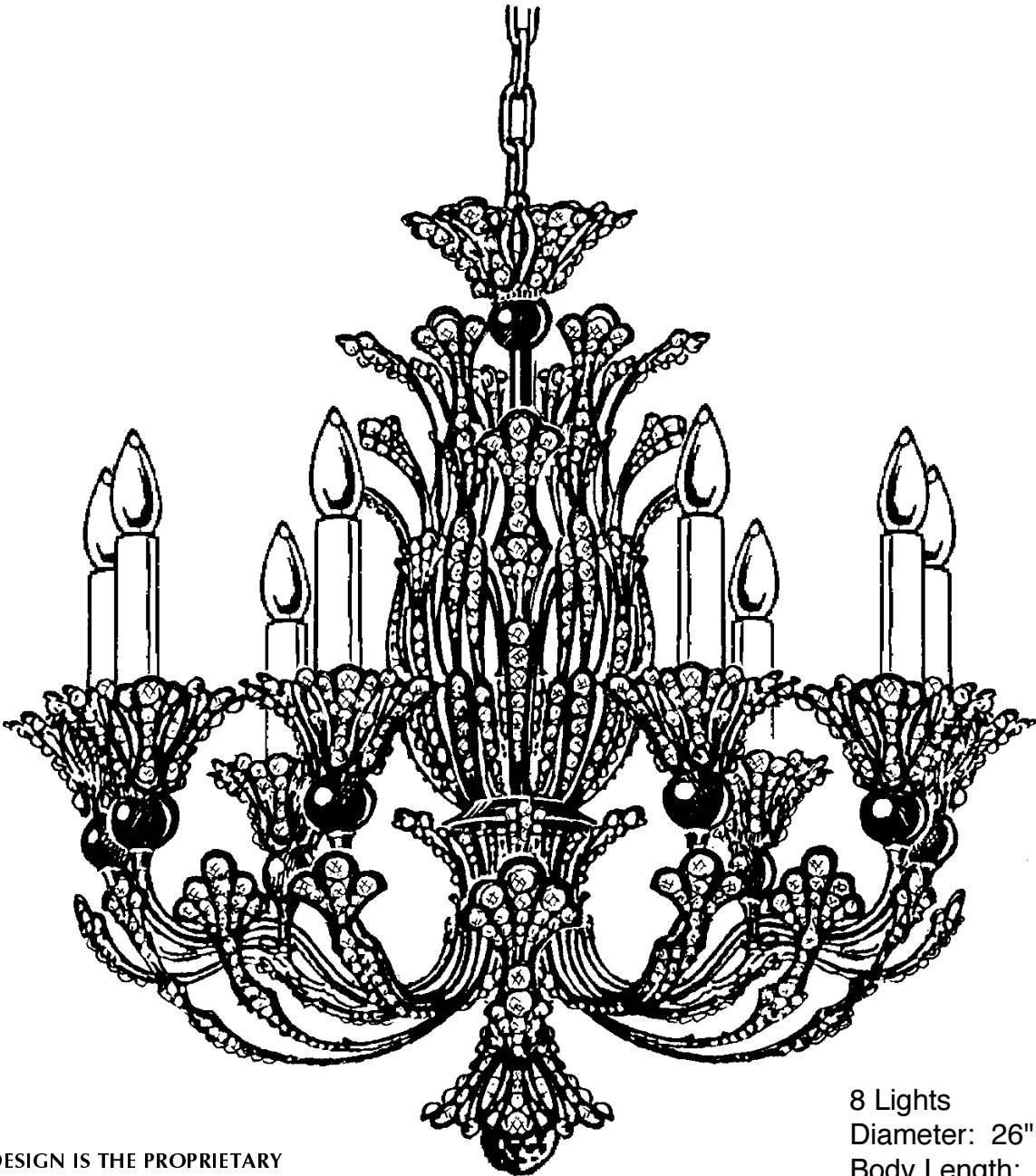

THIS DESIGN IS THE PROPRIETARY
TRADE DRESS/TRADEMARK OF
SCHONBEK WORLDWIDE LIGHTING INC.

8 Lights
Diameter: 26"
Body Length: 23"
Hanging Weight: 13 lbs.

SCHONBEK®

See diagram on back page
Follow steps in exact order
Save this trim diagram for future reference

1 IMPORTANT
Person who opens carton should record the following information for future service.
CODE # _____ Four-digit number on outside of carton.
PACKER # _____ See crystal package label.
ORDER # _____ See crystal package label.

SCHONBEK IS A WORLD LEADER IN CHANDELIER DESIGN. PATENTS INCLUDE:
#D397,494, #D397,495 & #D435,686

Instructions for crystal trimming
STEPS 22 - 24

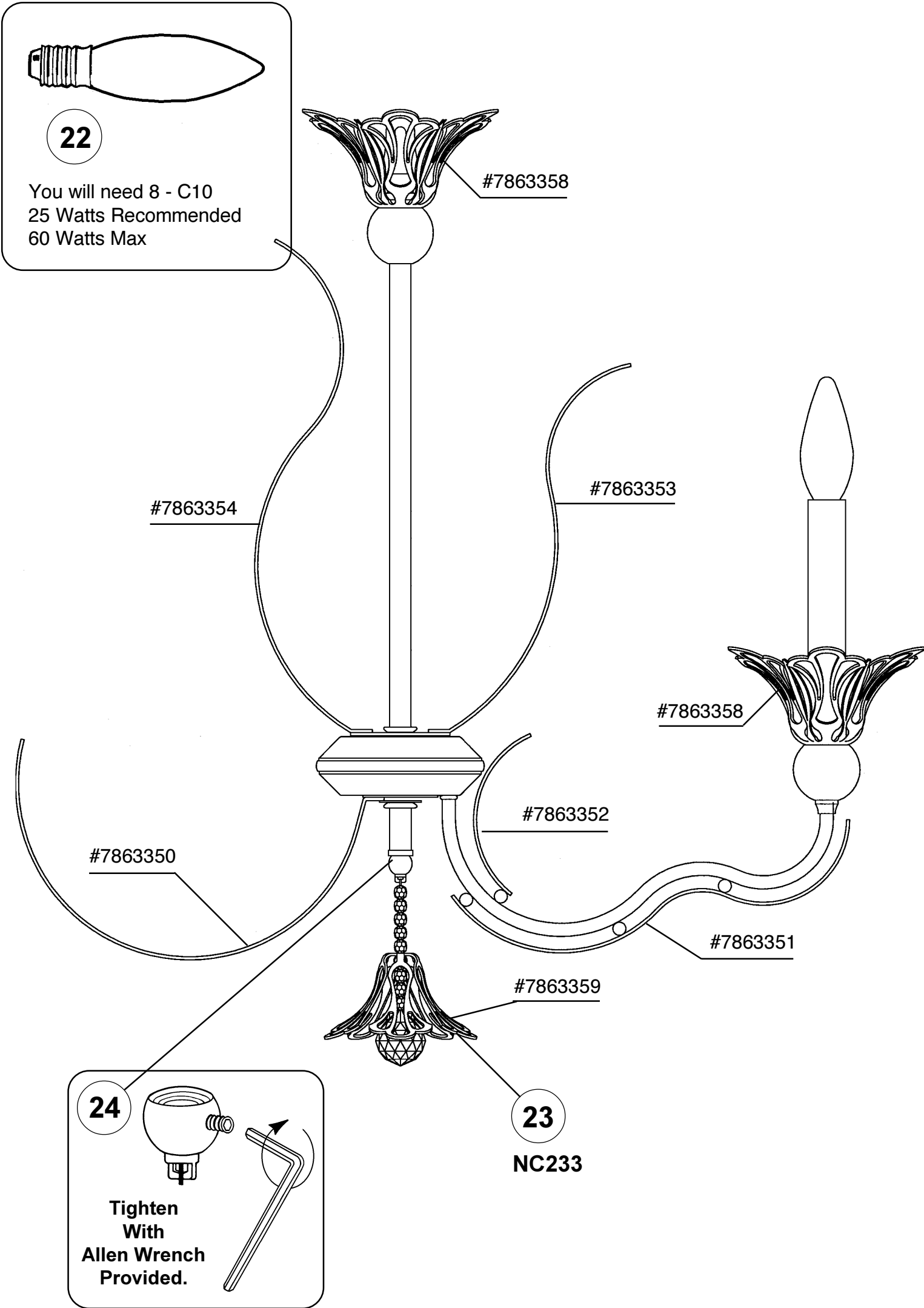

PART NUMBERS FOR
SPARE PARTS

