

Instructions for electrician
STEPS 2 - 21

WARNING:

2

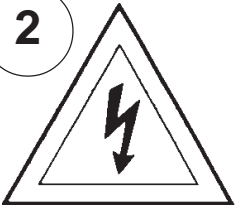

Electrical Danger

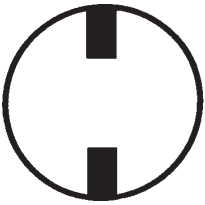

Turn Power Off

All electrical components must be installed by a licensed electrician in accordance with the National Electric Code and the appropriate local electrical codes.

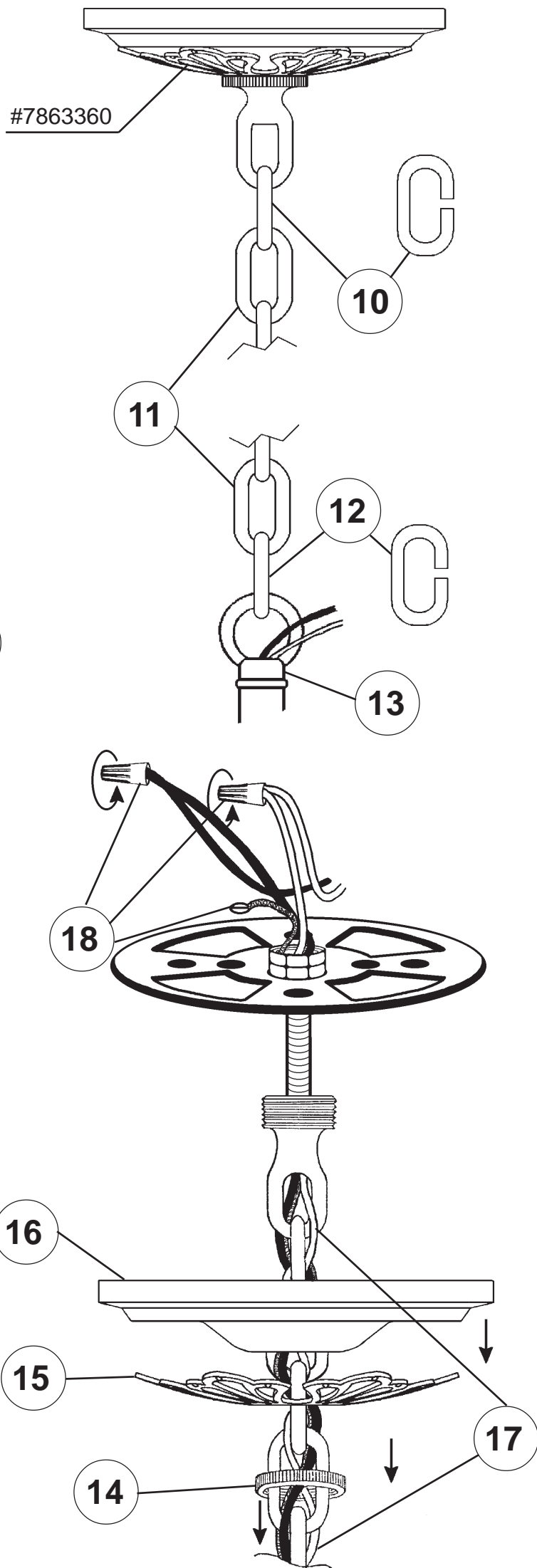
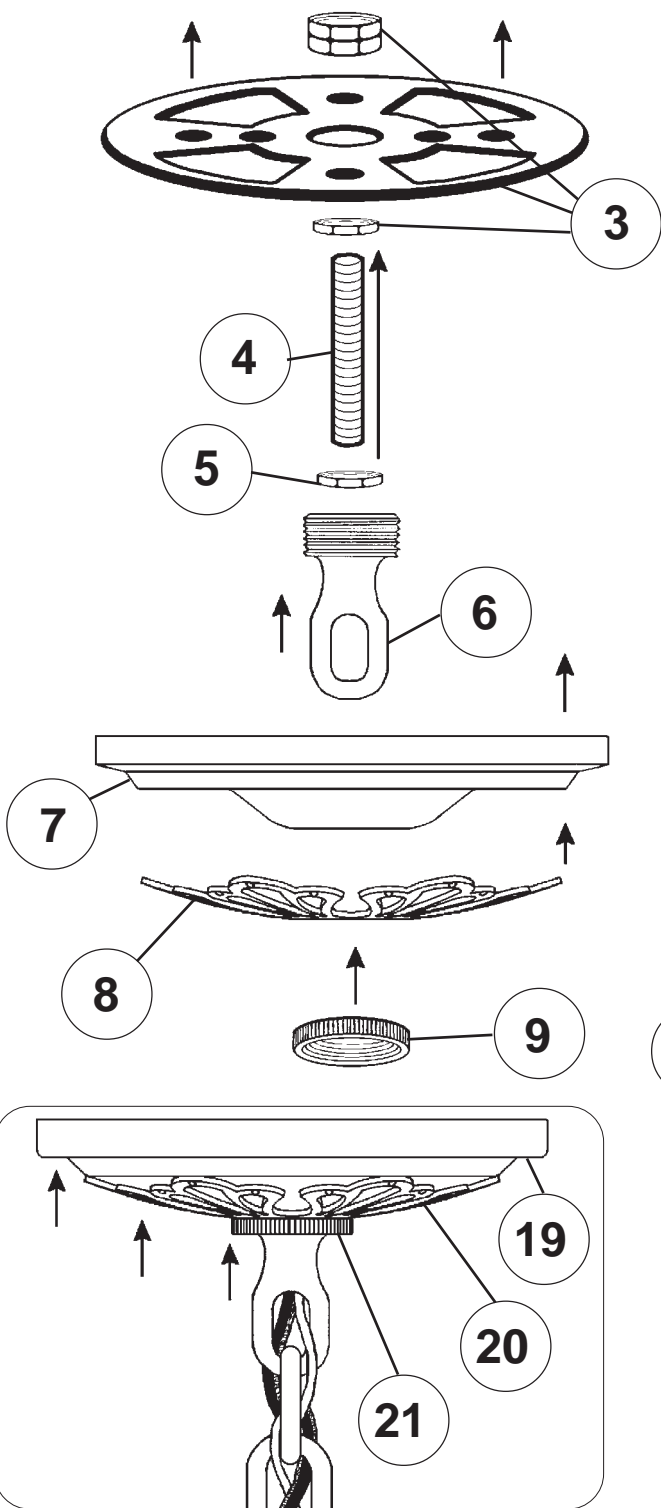

CHANDELIER 7868-____A
(Finish Option)
TRIM DIAGRAM

THIS DESIGN IS THE PROPRIETARY
TRADE DRESS/TRADEMARK OF
SCHONBEK WORLDWIDE LIGHTING
INC.

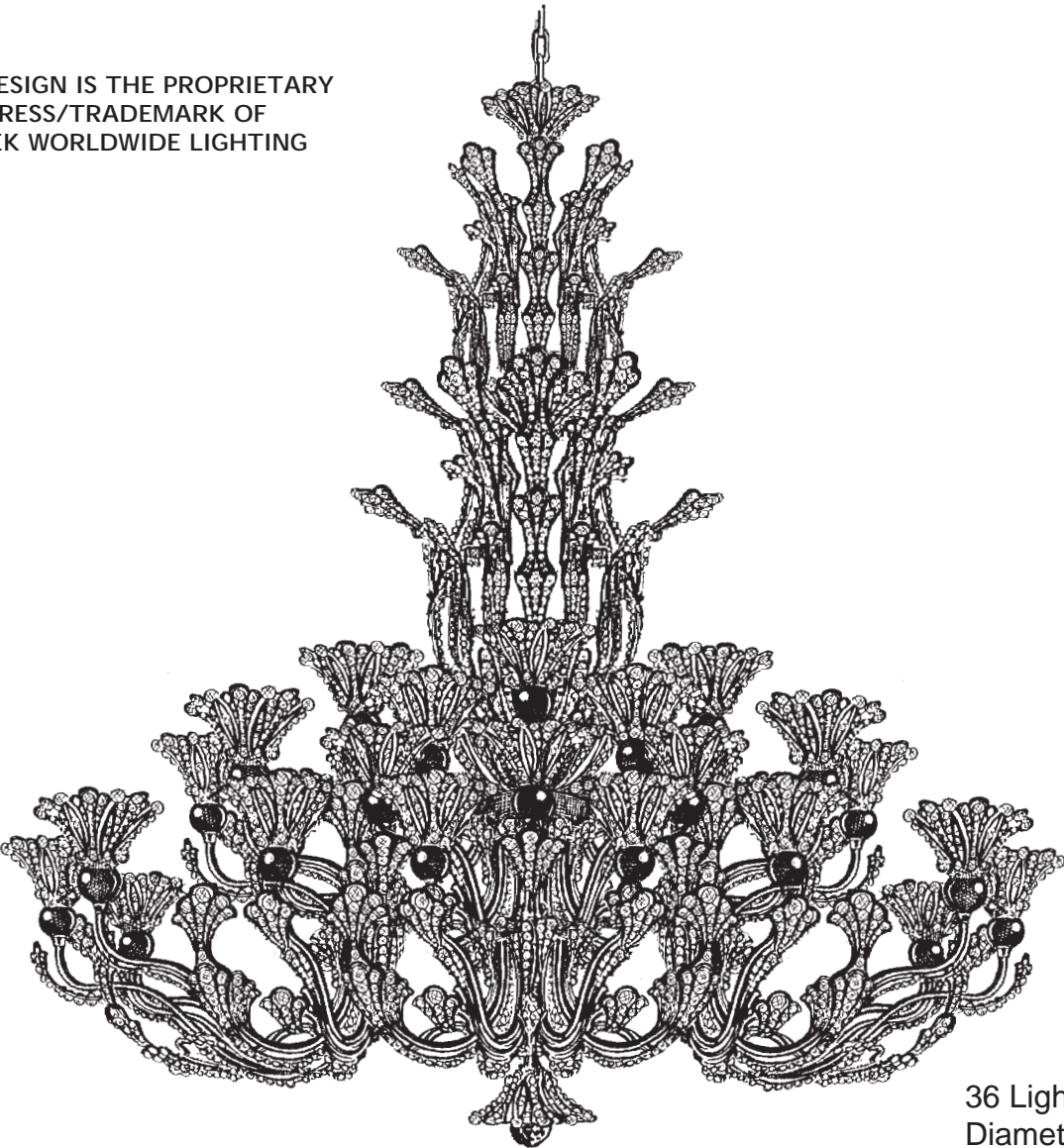

36 Lights
Diameter: 42"
Body Length: 48"

SCHONBEK®

See diagram on back page
Follow steps in exact order
Save this trim diagram for future reference

1 **IMPORTANT**
*Please record the following
information for future service.*

CODE #	_____	Four-digit number on outside of carton.
PACKER #	_____	See crystal package label.
ORDER #	_____	See crystal package label.

Instructions for crystal trimming
STEPS 22 - 29

Use Finger Cots:

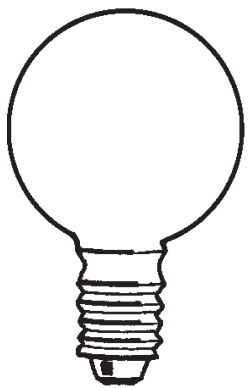
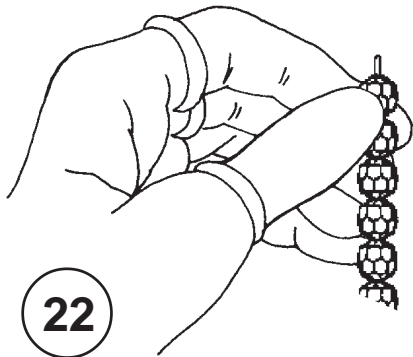

You will need 36 - G16-1/2
25 Watts Recommended
60 Watts Max

Install bulb and be sure
to test fixture **BEFORE**
trimming.

27

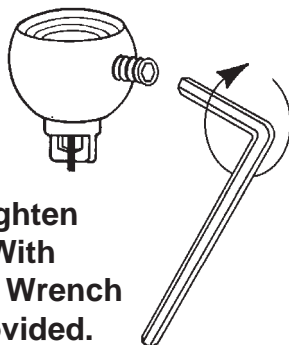

28

23

NOTE: Letter "A" hangs (on
top washer).

Letter "B" hangs in holes on
lower washer.

24

25

26

NC234

Screw onto
bottom of frame
before installing
bulb.