

Instructions for electrician STEPS 2 - 21

WARNING:

2

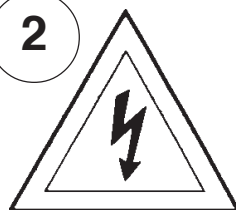

Electrical Danger

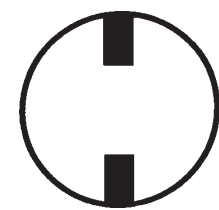

Turn Power Off

All electrical components must be installed by a licensed electrician in accordance with the National Electric Code and the appropriate local electrical codes.

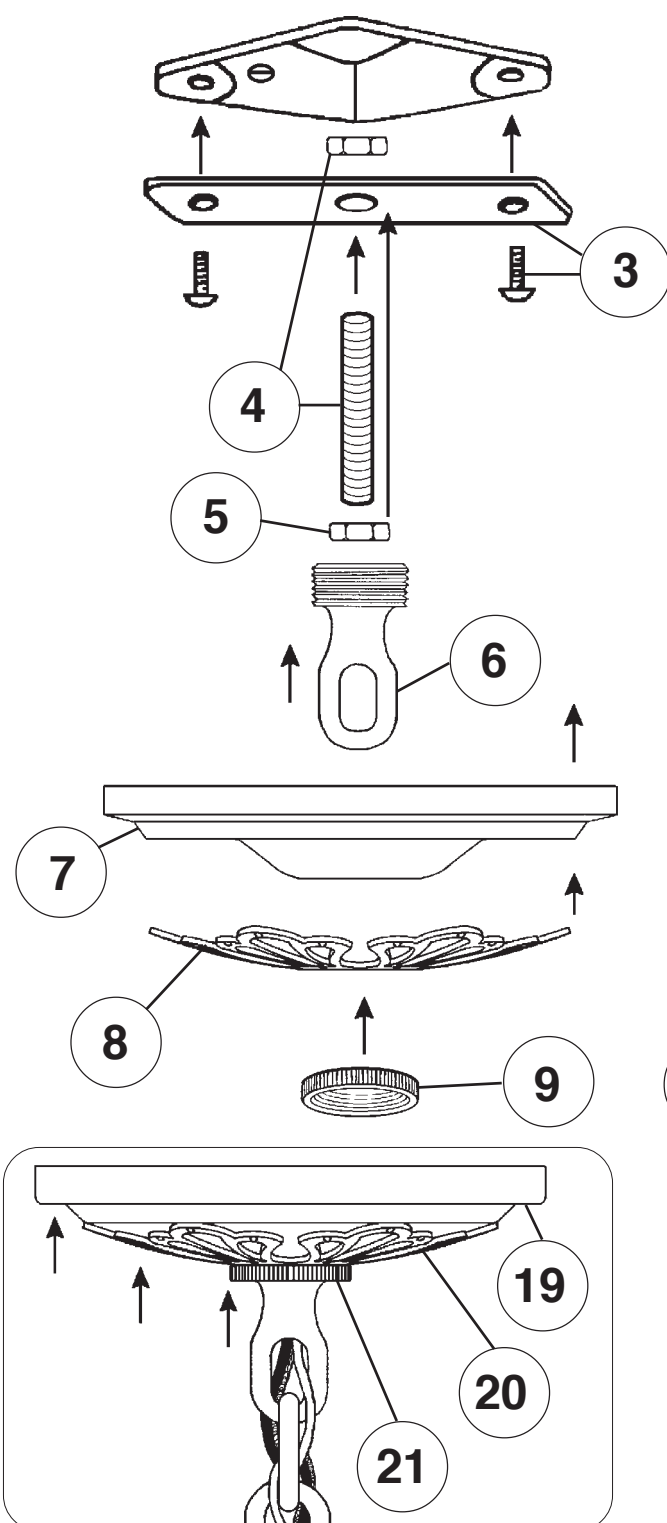
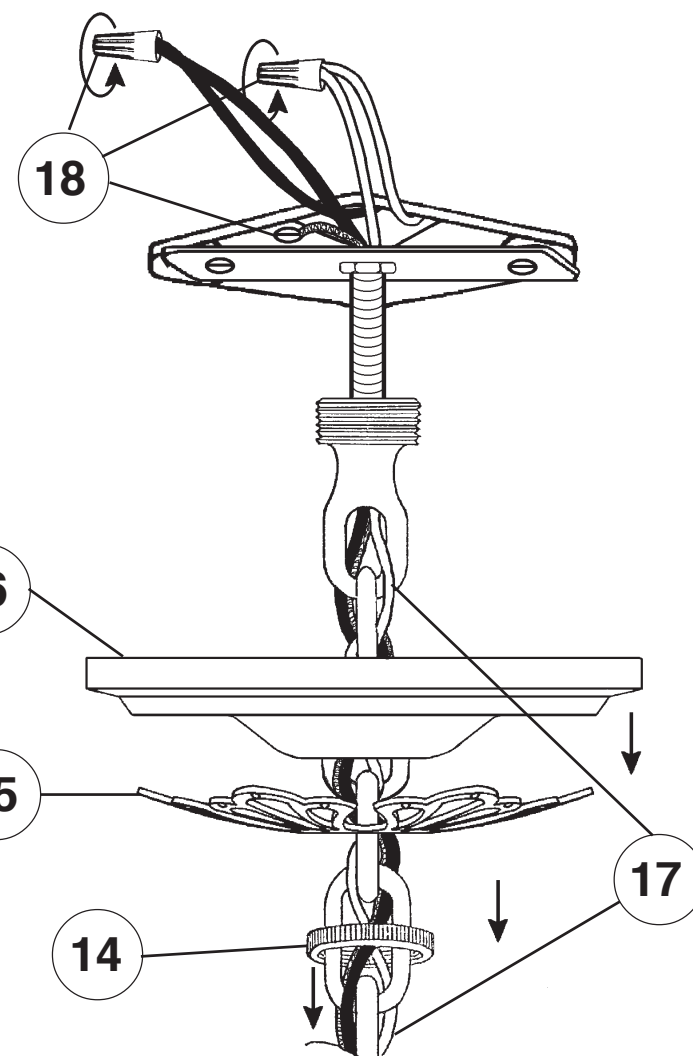
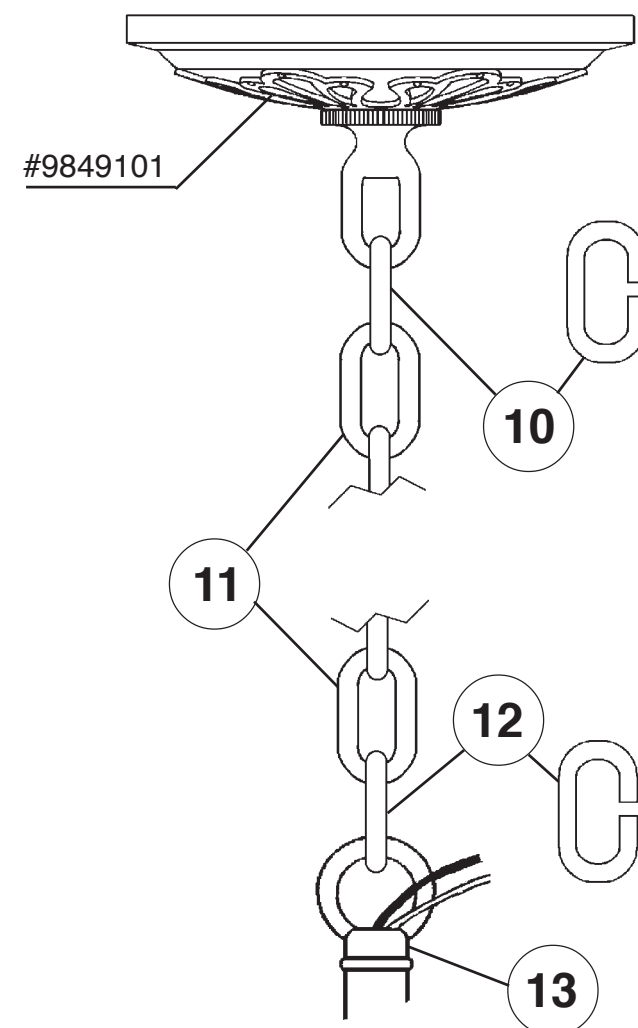

CHANDELIER 9849- _____ TRIM DIAGRAM (Finish Option)



THIS DESIGN IS THE PROPRIETARY
TRADE DRESS/TRADEMARK OF
SCHONBEK WORLDWIDE LIGHTING INC.

9 Lights
Diameter: 24-1/2"
Body Length: 29"
Hanging Weight: 16 lbs.

SCHONBEK®

See diagram on back page
Follow steps in exact order
Save this trim diagram for future reference

1

IMPORTANT
Person who opens carton should record the
following information for future service.

CODE # _____ Four-digit number on outside of carton.
PACKER # _____ See crystal package label.
ORDER # _____ See crystal package label.

SCHONBEK IS A WORLD LEADER IN CHANDELIER DESIGN. PATENTS INCLUDE:
#D397,495

Instructions for crystal trimming
STEPS 22 - 23

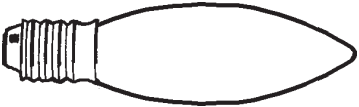

22

You will need 5 - C10
25 Watts Recommended
60 Watts Max

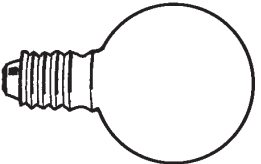

You will need 4 - G16-1/2
25 Watts Recommended
60 Watts Max

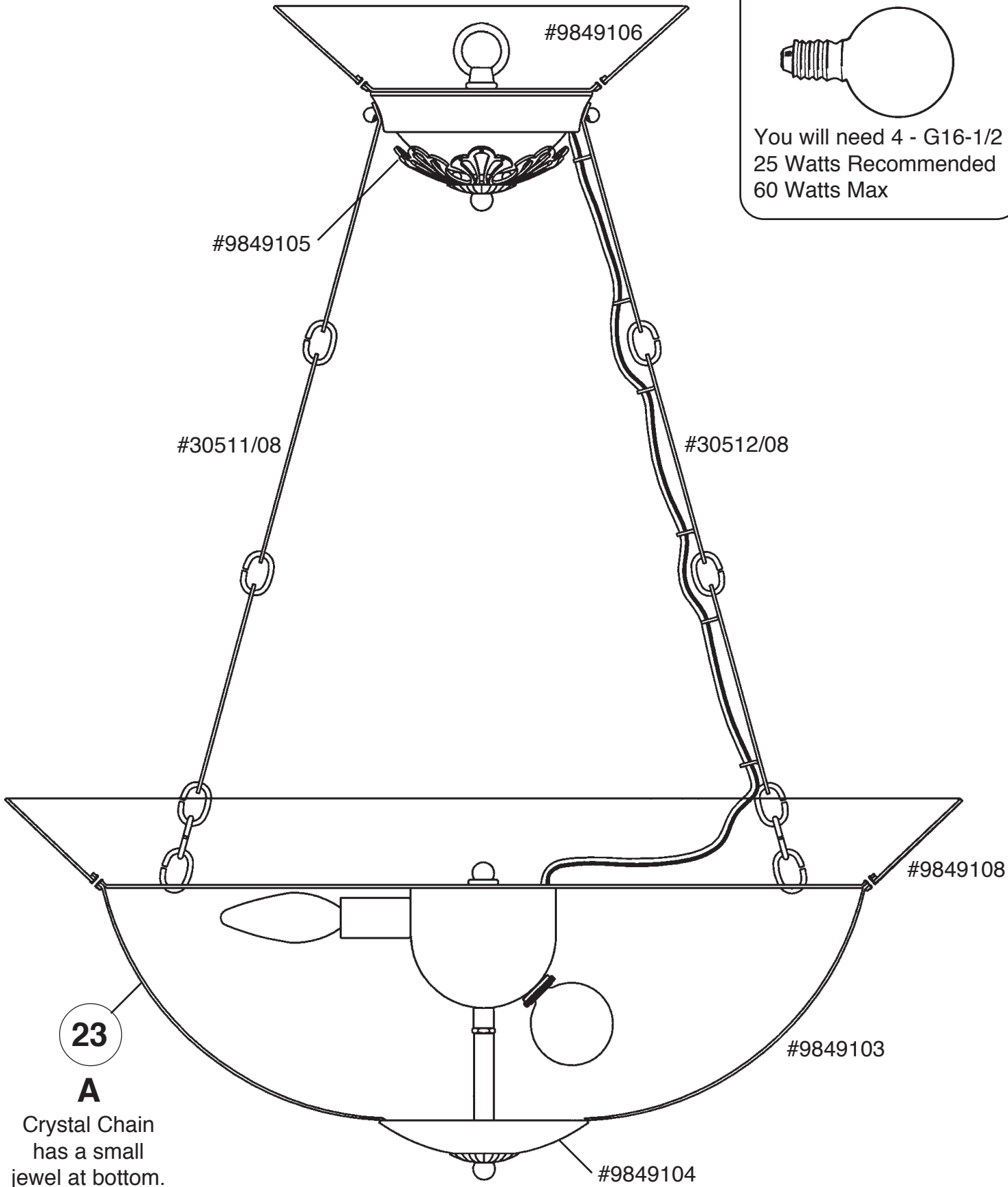

PART NUMBERS FOR SPARE PARTS

