

## SECTION IDENTIFICATION SHEET

**BOTTOM A - 87/372/1SS**

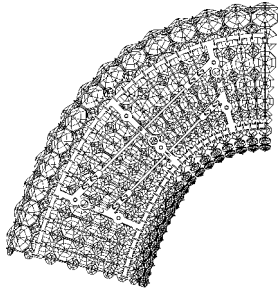

**BOTTOM B - 87/373/1SS**

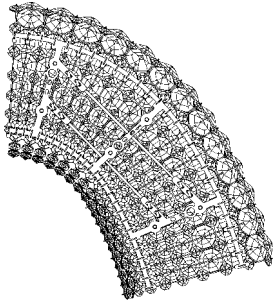

**BOTTOM C - 87/374/1SS**

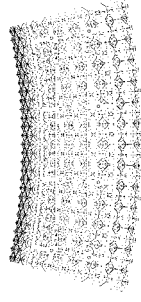

**TOP D - 87/369/1SS**

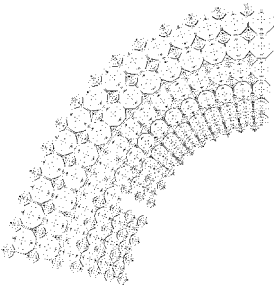

**TOP E - 87/370/1SS**

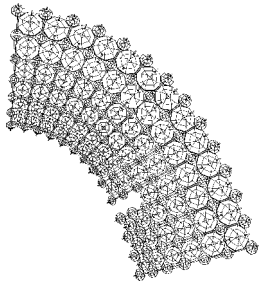

**TOP F - 87/371/1SS**



**SCHONBEK**  
BEYOND LIGHTING®

Schonbek Worldwide Lighting Inc., 61 Industrial Blvd., Plattsburgh NY 12901-1908  
Tel: 800.836.1892 or 518.563.7500 [www.schonbek.com](http://www.schonbek.com) or [www.geometrix-lighting.com](http://www.geometrix-lighting.com)  
For cleaning instructions, visit [www.schonbek.com](http://www.schonbek.com) or [www.geometrix-lighting.com](http://www.geometrix-lighting.com)

© 2008 SCHONBEK WORLDWIDE LIGHTING INC., A. SCHONBEK & CO. LTD. WORLDWIDE COPYRIGHT RESERVED

US UTILITY PATENT PENDING

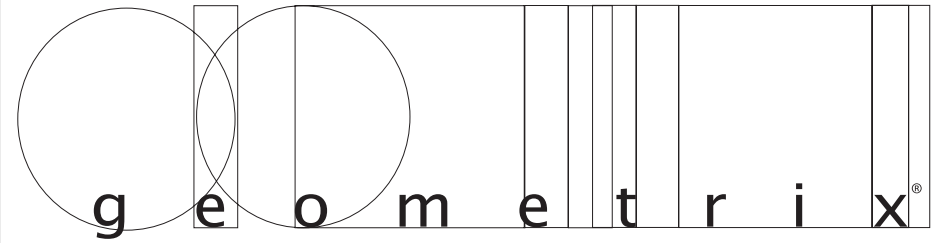

Trim Diagram  
Chandelier CA3724S

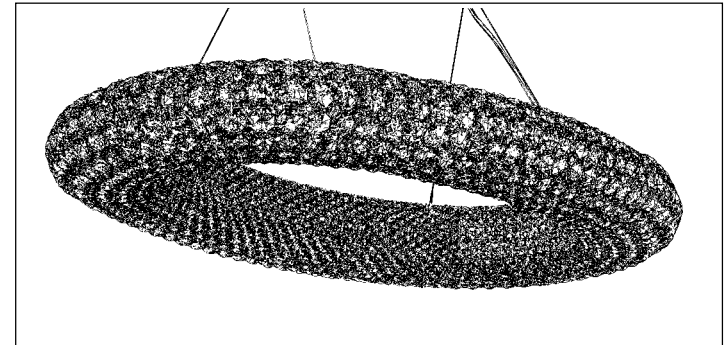

20 Lights  
Diameter: 24"  
Length: 37"

Geometrix™ is designed by Schonbek  
with Strass® crystal by Swarovski.



This design is the proprietary trade  
dress/trademark of Schonbek Worldwide Lighting Inc

Please save your trim diagram for future reference.

IMPORTANT: Label on back contains important  
information on your crystal color. Please save in case  
you ever need to order matching crystal.



**SCHONBEK**  
BEYOND LIGHTING®

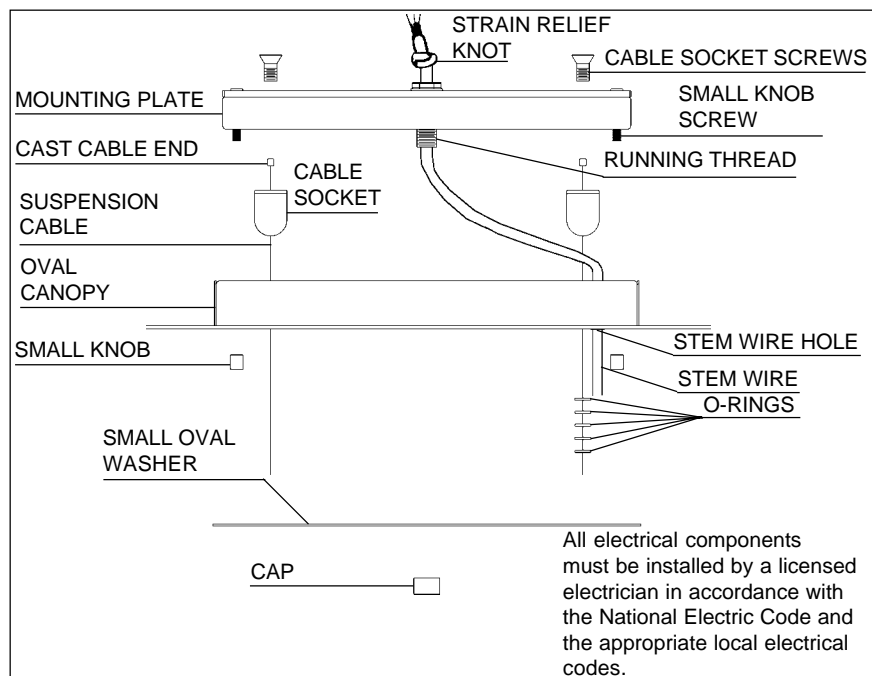

## How to Install Canopy:

**1** Remove the cap, small oval washer, (2) small knobs and oval canopy from the mounting plate. Remove cable socket screw from top of mounting plate so that you can feed suspension cables through the cable sockets from the top. The cast cable ends are seated in the inside of the cable socket. Assemble cable sockets with cables installed onto the bottom of the mounting plate with the cable socket screws securely. Attach mounting plate to the outlet box with cables hanging down. Feed suspension cables through the 4 holes in the oval canopy. Attach oval canopy to screws on mounting plate using the 2 small knobs provided. Slide all o-rings over the suspension cable closest to the stemwire before attaching to the gripper on chandelier frame. You will use these o-rings to keep the stemwire in place. Allow the suspension cable to play out of the side of the cable gripper on frame. Slide the remaining 3 cables into the 3 grippers on the chandelier frame and allow them to play out of the side of the cable grippers. To adjust height, depress the cable grippers until the cable is released to move the frame up and down the cable. Be sure to add 2" to the bottom of the frame for the height of the pinned crystal to be installed later. Bottom of frame should not be closer then 6" to the ceiling. See diagram on page 7. Feed stem wire through o-rings on suspension cable up to the canopy and through the stem wire hole in oval canopy. When chandelier is at desired height, trim stem wire and connect ground wire (marked with green tracer) and power wires (black or white tracers) in outlet box. If more room is needed to wire, remove 2 small knobs and side oval canopy down to work. Once wiring is completed, raise oval canopy to ceiling and secure using the 2 small knobs provided. Align holes in small oval washer with small knobs, and attach to running thread using cap. Cut suspension cable with cable cutters leaving about 1/2" protruding from the side of the cable gliders on the chandelier frame. Adjust o-rings on the stem wire so they are spaced approximately 3" apart.

**2** Plug bulbs carefully but completely into socket. Be sure NOT to handle bulbs with bare hands. Use only G9 JCD bulbs marked "suitable for open luminaires" OR bearing this symbol:

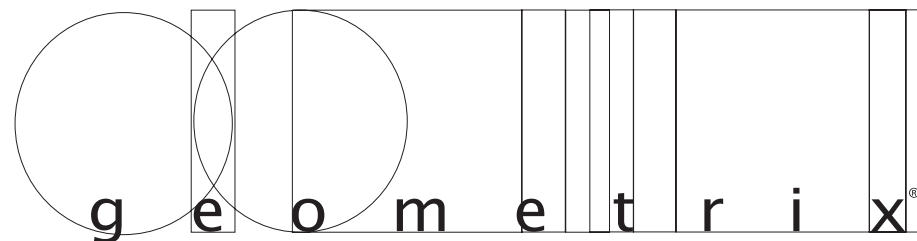

## Frequency of cleaning crystal

We know people who clean their crystal every few months, because they love handling the crystals and admiring them close up. Others do a cleaning every six or nine months.

To stretch the time between cleanings, dust lightly every two or three months with a feather duster, lambswool duster or make-up brush.

Frequency of cleaning depends on location of your Cassini and other environmental factors.

Crystal needs cleaning when it appears dusty or dull. Just look at your Cassini frequently (always enjoyable), and you'll know when it's time for a cleaning.

## Minimum Distance to Ceiling

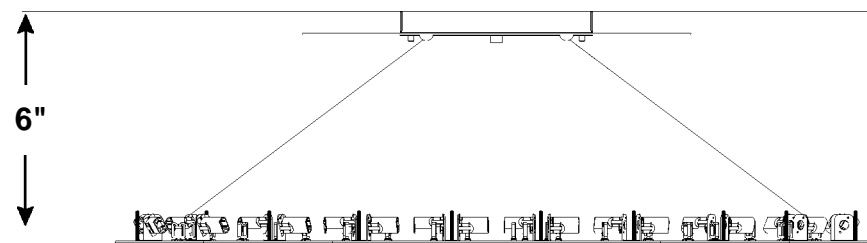

## REPLACING CRYSTAL:

If a crystal breaks, you'll see a bare spot in the framework. You will need a set of needlenose pliers to replace the crystal. Make sure when placing pliers onto the metal tab that the ends of the pliers do not go beyond and scratch the crystal.

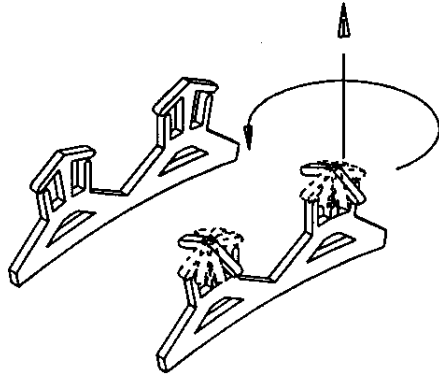

**A** Turn both tabs 90° counterclockwise on either side of pocket where the octagon should be.

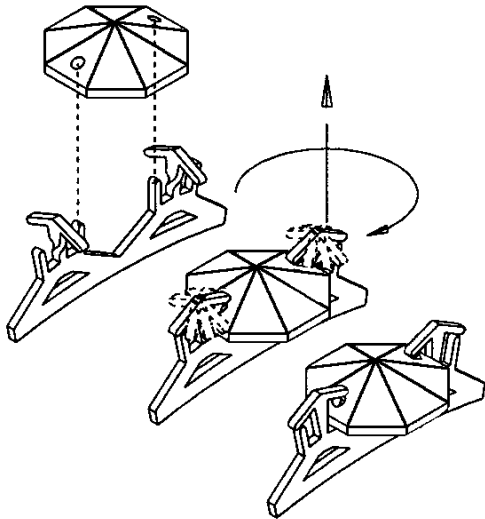

**B** Slide crystal octagon into pocket. Turn both tabs clockwise back to original position to hold the octagon in place.

## CRYSTAL IDENTIFICATION SHEET

### TOP SECTORS

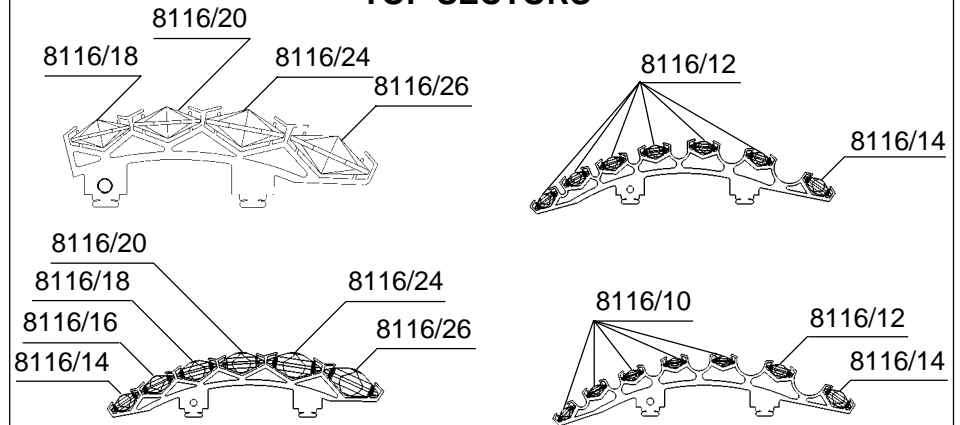

### BOTTOM SECTORS

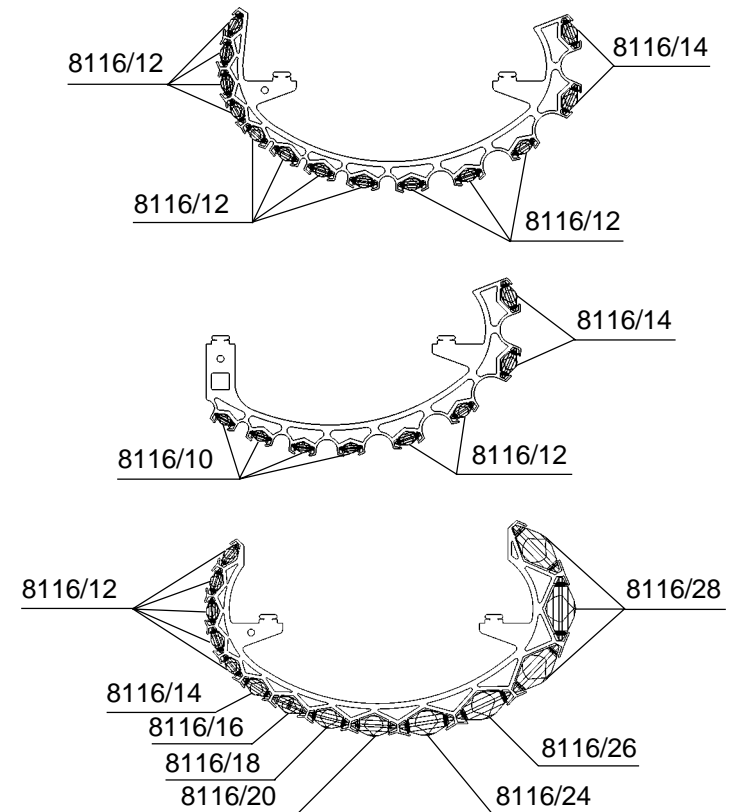



20 - G9 JCD  
(Supplied - Schonbek #JCD-G9-40)  
40 Watts Max  
Hanging Weight: 42 pounds  
Install bulbs and be sure to test  
fixture BEFORE assembly.



To avoid damaging, do  
NOT touch bulb with bare  
hands. Install bulb with  
clean cloth or tissue.

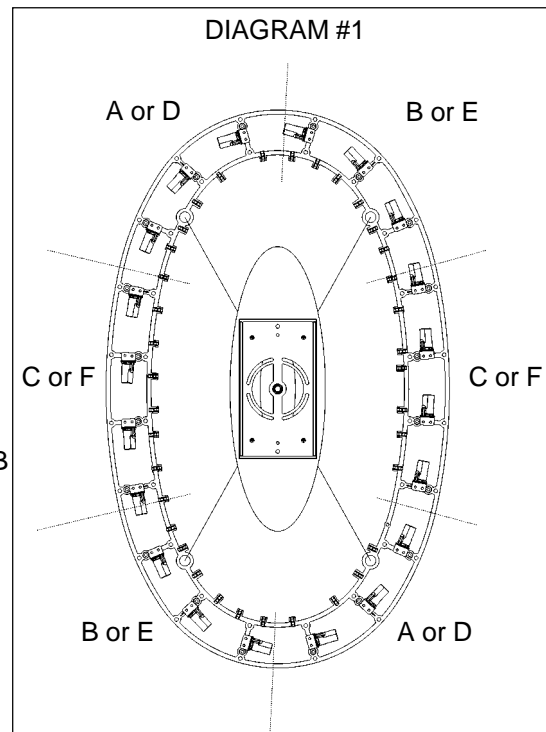
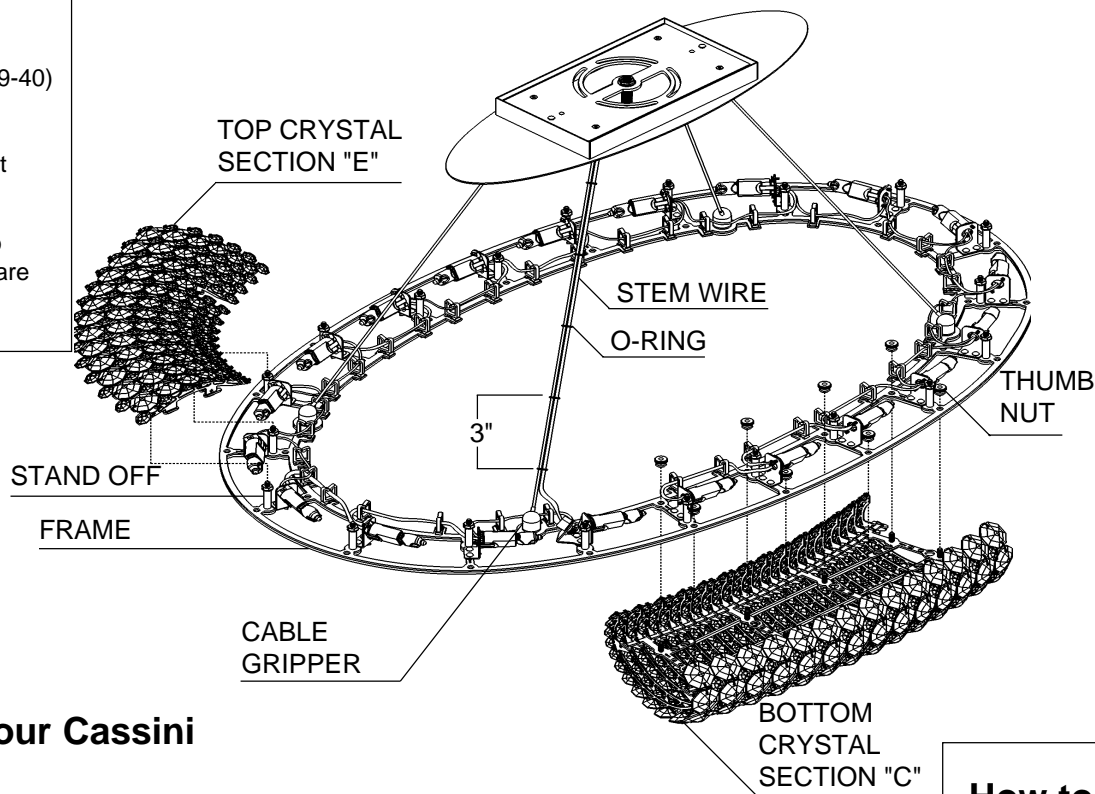

## How to Assemble Your Cassini Chandelier:

Put on white cotton gloves to handle crystal.

**3** Using crystal section placement map (Diagram #1) determine location of each bottom crystal section (A, B or C). Align studs in bottom crystal section with holes in frame.

**4** Screw thumb nuts to studs. Hold on securely to crystal section until you are sure the thumb nuts are secure. NOTE: Be sure the thumb nuts do not pinch the wires.

**5** Repeat for each bottom crystal section until all are in place.

**6** Using crystal section placement map (Diagram #1) determine location of each top crystal section (D, E or F). Align holes in the underside of the top crystal section with standoffs on frame. (See diagram #2) Top crystal section will simply rest on these standoffs.

**7** Repeat for all top crystal sections.

**TWO PERSON  
ASSEMBLY  
RECOMMENDED**

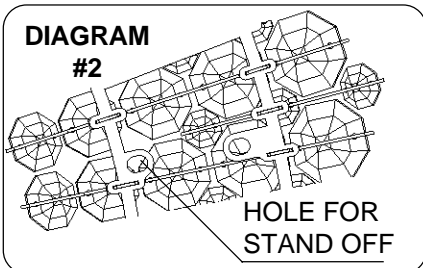

## How to take apart your Cassini for changing bulbs or cleaning:

**1** Remove all top crystal sections by lifting up on each section.

**2** The bottom of the fixture will come apart in (6) sections.

**3** Remove each section by unscrewing the corresponding thumb nuts. Be sure to hold on securely to the crystal section beneath.

**4** Gently pull down on bottom crystal section.

**5** Repeat for the remaining bottom crystal sections so all that remains is the frame with bulbs.

**6** Do not discard thumb nuts, they are required for reassembly.

**7** Replace necessary bulbs.