

ASSEMBLY AND INSTALLATION INSTRUCTIONS

X0057 / X0058 / X0059 / X0060 / X0061 / X0062 / X0081 / X0082 / X0083

WARNING: TO AVOID RISK OF ELECTRICAL SHOCK, BE SURE TO SHUT OFF POWER BEFORE INSTALLING OR SERVICING THIS FIXTURE.

NOTE: 1. Before installing, consult local electrical codes for wiring and grounding requirements.
2. READ AND SAVE THESE INSTRUCTIONS.

Hardware Package (included):

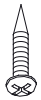

Dry Wall Screw



Switch Label



Cable Clip



Connector



36W Power Adaptor



48W Power Supply Box
(Sold Separately)

Important to Know

1. Read all instructions carefully before installation and operation. Save instructions for future reference.
2. If you are not familiar with national and local electrical codes, it is recommended that you consult with a qualified electrician.
3. Multiple fixtures can be linked in series:
1 sensor plus up to 10 puck lights from 36W power adaptor or 1 sensor plus up to 15 puck lights from 48W power supply box.
4. Do not use in wet locations, use indoors only.
5. LEDs are non-replaceable. Do not attempt to open the light fixture.
6. LED light output is strong enough to cause eye damage. Avoid staring directly at the LED light source for prolonged periods of time.

7. Specification:

NO.	Item #:	Details	Dimension(inch)		Total Watts
			A	B	
1	X0057/X0060/X0081	3-pack Kit	2.75	0.75	9W
2	X0058/X0061/X0082	5-pack Kit	2.75	0.75	15W
3	X0059/X0062/X0083	7-pack Kit	2.75	0.75	21W

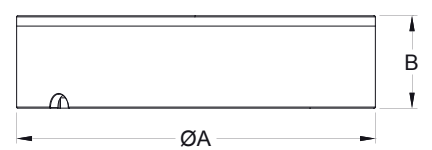

Installation Steps

LOCATE DESIRED POSITION FOR PUCK LIGHT

1. Carefully unpack the fixture. Lay out all parts on a clean surface.
2. Determine desired placement for mounting puck lights and control sensor unit. Be sure spacing of components does not exceed maximum length of power cord (from outlet) and linking cables (from one component to the next). The mounting surface should be a minimum of 0.5 inch thick.
3. The recommended location for the under-cabinet light fixture is near the front edge of the cabinet as shown in fig.1. This provides the best light distribution across the countertop.

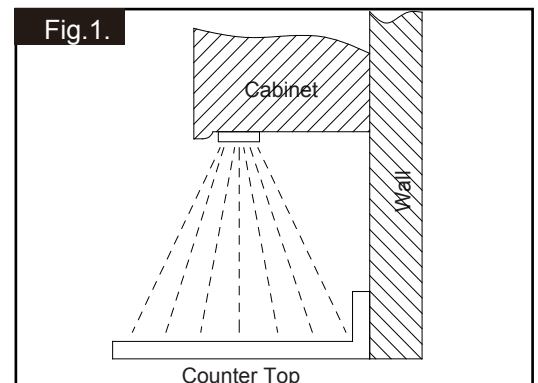

This fixture can be mounted in two ways.

A: For Surface Mounting:

Turn off the power at fuse or circuit box.

NOTE: a. Sensor control unit can be connected at the beginning, middle, or end of a series. Additional sensor units (sold separately) can be connected to a single series to provide multiple control points if desired.

b. When multiple light fixture and sensor control units connect together in series, the last unit in series should hide the link cord with female plug into its lamp housing. (See Fig.2, light fixture for example)

MOUNTING THE SENSOR CONTROL UNIT:

1. Take off the lamp housing from sensor control.
2. Pull link cords out and place into lamp housing notch or drill 3/4" holes to allow link cords to pass through mounting surface.
3. Place the lamp housing against the mounting surface in the desired position and secure it with two dry wall screws.
4. Press the light fixture to the lamp housing while pulling both link cord ends. (See Fig. 3)

MOUNTING THE PUCK LIGHT:

5. Locate desired position for next unit, making sure the linking plugs can reach (approximately 12" apart is standard spacing). Repeat step 1-4 for puck light installation.

NOTE: The adjacent connectors of two units should be reversed (male to female).

6. Connect the the plugs of the light fixtures and sensor control. Plug the connector to power cord plug (male), and then connect the connector and the plug of the sensor control (puck light). Finally plug the driver power cord into a 120V AC 60HZ outlet. (See Fig. 4a)

NOTE:

a. Use included cable clips to help keep linking cords neatly organized. Peel away the paper backing on the cable clips and stick them on cabinet. Fasten the cords with the cable clip. (See Fig. 4a)

b. The linking cord will only plug into one end correctly. Do not try to force it into the wrong receptacle as this could cause damage to the fixture.

Turn on the power at fuse or circuit box.

Fig.2

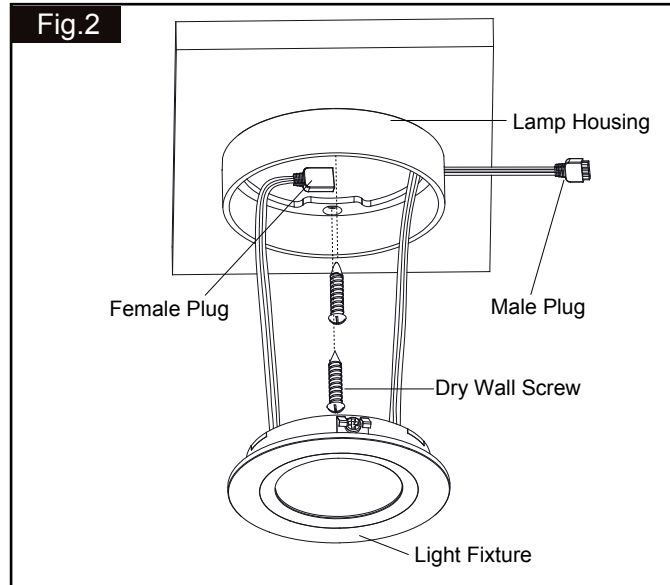

Fig.3

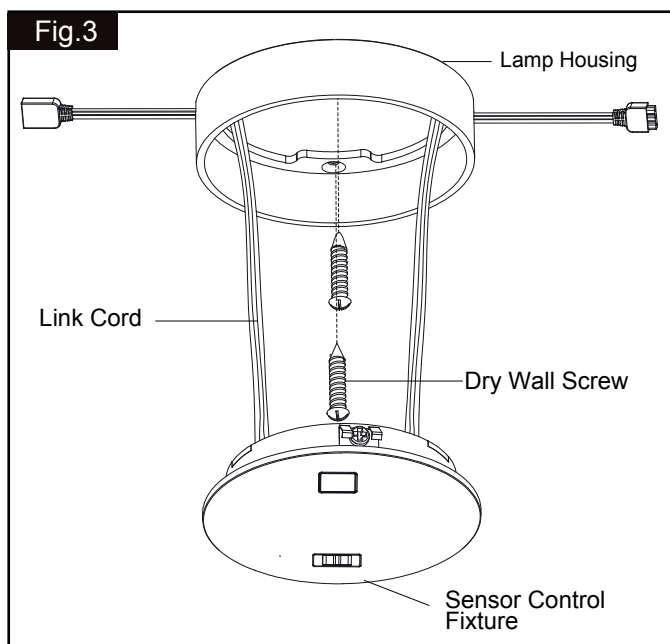
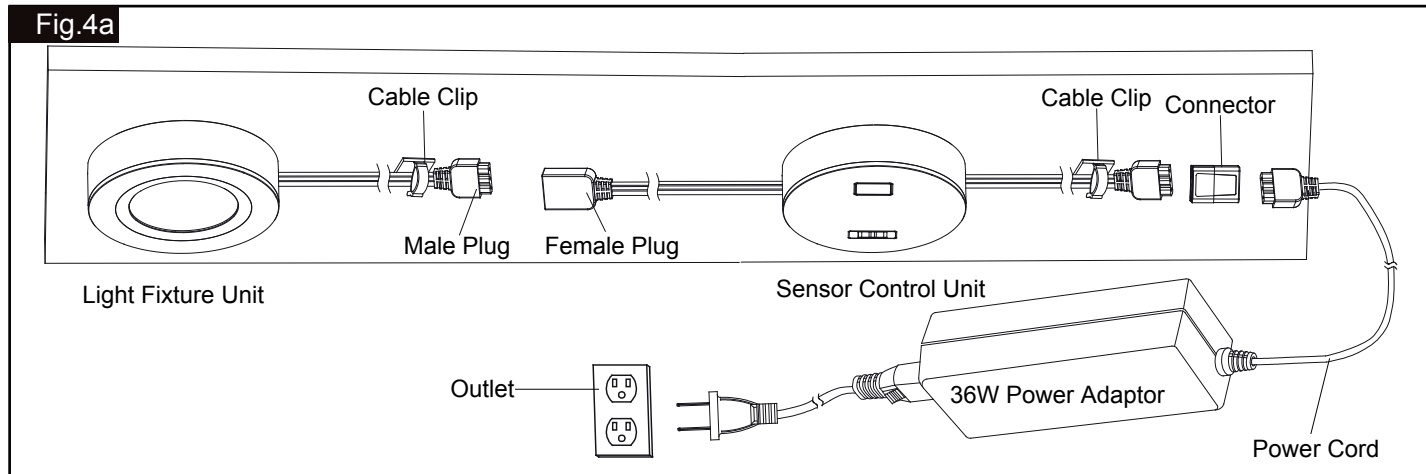
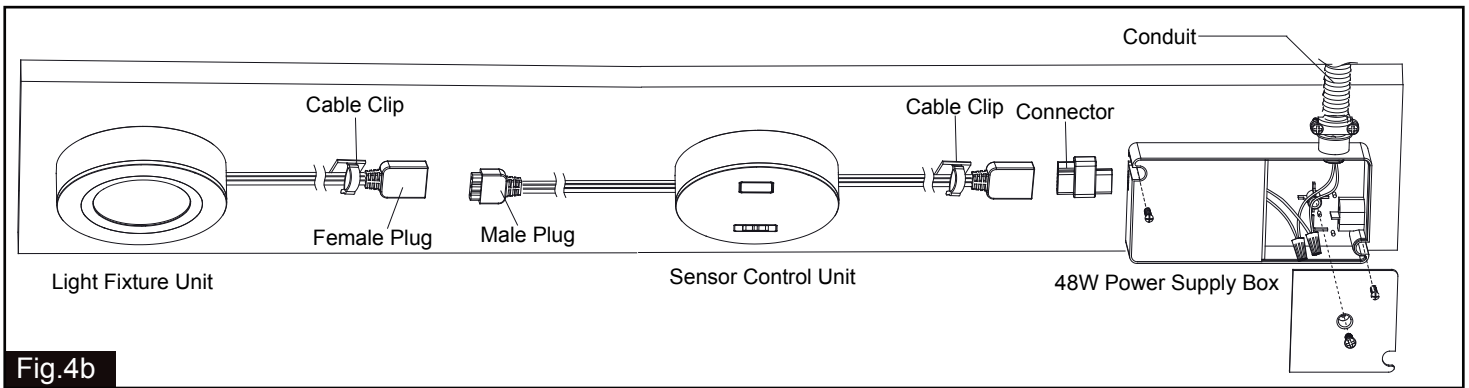

Fig.4a



**Direct Wire 48W Power Supply Box
(Purchased Separately)**



B: Recessed Installation:

Turn off the power at fuse or circuit box.

MOUNTING THE SENSOR CONTROL UNIT:

1. Locate desired position for puck light or sensor control.
2. Drill a 2-3/8" hole in the desired location. (See Fig.5)
CAUTION: If the hole is too big or small, the puck light cannot be installed.
3. Remove the lamp housing from puck light. Then feed cords through the hole and push the light into the hole. (See Fig.6)

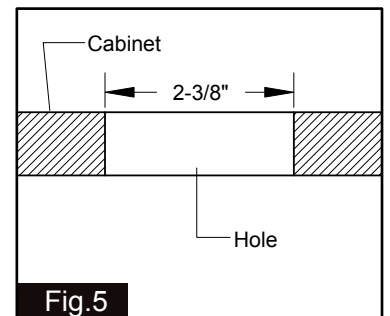

MOUNTING THE PUCK LIGHT:

4. Locate desired position for next unit, making sure the linking plugs can reach (approximately 12" apart is standard spacing). Repeat step 2-3 for puck light installation.
NOTE: The adjacent plugs of two units should be reversed (male to female).

5. Connect cords follow step 6 of A installation .

Turn on the power at fuse or circuit box.

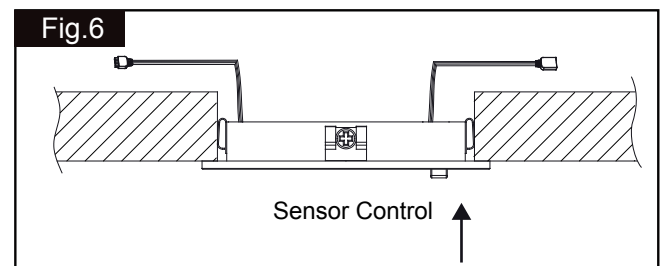

Linking multiple fixtures:

Fig.7 Surface mounted installation:

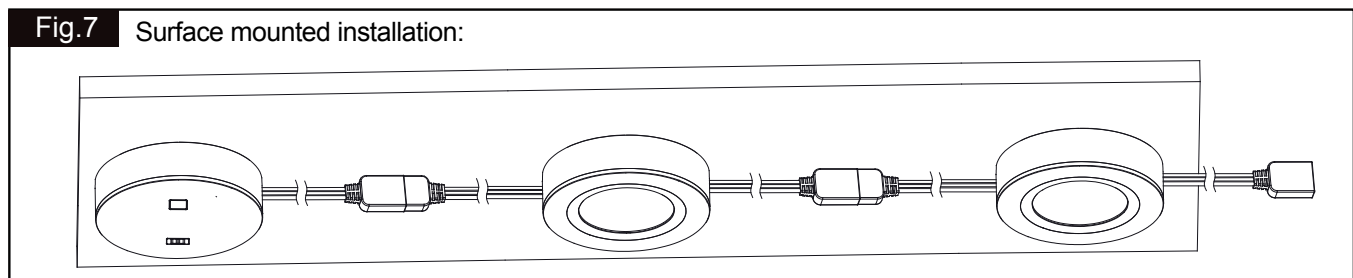
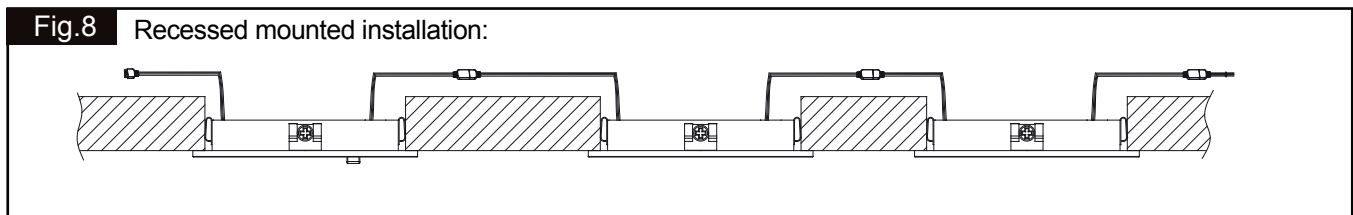

Fig.8 Recessed mounted installation:



1. The combined wattage of multiple light fixtures per run should not exceed the power rating of the driver (maximum 36W or 48W).
2. A maximum distance of 12" between light fixtures should be allowed for linking cord. Install each light fixture or sensor control by following steps 2-4 of surface installation or steps 2-3 of recessed installation. Once installed, connect cords and follow step 6 of surface installation. (See Fig. 7-8)

Function and Operation

Choose an option by sliding the switch on the surface of the sensor control. (See Fig.9).
When the switch is set to "🔒", the sensor is deactivated.

When the switch is set to "📶", the sensor 's active detection range is 4" below the fixture.

When the switch is set to "📶", the sensor 's active detection range is 8" below the fixture.

Fig.9

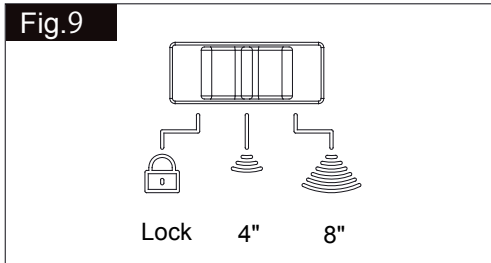

NOTE: This under cabinet light fixture has a memory function.
*** If the fixture is switched off, it will return to the same level of brightness when switched on again.**

Operation

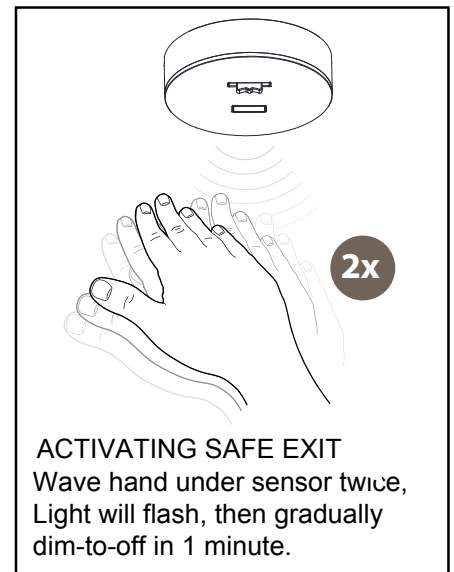
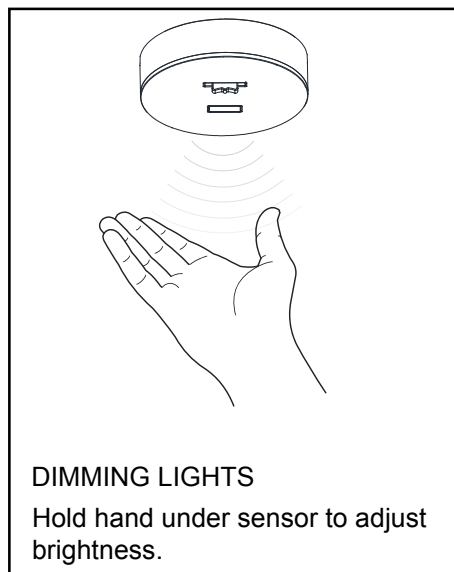

NOTE: Detection zone is within 4" or 8" distance from the sensor.

Power Label: Hardware pack includes a "Power" label sticker. This can be applied to the cabinet surface above the IR detection area to serve as a reminder for motion sensor control location.

Cleaning instructions

Your fixture is made from quality materials that will last for many years with minimum care. When cleaning, make sure you have unplugged your fixture, and have allowed sufficient time for the unit to cool to room temperature. You should clean the housing and lens using a damp soft cloth. You should plug your fixture back in only after the fixture has thoroughly dried.

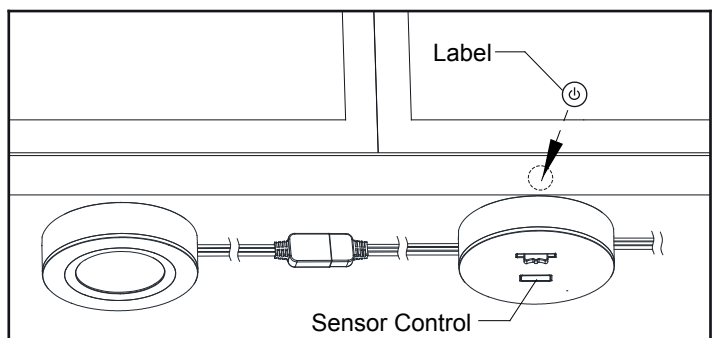

Trouble Shooting

Minor problems often can be fixed without the help of an electrician. Before doing any work on the fixture, shut off power supply at the circuit breaker panel to avoid electrical shock.

PROBLEM	POSSIBLE CAUSE	CORRECTIVE ACTION
Light will not come ON.	1. Power is off. 2. Bad plug connection. 3. Switch is in Lock Mode with power off.	1. Check if power supply is on. 2. Check power cord. 3. Move switch to 4" or 8" sensor range.
Fuse blows or circuit breaker trips when light is turned on.	1. Discontinue use.	1. Call customer service.
The light dims automatically.	1. The sensor control points toward a reflective material.	1. Do NOT mount over water. 2. Minimum 12 inches distance from the counter to the light panel surface.

The following spare parts are available if damaged or missing.

Contents of Spare Parts:



Dry Wall Screw

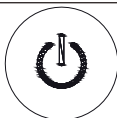

Switch Label

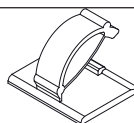

Cable Clip



Connector

5524MM 1SET for (X0057 / X0058 / X0059)
5525MM 1SET for (X0060 / X0061 / X0062)

5-YEAR LIMITED WARRANTY:

All products are warranted to be free of defects in material and workmanship for five (5) years from date of purchase. This warranty is limited to the correction of any such defect, or the replacement of any such defective item(s), provided that: (a) we are properly notified and consent to return of the item(s) in question; (b) the item(s) is / are returned with proof of purchase date; and (c) it is found upon inspection by us that the item(s) is / are defective as noted above. This warranty does not cover labor costs, consequential damages, nor does it apply to any item(s) that have been improperly installed, overloaded, altered, or otherwise abused by the customer, its agent(s) or employee(s). Finishes are specially excluded from the terms of this warranty since they are subject to environmental maintenance deemed beyond our control. Other than the described obligation, we assume no further liability with respect to the sale or use of our products. We make no warranty, express or implied, and disclaim any warranty of merchantability or fitness for a particular purpose.