

LED UNDERCABINET LIGHT

Model Number:
X0116, X0117, X0118

PACKAGE CONTENTS

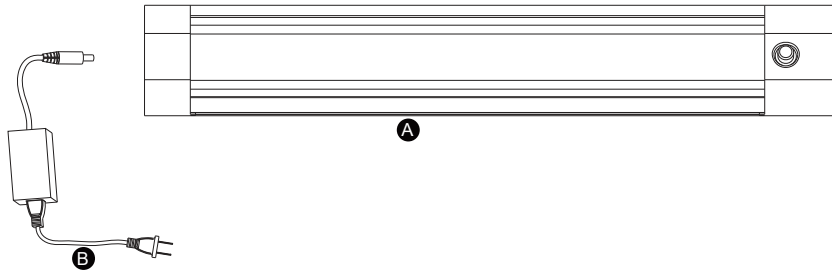

HARDWARE CONTENTS Note: Hardware not shown actual size.

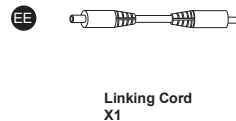
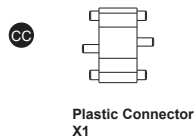
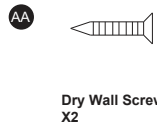

SAFETY INFORMATION

Please read and understand this entire manual before attempting to assemble, operate or install the product.

WARNING

- Turn off electricity at main fuse box (or circuit breaker box) before beginning installation by removing fuse (or switching off circuit breaker).
- Be careful not to damage or cut the wire insulation (covering) during fixture installation. Do not permit wires to contact any surface having a sharp edge. To do so may damage or cut the wire insulation, which could cause serious injury or death from electric shock.

CAUTION

- All electrical connections must be in agreement with local codes, ordinances or the national electric code (NEC). Contact your municipal building department to learn about your local codes, permits and/or inspections.
- Risk of fire – most dwellings built before 1985 have supply wire rated for 140°F/60°C. Consult a qualified electrician before installation.

PREPARATION

Before beginning assembly, installation or operation of product, make sure all parts are present. Compare parts with package contents list and diagram on previous page. If any part is missing or damaged, do not attempt to assemble, install or operate the product.

Tools Required for Assembly (not included): Screwdriver, Phillips Screwdriver, Safety Glasses, Ladder, Wire Stripper.

ASSEMBLY INSTRUCTIONS

Important to know

1. Read all instructions carefully before installation and operation.
2. If you are not familiar with state and local electrical codes, it is recommended that you consult with a qualified electrician.
3. Maximum number of LED cabinet lighting fixtures per run should not exceed power supply wattage rating. (Maximum 24W)
4. Do not use in wet locations, use indoors only.
5. Non-replaceable LEDs.
6. LED light output is strong enough to injure human eyes. Precautions must be taken to prevent looking directly at the LEDs with unaided eyes.
7. Specification:

NO.	Item #.	Dimension(inch)			Watts
		A	B	C	
1	X0118	30	1.25	0.4	10
2	X0117	20	1.25	0.4	7.5
3	X0116	12	1.25	0.4	4.5

A line drawing of the LED Undercabinet Light fixture with dimension lines. Dimension 'A' is the length of the fixture. Dimension 'B' is the height of the fixture. Dimension 'C' is the depth of the fixture.

Important safety instructions

1. Never use with an extension cord unless plug can be fully inserted.
2. Do not alter the plug.
3. Do not attempt to install fixture while plugged in.

Installation Steps

- Note:**
1. Find a suitable location to mount the fixture, the mounting surface should be a minimum of 1/2" thick and approximately 3" distance for linking cord should be allowed at both ends of fixtures.
 2. Carefully plan out your installation prior to actually securing your cabinet light fixture to the mounting surface. Make sure that your 11 ft. power adaptor will reach the nearest electrical outlet.

ASSEMBLY INSTRUCTIONS (continued)

- Place the mounting clips (BB) apart and mark with a pencil. Mounting clips (BB) should be in line with each other with respective distance depends on the length of the cabinet light.

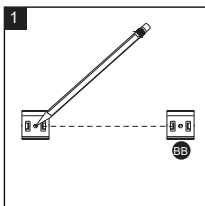

- Secure the mounting clips (BB) to the mounting surface with the dry wall screws (AA) provided.

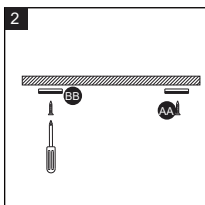

- Install the cabinet light fixture (A) into the mounting clips (BB):
 - Latch one side of the cabinet light fixture (A) into the two mounting clips (BB).
 - Latch the other side of the cabinet light fixture (A) until fully secured.

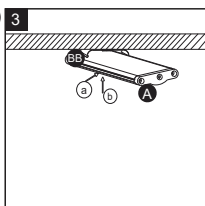

The cabinet light fixture (A) may be detached by using a small flathead screwdriver (not included) between hooks and prying outward on the cabinet light fixture (A).

Connecting fixture to fixture

The cabinet lighting fixture units can be connected by using plastic connector or by using linking cord (12 inches).

Note: Maximum number of cabinet light fixtures per run should not exceed power supply wattage rating. (Maximum 24W)

A. Using plastic connector:

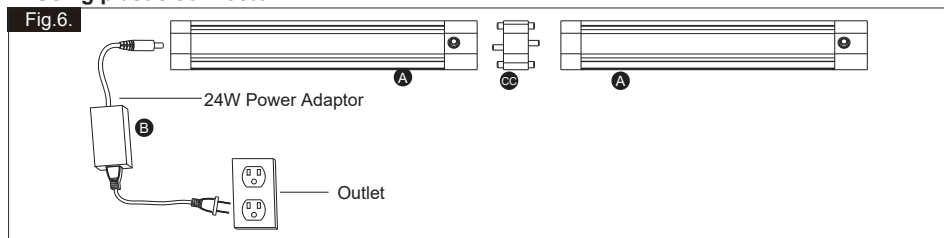

- Align plastic connector (CC) on one end of new fixture (A) with plastic connector (CC) on one end of existing fixture (A).
- Push new fixture (A) to existing fixture (A) until fixtures (A) are flush and connectors snap together by using plastic connector (CC). (See Figure. 6)

FUNCTION AND OPERATION (continued)

B. Using linking cord:

Fig. 7.

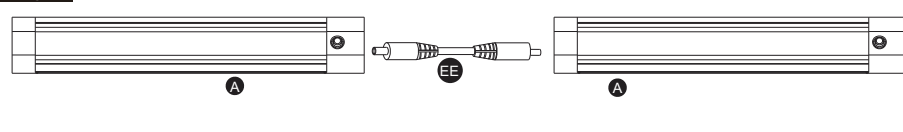

Install the additional cabinet light fixture (A) by following steps 1-5 of the instruction steps. Once installed, attach the linking cord (12 inches) (EE) between the cabinet light fixture (previously installed) and the new one. (See Fig. 7)

Note:

- This hardware package has a label (DD). Please paste the label (DD) on the cabinet, in order to remind the position of the On/Off switch.

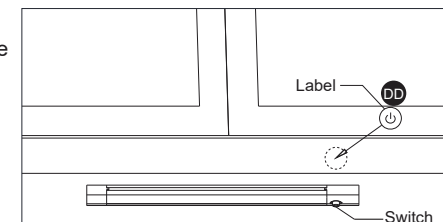

CARE AND MAINTENANCE

- Your fixture is made from quality materials that will last for many years with minimum care. When cleaning, make sure you have unplugged your fixture, and have allowed sufficient time for the fixture to cool to room temperature. You should clean the housing and lense using a damp soft cloth. You should plug your fixture back in only after the fixture has thoroughly dried.

TROUBLESHOOTING

If the light doesn't come on:

- Check if power supply is on.
- Check power adaptor.
- Test or replace switch.