

FLUSH FIXTURE INSTALLATION INSTRUCTIONS

Please read carefully and save these instructions, as you may need them a later date.

CAUTION

Turn off the main power at the circuit breaker before installing the fixture, in order to prevent possible shock.

GENERAL

All electrical connections must be in accordance with local and National Electrical Code (N.E.C) standards. If you are unfamiliar with proper electrical wiring connections obtain the services of a qualified electrician.

Remove the fixture and the mounting package from the box and make sure that no parts are missing by referencing the illustrations on the installation instructions.

ASSEMBLY AND INSTALLATION

1. Insert the clear glass sheets(17) into the outer metal frame (14), then press the metal clip(16) against the clear glass sheet, Please refer to View A and View B.
2. Drill two holes in the ceiling, press two geckos(21) into the holes, then secure the mounting bar with mounting screws(7) to the outlet box(1), also screw the wood screws(22) into the geckos(21).
3. Pull out the outlet wire and ground wire from the Outlet Box. Make wire connections:
 ---Ribbed wire(w/o marking) from light to White Wire(2) from power source.
 ---Smooth wire(w/ marking) from light to Black Wire(3) from power source.
 ---Loop the Ground Wire(4) to Mounting bar(6) with a Green Screw(9).
4. Attach the Canopy(11) against the Outlet box, secure with the Ball nuts(12).
5. Install bulbs:(bulbs not included)
 (Please don't exceed the maximum capacity that recommended on the Sockets)
6. Place the white glass(18) into Metal cage(15), then place the Metal cover(19), secure with CAP nuts(20)

INSTALLATION IS NOW COMPLETED.

FOR ITEM 2005F21-BN/2005F21-CH/2005F21-BRZ

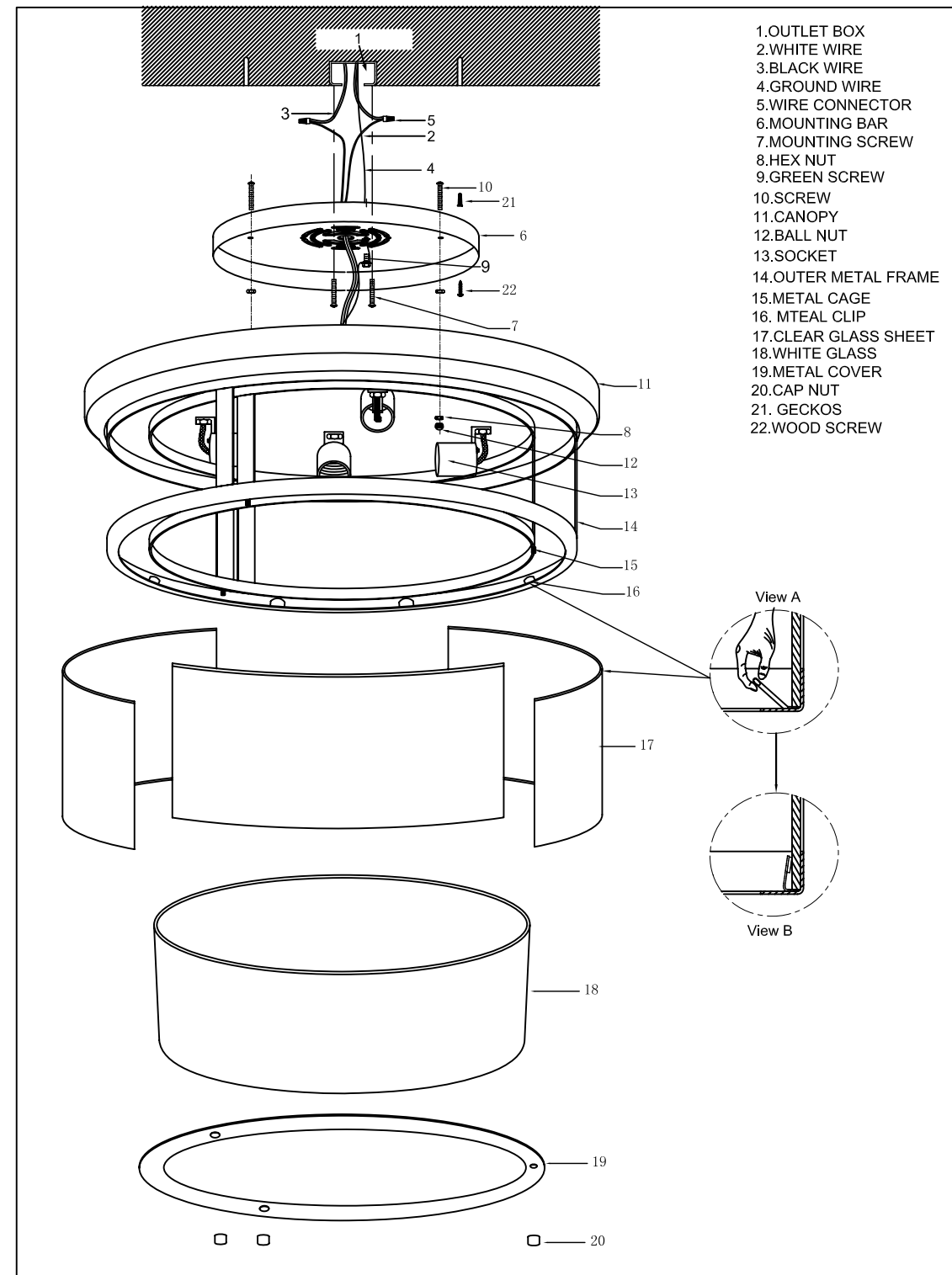

1. OUTLET BOX
2. WHITE WIRE
3. BLACK WIRE
4. GROUND WIRE
5. WIRE CONNECTOR
6. MOUNTING BAR
7. MOUNTING SCREW
8. HEX NUT
9. GREEN SCREW
10. SCREW
11. CANOPY
12. BALL NUT
13. SOCKET
14. OUTER METAL FRAME
15. METAL CAGE
16. METAL CLIP
17. CLEAR GLASS SHEET
18. WHITE GLASS
19. METAL COVER
20. CAP NUT
21. GECKOS
22. WOOD SCREW